

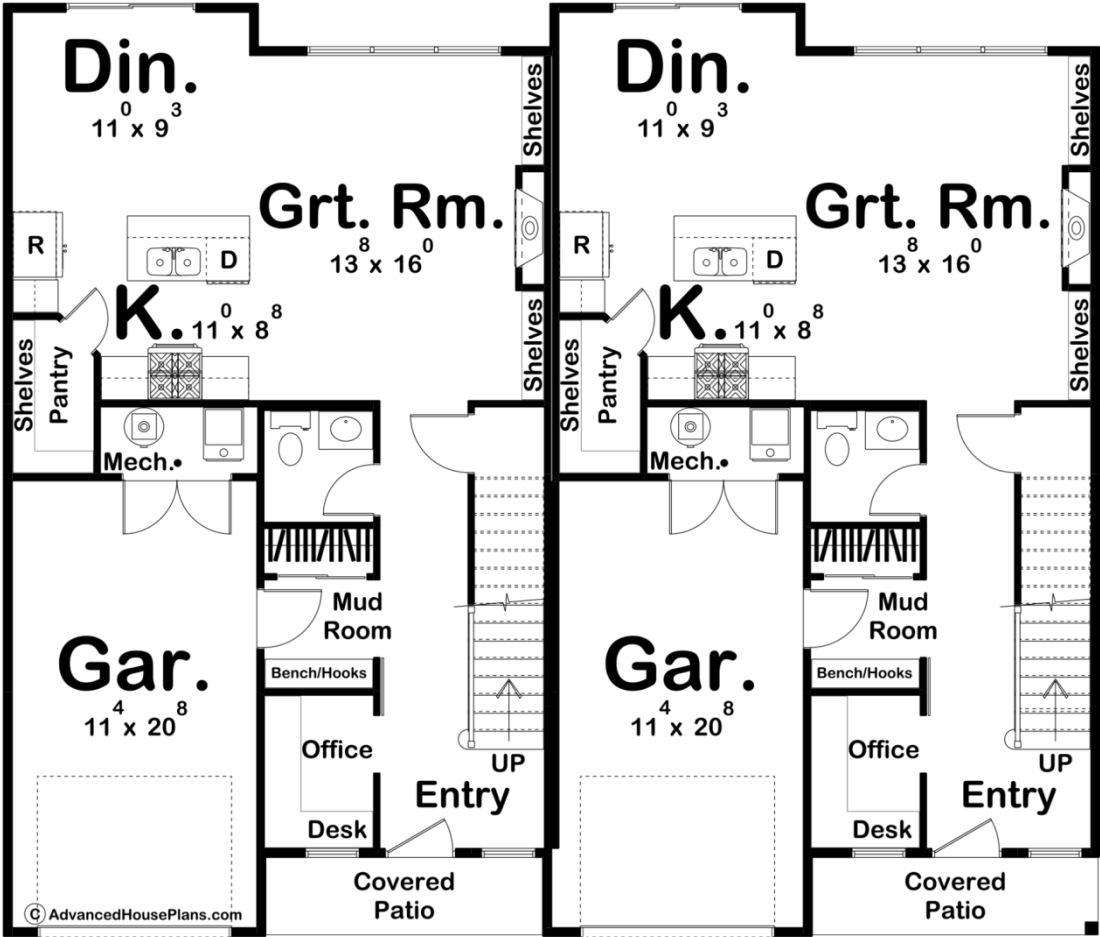

30314 - Wood Valley Data Sheet

| | | | | | |
|---------------|-----------|------------|-----------|----------------|----------------|
| 1711 SQ FT | 3 BEDS | 3 BATHS | 1 BAYS | 50' 8" WIDE | 43' 0" DEEP |
|---------------|-----------|------------|-----------|----------------|----------------|

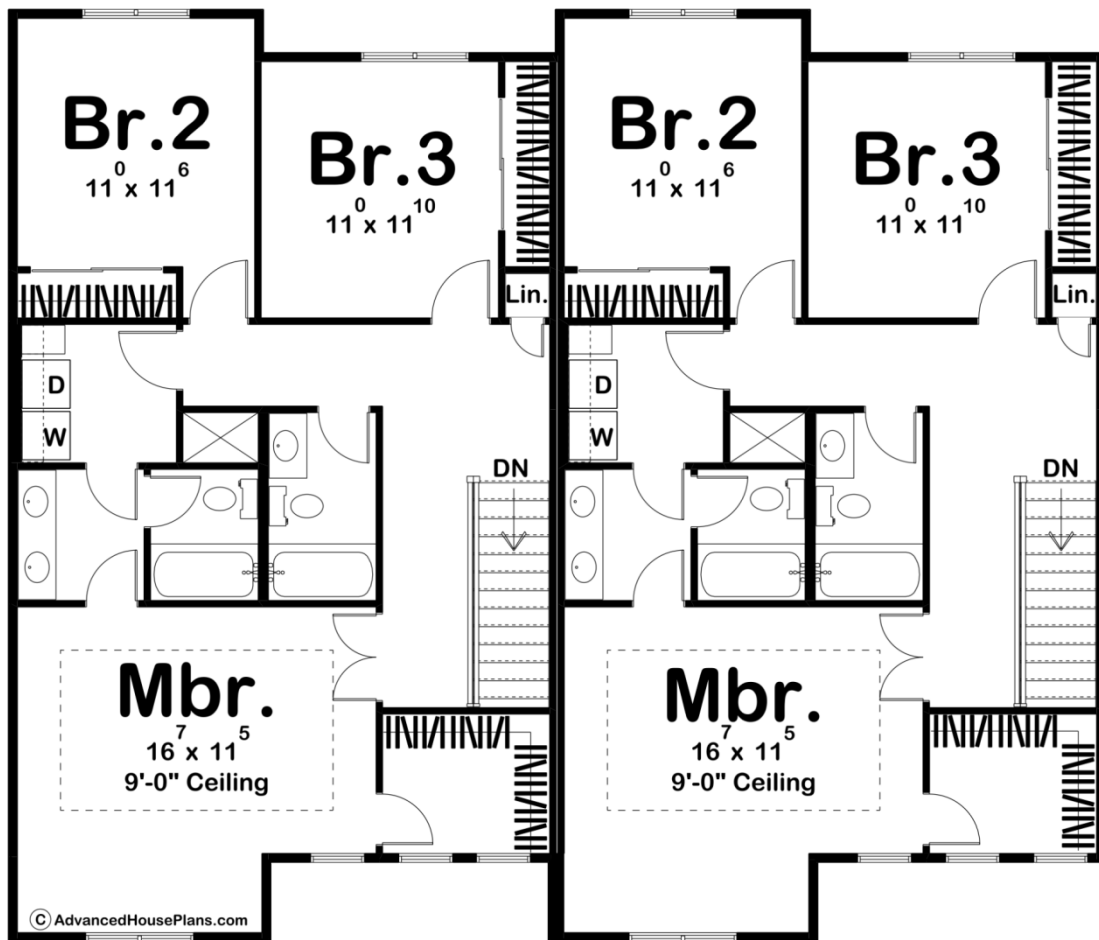



Construction Specs

Layout

| | |
|-------------|---|
| Bedrooms | 3 |
| Bathrooms | 3 |
| Garage Bays | 1 |

Square Footage

| | |
|---------------------|--------------|
| Main Level | 744 Sq. Ft. |
| Second Level | 967 Sq. Ft. |
| Covered Area | 49 Sq. Ft. |
| Garage | 247 Sq. Ft. |
| Total Finished Area | 1711 Sq. Ft. |

Exterior Dimensions

| | |
|-------|--------|
| Width | 50' 8" |
| Depth | 43' 0" |

Default Construction Stats

Stats are unique to the individual plan.

| | |
|----------------------------|-------------------------------|
| Foundation Type | Slab |
| Exterior Wall Construction | 2x4 |
| Roof Pitches | Primary 6/12, Secondary 10/12 |
| Main Wall Height | 9' |
| Second Wall Height | 8' |

Plan Description

Our Wood Valley plans is a duplex of our Fleetwood plan. It is a gorgeous modern farmhouse plan with 1711 square feet, 3 bedrooms, and 3 bathrooms. The exterior of this home with board and batten siding, wood accents, metal roofing, and dark windows gives this plan a traditional modern farmhouse feel with uniqueness still throughout. Walking in through the front door just under the covered patio walks you straight into a gorgeous entryway, met with a lovely staircase on the right or office space with a built-in desk on the left. A mudroom with access to the 1-car garage can also be found here, also including a built-in bench with hooks for coats and bags. Continuing throughout the house is when you will find a powder bath, just before stepping into a spacious open concept room, containing the great room with built-in shelving and a fireplace, a dining room, and a kitchen with a walk-in pantry and large kitchen island. Heading upstairs is where all of the bedrooms can be found. The master is complete with a 9' ceiling, walk-in closet, private Hollywood bath with a double vanity, and access to the laundry room. Bedrooms 2 and 3 can also be found here, which share a hallway bath.