

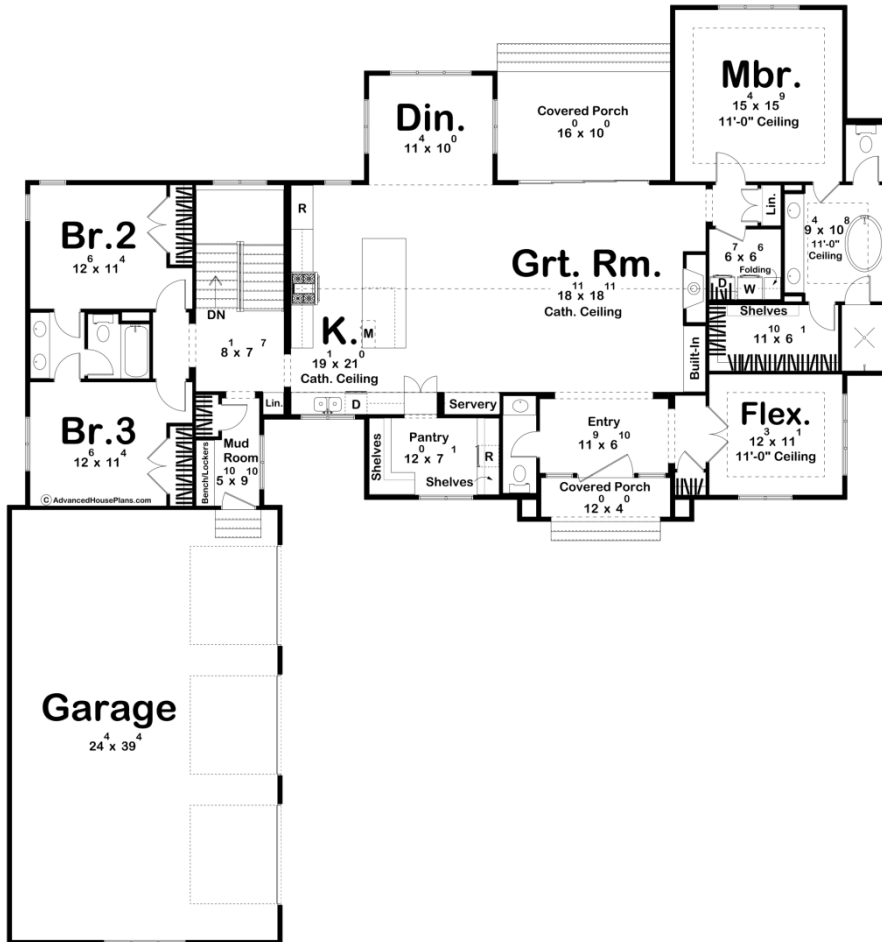

30602 - Willowbrook Data Sheet

2574 SQ FT	3 BEDS	3 BATHS	3 BAYS	80' 8" WIDE	85' 8" DEEP
---------------	-----------	------------	-----------	----------------	----------------



Construction Specs

Layout

Bedrooms

Bathrooms	3
Garage Bays	3

Square Footage

Main Level	2574 Sq. Ft.
Covered Area	204 Sq. Ft.
Garage	993 Sq. Ft.
Total Finished Area	2574 Sq. Ft.

Exterior Dimensions

Width	80' 8"
Depth	85' 8"
Ridge Height <i>Calculated from main floor line</i>	26' 10"

Default Construction Stats

Stats are unique to the individual plan.

Foundation Type	Basement
Exterior Wall Construction	2x4
Roof Pitches	Primary 10/12, Secondary 3/12, 1/12, Flat
Foundation Wall Height	9'
Main Wall Height	10'

Plan Description

This stunning single-story modern-style house exudes elegance with its dark exterior, combining board and batten siding, sleek stucco finishes, and a durable standing seam metal roof. The small covered entry welcomes you into an open-concept living space that seamlessly connects the great room, kitchen, and dining areas, perfect for entertaining and family gatherings. The kitchen features a large walk-in pantry, providing ample storage and functionality. A versatile flex room offers the ideal space for a home office, playroom, or exercise area, catering to your lifestyle needs. The home includes three bedrooms, thoughtfully designed for privacy and comfort. The master suite is a tranquil retreat, set apart from the other two bedrooms, and features a spacious walk-in closet and a luxurious en-suite bathroom. Outdoor living is enhanced with a rear covered porch, ideal for relaxing or entertaining in any weather. A side-load three-car garage adds curb appeal and practicality, providing plenty of space for vehicles and storage. This modern home combines style, comfort, and functionality in a single-level design.