

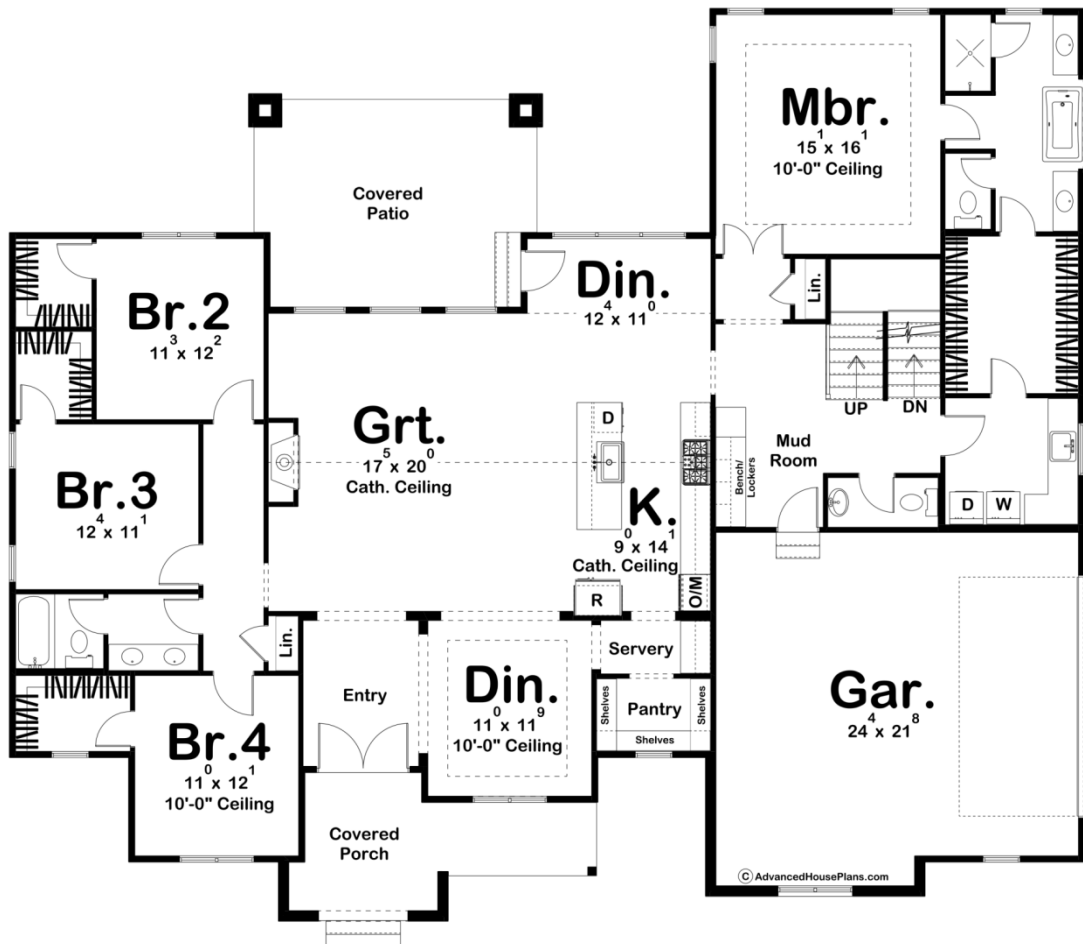

30225 - Williamsport Data Sheet

2569 SQ FT	4 BEDS	3 BATHS	2 BAYS	72' 8" WIDE	60' 8" DEEP
---------------	-----------	------------	-----------	----------------	----------------

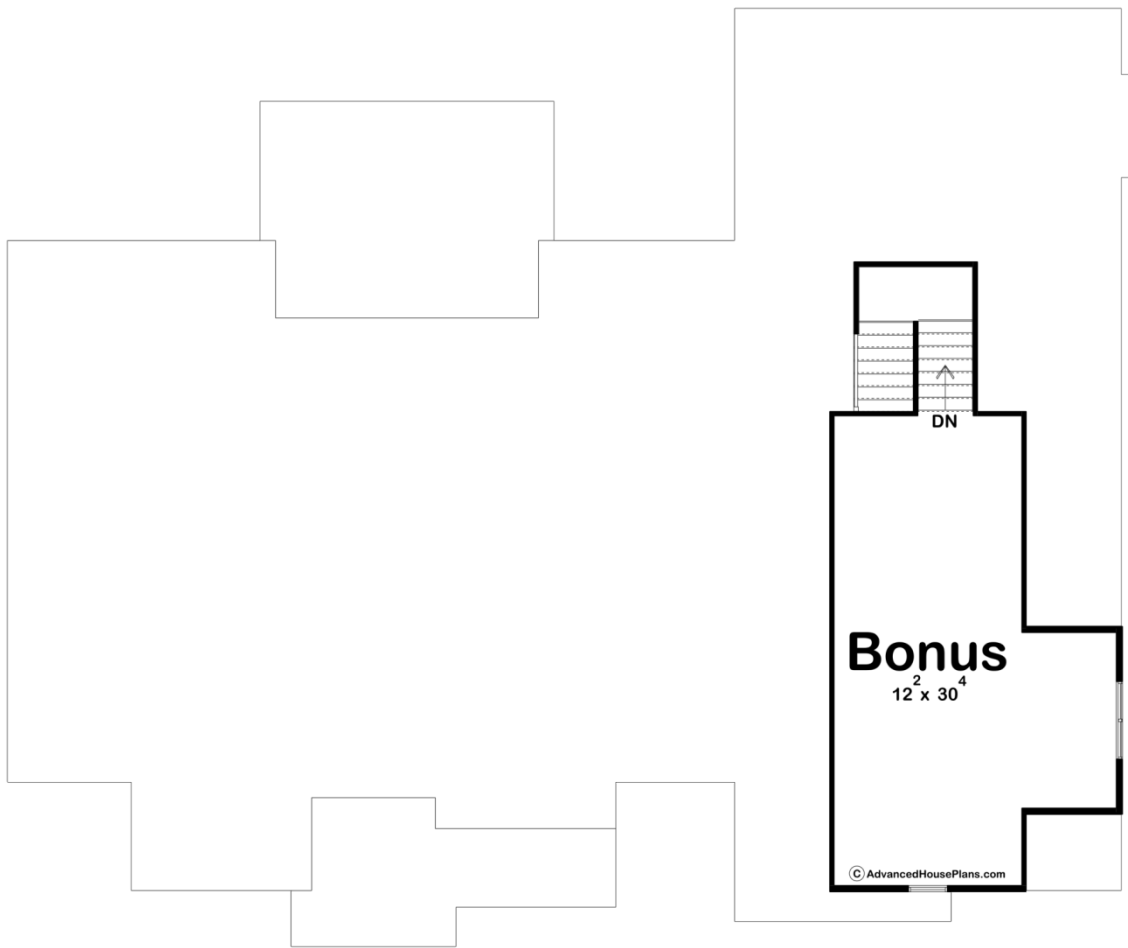



Construction Specs

Layout

Bedrooms	4
Bathrooms	3
Garage Bays	2

Square Footage

Main Level	2569 Sq. Ft.
Covered Area	400 Sq. Ft.
Garage	573 Sq. Ft.
Total Finished Area	2569 Sq. Ft.

Exterior Dimensions

Width	72' 8"
Depth	60' 8"

Default Construction Stats

Stats are unique to the individual plan.

Foundation Type	Basement
-----------------	----------

Exterior Wall Construction	2x4
Roof Pitches	Primary 8/12, Secondary 12/12, 5/12, 10/12
Foundation Wall Height	9'
Main Wall Height	9'

Plan Description

The Williamsport plan is a beautiful Modern Farmhouse Style House Plan with 2569 square feet, 4 bedrooms, and 3 bathrooms. The exterior of the plan is a gorgeous mix of brick, board and batten, as well as wood and dark accents. This home would be a stunning addition to any neighborhood and is perfect for many people. Entering the home upon the covered porch welcomes you into a gorgeous entryway that connects right to a dining room, or opens to the great room. Head straight in to see the open-concept space including the dinette, kitchen, dining and great room. The kitchen has a connecting servery and walk-in pantry, to provide a sense of ease going from kitchen to dining room. The dinette has access to a covered rear patio, perfect for entertaining. The right side of the home is where the master bedroom can be found, complete with a spacious bathroom with double vanities, a separate shower, toilet, and soaking tub. The walk-in closet is large and has connection to the laundry room as well as loops back out into the mudroom. A powder bath, stairs, and access to the two-car garage can be found here. The right side of the home is where the additional bedrooms can be found, each with their own walk-in closet and a shared Hollywood bathroom. Upstairs is where an additional bonus room can be found that adds an extra 467 square feet, perfect for another bedroom, hangout spot, or storage.