

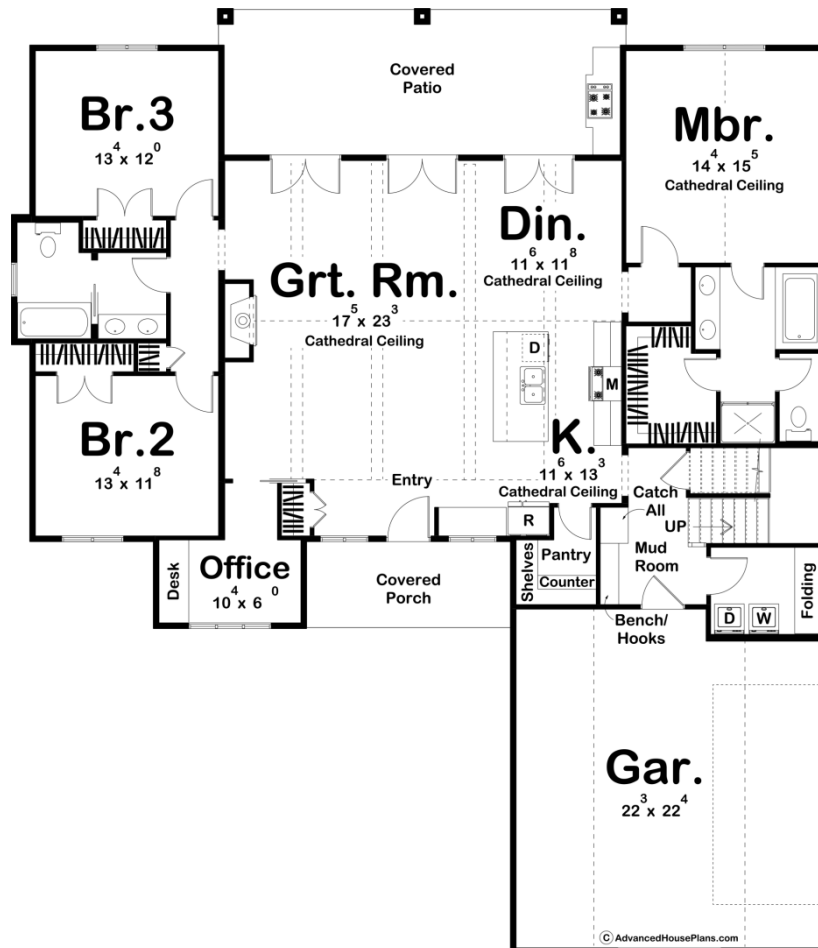

**29878 - Weidenfeld Data Sheet**

|               |           |            |           |                |                |
|---------------|-----------|------------|-----------|----------------|----------------|
| 2075<br>SQ FT | 3<br>BEDS | 2<br>BATHS | 2<br>BAYS | 60' 0"<br>WIDE | 69' 0"<br>DEEP |
|---------------|-----------|------------|-----------|----------------|----------------|

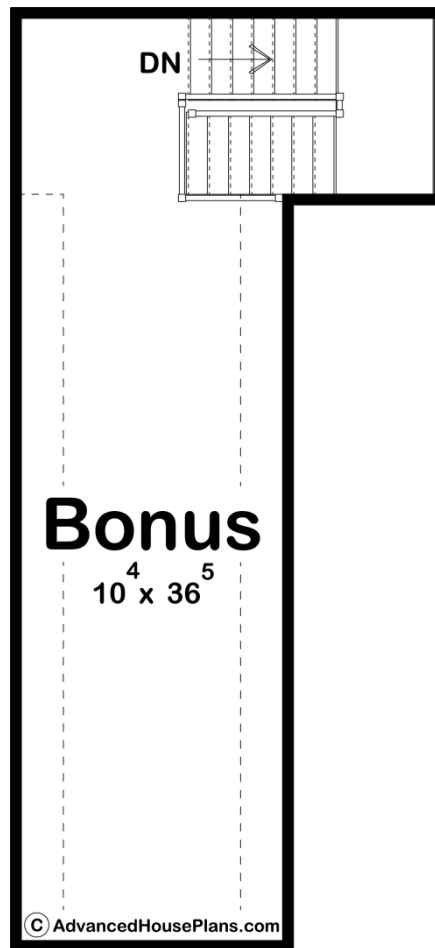



## Construction Specs

### Layout

|             |   |
|-------------|---|
| Bedrooms    | 3 |
| Bathrooms   | 2 |
| Garage Bays | 2 |

### Square Footage

|                     |              |
|---------------------|--------------|
| Main Level          | 2075 Sq. Ft. |
| Garage              | 560 Sq. Ft.  |
| Total Finished Area | 2075 Sq. Ft. |

### Exterior Dimensions

|       |        |
|-------|--------|
| Width | 60' 0" |
| Depth | 69' 0" |

### Default Construction Stats

*Stats are unique to the individual plan.*

|                            |      |
|----------------------------|------|
| Foundation Type            | Slab |
| Exterior Wall Construction | 2x4  |

|                    |                                     |
|--------------------|-------------------------------------|
| Roof Pitches       | 10/12 Primary, 12/12 4/12 Secondary |
| Main Wall Height   | 9'                                  |
| Second Wall Height | 8'                                  |

## Plan Description

The Weidenfeld plan merges the classic farmhouse style with modern elements to create the Modern Farmhouse style. On the inside, you'll walk into the great room that is warmed by a fireplace. The great room, kitchen, and dining room lie under a soaring cathedral ceiling with exposed beams. The great room opens up to the covered patio through 3 sets of french doors. The home's kitchen includes a large island and a walk-in pantry. The master includes a soaking tub, his/her vanities, an enclosed toilet area, and a walk-in closet. On the opposite side of the home, 2 bedrooms share a centrally located hall bathroom. A bonus area above the garage adds 384 sq ft.