

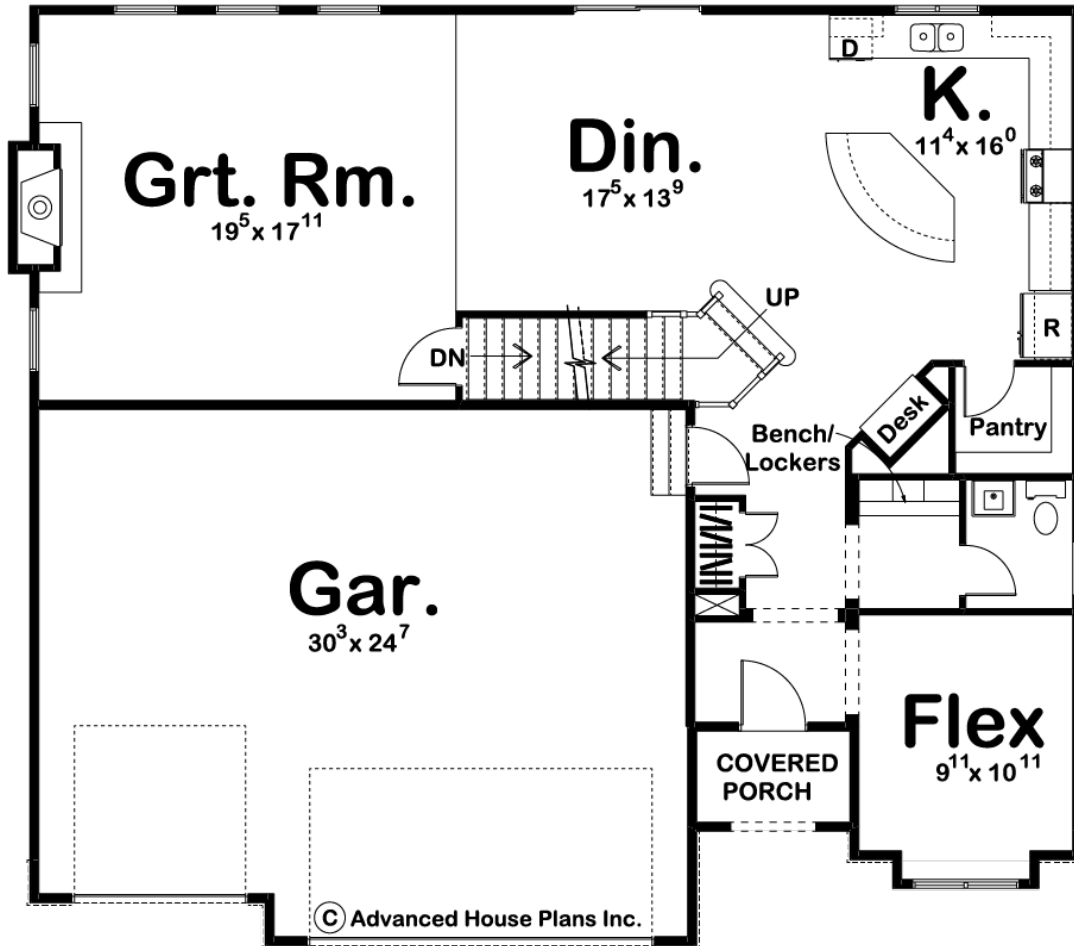

**29302 - Wallingford Data Sheet**

2867 SQ FT	4 BEDS	3 BATHS	3 BAYS	50' 0" WIDE	44' 0" DEEP
---------------	-----------	------------	-----------	----------------	----------------

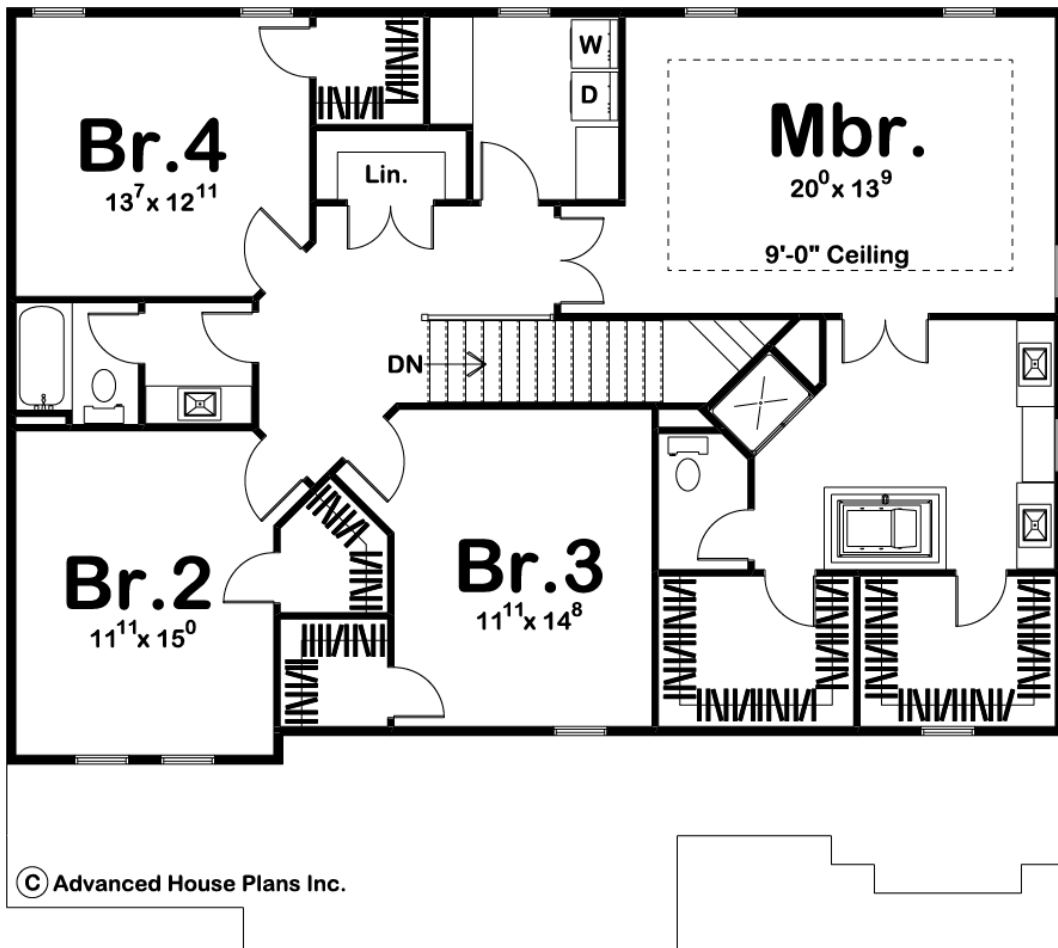



## Construction Specs

### Layout

Bedrooms	4
Bathrooms	3
Garage Bays	3

### Square Footage

Main Level	1255 Sq. Ft.
Second Level	1612 Sq. Ft.
Garage	750 Sq. Ft.
Total Finished Area	2867 Sq. Ft.

### Exterior Dimensions

Width	50' 0"
Depth	44' 0"
Ridge Height	30'
<i>Calculated from main floor line</i>	

## Default Construction Stats

*Stats are unique to the individual plan.*

Foundation Type	Basement
Exterior Wall Construction	2x4
Roof Pitches	6/12
Foundation Wall Height	9'
Main Wall Height	9'
Second Wall Height	8'

## Plan Description

29302 Wallingford Shallow rooflines, wood corbels and stone detailing are artfully arranged to define the Tuscan style of this 2,867 sq. ft., 2-story house plan. Just inside from the covered porch, a flex room -- with unlimited possibilities -- lies adjacent to the entry hall. A few steps farther reveals a coat closet and practical drop zone area with bench, lockers and access to a powder bath. The home's 3-car garage is accessed at the edge of the kitchen -- much appreciated by those carrying in bags of groceries. The kitchen features an arched island breakfast bar, corner walk-in pantry and built in desk. The dining area, which is open to the kitchen, flows unencumbered into the great room with its fireplace and sunny windows. Upstairs, the master suite features a bath with his-and-her vanities, compartmented toilet, shower and soaking tub that is flanked by the entrances of matching walk-in closets. Bedrooms 2, 3 and 4 each have walk-in closets and share a hall bath. A laundry room and sizeable linen closet are convenient to all bedrooms.