

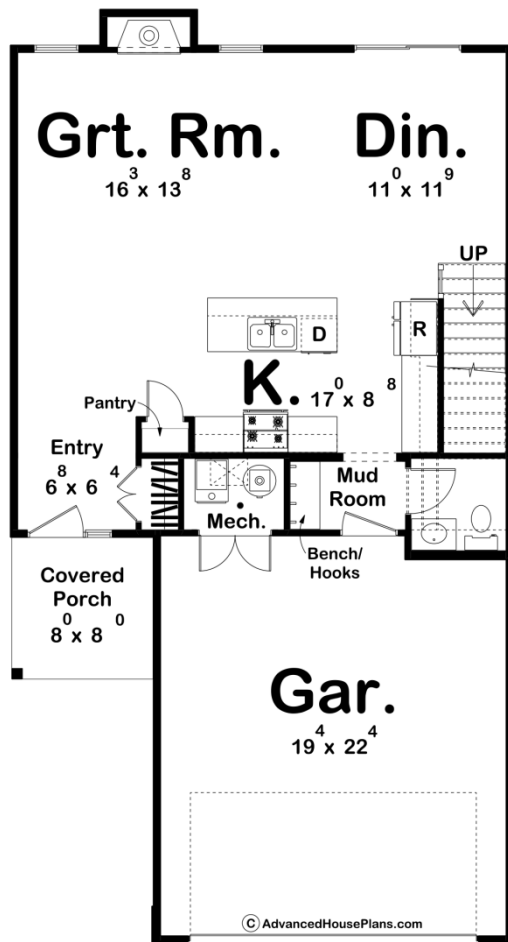

**30315 - Urbana Data Sheet**

1593 SQ FT	3 BEDS	3 BATHS	2 BAYS	28' 0" WIDE	52' 0" DEEP
---------------	-----------	------------	-----------	----------------	----------------

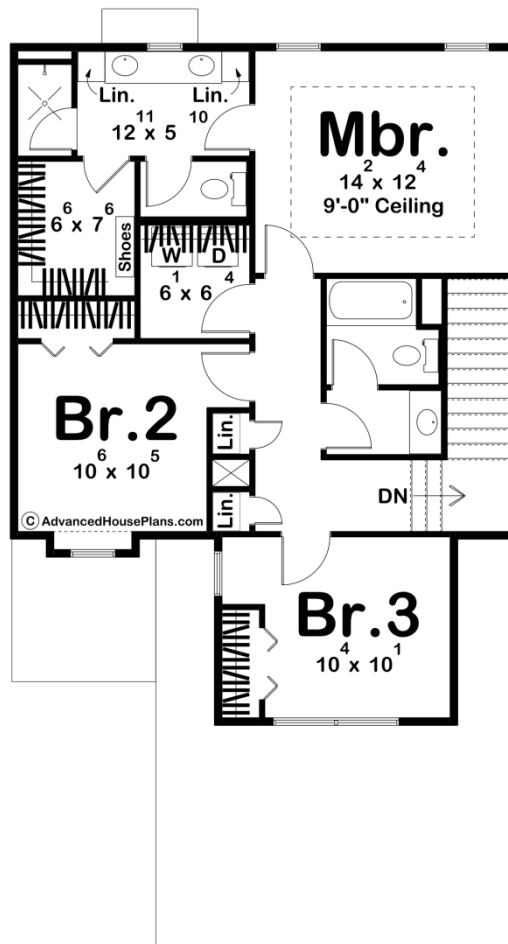



## Construction Specs

### Layout

Bedrooms	3
Bathrooms	3
Garage Bays	2

### Square Footage

Main Level	751 Sq. Ft.
Second Level	842 Sq. Ft.
Garage	445 Sq. Ft.
Total Finished Area	1593 Sq. Ft.

### Exterior Dimensions

Width	28' 0"
Depth	52' 0"
Ridge Height	23' 8"
<i>Calculated from main floor line</i>	

## Default Construction Stats

*Stats are unique to the individual plan.*

Foundation Type	Slab
Exterior Wall Construction	2x4
Roof Pitches	Primary 4/12, Secondary 6/12
Main Wall Height	9'
Second Wall Height	8'

## Plan Description

Welcome to this contemporary two-story home that seamlessly blends modern aesthetics with functional design. Situated on a well-manicured lot, this residence boasts a striking exterior featuring clean lines and a sleek façade. The front of the house is adorned with a spacious two-car front load garage, providing both convenience and a seamless integration with the overall design. A covered porch welcomes you to the entrance, offering a sheltered space to greet guests or enjoy the outdoors. Upon entering the home, you are greeted by an open-concept living space that combines the living, dining, and kitchen areas. The kitchen is equipped with state-of-the-art appliances, sleek cabinetry, and a central island, making it both a functional workspace and a stylish focal point. Ascending the staircase to the second floor, you'll find three bedrooms, each designed with comfort and style in mind. The master suite is a luxurious retreat, complete with an ensuite bathroom and ample closet space. The remaining bedrooms share a well-appointed bathroom, featuring modern fixtures and finishes. Throughout the home, high-quality materials, such as hardwood floors and contemporary tiles, contribute to the overall modern aesthetic.