

ADVANCED
HOUSE PLANS

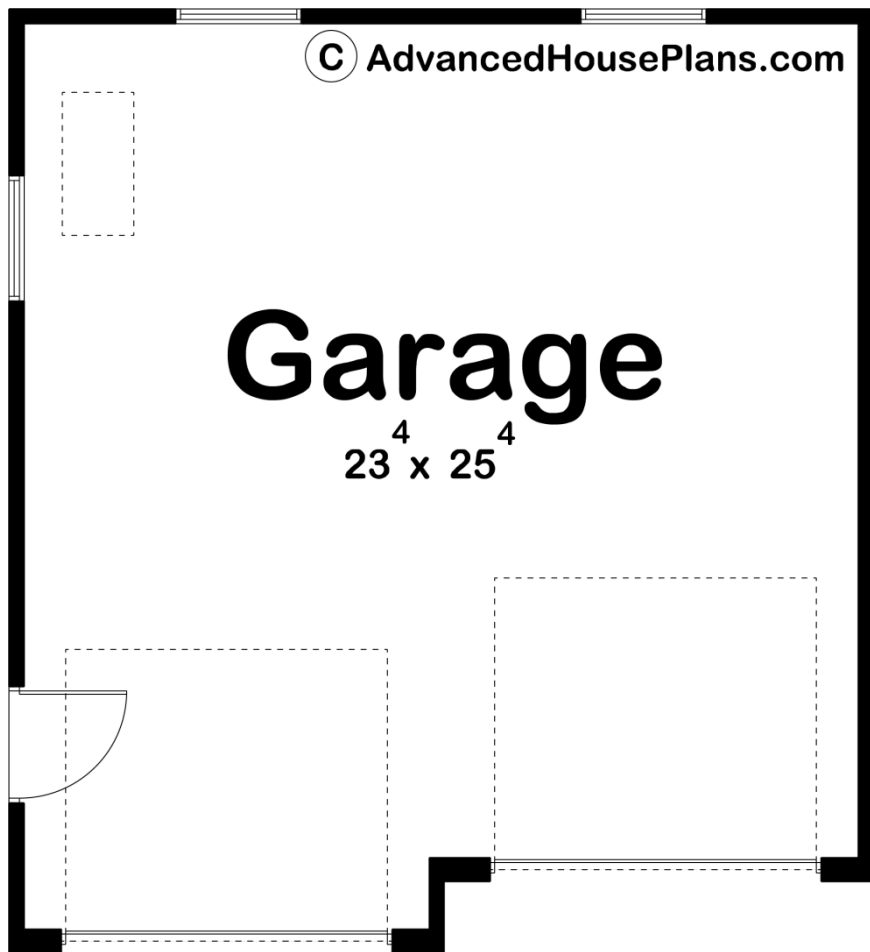

29167 - Turner Data Sheet

0 SQ FT	0 BEDS	0 BATHS	2 BAYS	26' 0" WIDE	24' 0" DEEP
------------	-----------	------------	-----------	----------------	----------------



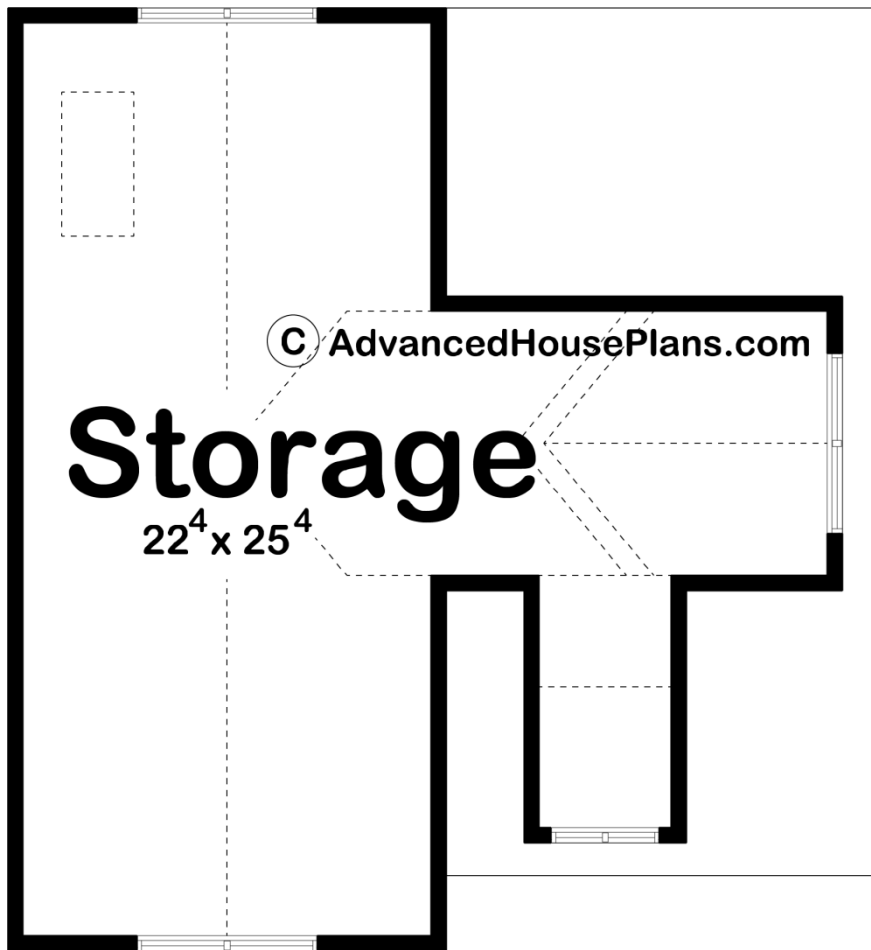

Construction Specs

Layout

Garage Bays 2

Square Footage

Garage 600 Sq. Ft.

Exterior Dimensions

Width 26' 0"

Depth 24' 0"

Default Construction Stats

Stats are unique to the individual plan.

Foundation Type Slab

Exterior Wall Construction 2x4

Roof Pitches 10/12 Primary

Main Wall Height 9'

Plan Description

The Turner is a single story traditional garage on slab foundation with a side entrance. Includes pull-down steps to attic storage above. The garage doors are 9'x8'.