

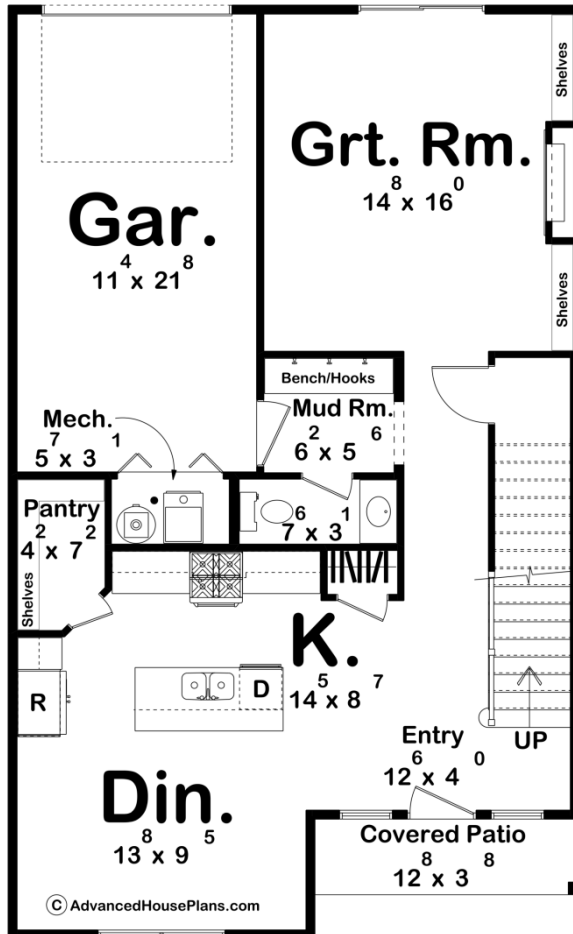

30611 - Trailwood Data Sheet

1916 SQ FT	3 BEDS	3 BATHS	1 BAYS	27' 0" WIDE	44' 0" DEEP
---------------	-----------	------------	-----------	----------------	----------------

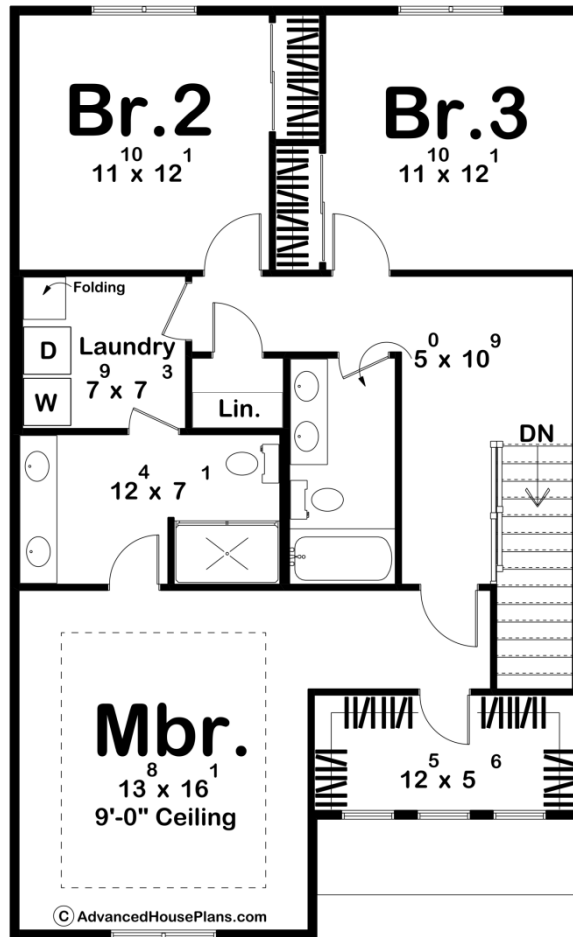



Construction Specs

Layout

Bedrooms	3
Bathrooms	3
Garage Bays	1

Square Footage

Main Level	841 Sq. Ft.
Second Level	1075 Sq. Ft.
Covered Area	46 Sq. Ft.
Garage	257 Sq. Ft.
Total Finished Area	1916 Sq. Ft.

Exterior Dimensions

Width	27' 0"
Depth	44' 0"
Ridge Height	28' 11"
<i>Calculated from main floor line</i>	

Default Construction Stats

Stats are unique to the individual plan.

Foundation Type	Slab
Exterior Wall Construction	2x4
Roof Pitches	Primary 6/12, Secondary 8/12
Main Wall Height	9'
Second Wall Height	8'

Plan Description

Welcome to the Trailwood, a beautiful 3-bedroom, 3-bath traditional-style home. On the main floor, you'll find a mudroom attached to the garage, complete with a bench and hooks for easy storage. The great room features an electric fireplace, creating a cozy gathering space. The kitchen includes a walk-in pantry, offering plenty of storage for all your essentials. A small covered patio at the front of the home adds a charming touch. Upstairs, the master bedroom offers a spacious walk-in closet for your wardrobe needs. The laundry room, conveniently located on this floor, comes with counter space for folding.