

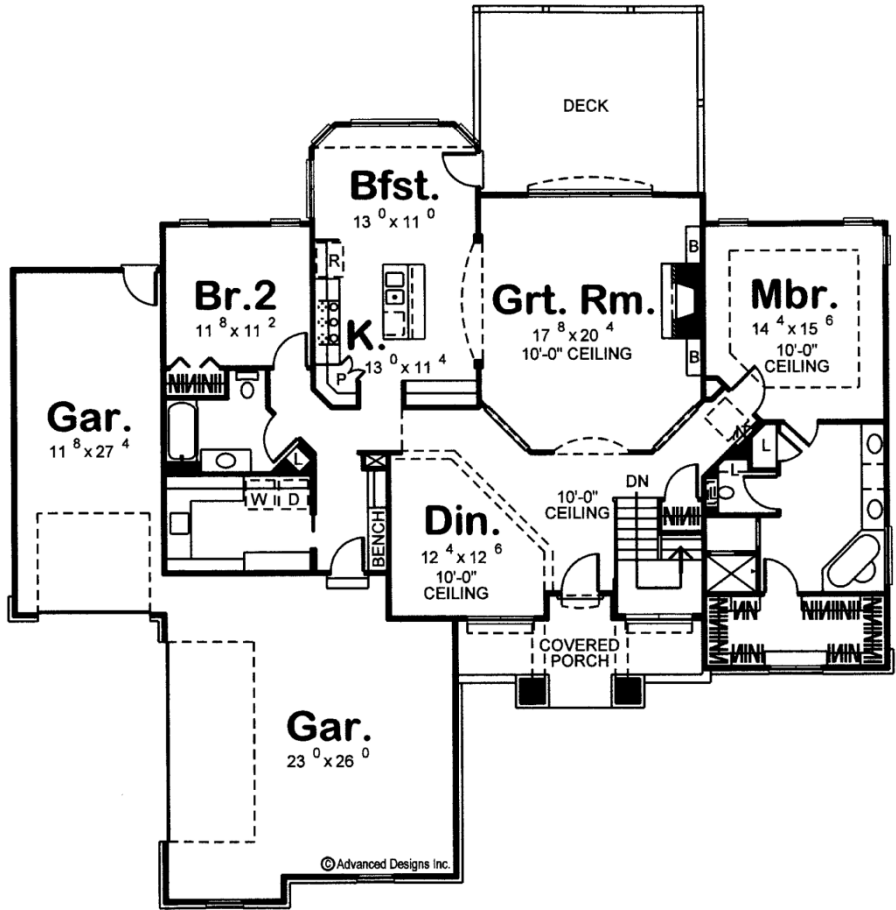

**29126 - Tillman Data Sheet**

1998 SQ FT	2 BEDS	2 BATHS	3 BAYS	71' 0" WIDE	63' 0" DEEP
---------------	-----------	------------	-----------	----------------	----------------



**Construction Specs**

**Layout**

Bedrooms

Bathrooms	2
Garage Bays	3

### Square Footage

Main Level	1998 Sq. Ft.
Garage	832 Sq. Ft.
Total Finished Area	1998 Sq. Ft.

### Exterior Dimensions

Width	71' 0"
Depth	63' 0"
Ridge Height <i>Calculated from main floor line</i>	23'

### Default Construction Stats

*Stats are unique to the individual plan.*

Foundation Type	Basement
Exterior Wall Construction	2x4
Roof Pitches	7/12 F-B, 9/12 S-S
Foundation Wall Height	9'
Main Wall Height	9'

## Plan Description

Tasteful, traditional styling lends an air of stability to this attractive 1,998 sq. ft., 1-story house plan. Stout columns greet guests at the covered front porch, where the entrance reveals expansive views inside. Just off the entry area, angled ceiling details define the boundaries of the open formal dining room and great room. The great room's ample entertaining space is enhanced by a fireplace, built-in bookcases and views to the rear deck. A wide arched opening beckons passage into the kitchen and breakfast area. The kitchen boasts an island work station, walk-in pantry and plenty of counter space. The sunny breakfast area accesses the rear deck for outdoor dining options. Just off the kitchen, a utility area includes a large laundry room with sink and counter space and a mud area with built-in bench. This area accesses the home's 2-car, side-load garage, and 1-car, front-load garage. Also off the kitchen is a secondary bedroom with nearby hall bath. On the opposite side of the home, the master suite resides in privacy. The master bath area includes his-and-her vanities, soaking tub, shower, compartmented toilet and a sizeable walk-in closet, brightened by a window to the front.