

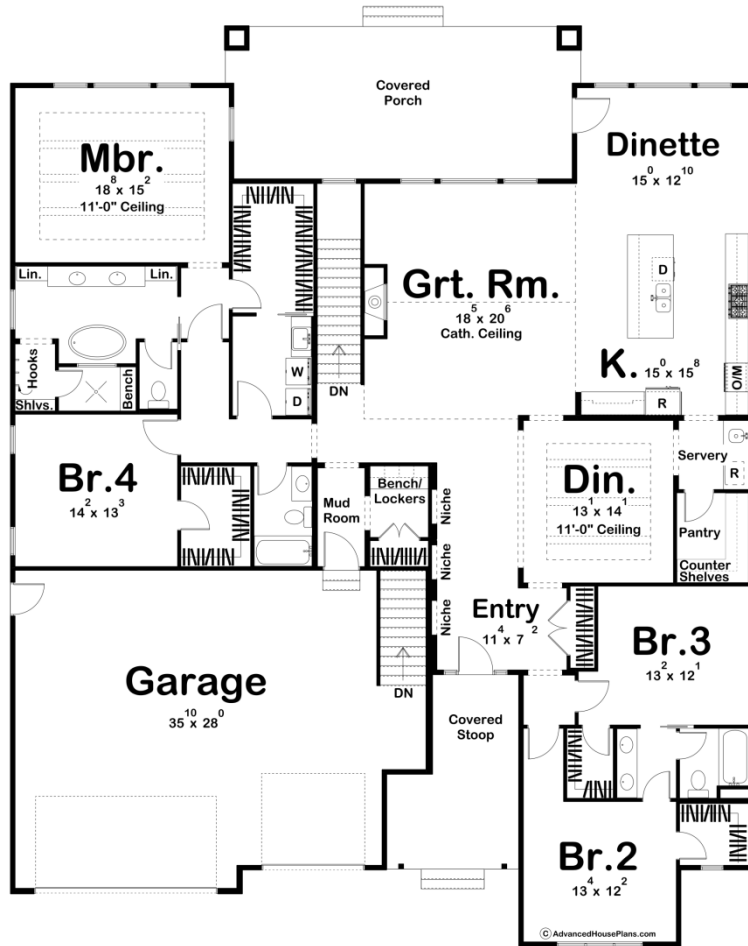

29912 - Thatcher Data Sheet

3168 SQ FT	4 BEDS	3 BATHS	3 BAYS	64' 8" WIDE	80' 0" DEEP
---------------	-----------	------------	-----------	----------------	----------------



Construction Specs

Layout

Bedrooms

Bathrooms 3

Garage Bays 3

Square Footage

Main Level 3168 Sq. Ft.

Covered Area 558 Sq. Ft.

Garage 958 Sq. Ft.

Total Finished Area 3168 Sq. Ft.

Exterior Dimensions

Width 64' 8"

Depth 80' 0"

Ridge Height 26' 0"

Calculated from main floor line

Default Construction Stats

Stats are unique to the individual plan.

Foundation Type Basement

Exterior Wall Construction 2x6

Roof Pitches 8/12 Primary, 12/12 3/12 Secondary

Foundation Wall Height 9'

Main Wall Height 10'

Plan Description

The Thatcher plan is a beautiful Modern Farmhouse style ranch plan. The exterior combines board and batten siding and lap siding paired with a metal roof. Just inside the front covered porch, you'll find yourself in a beautiful entry that features built-in niches. An amazing formal dining room lies under an 11' trayed ceiling with beams and has access to the kitchen through a servery. The kitchen includes a large walk-in pantry, ample counter space, and a massive island with a snack ledge. The great room flows perfectly with the kitchen and dinette in an open layout. The great room lies under a soaring cathedral ceiling and is warmed by a fireplace. The dinette leads out to a rear covered porch that is a perfect way to expand your home's outdoor entertainment options. The master suite is situated on the left side of the home. The master bedroom lies under an 11' trayed ceiling. The master bathroom includes an amazing soaking tub, his/her vanities, dual linen closets, and a walk-in shower. The master walk-in closet has access to the laundry room through a pocket door. The home's 3 guest bedrooms all have access to their own walk-in closet. Bedrooms 2 and 3 share a Jack and Jill bathroom. The home's 3 car garage accesses the home through a convenient mudroom that includes a bench and lockers.