

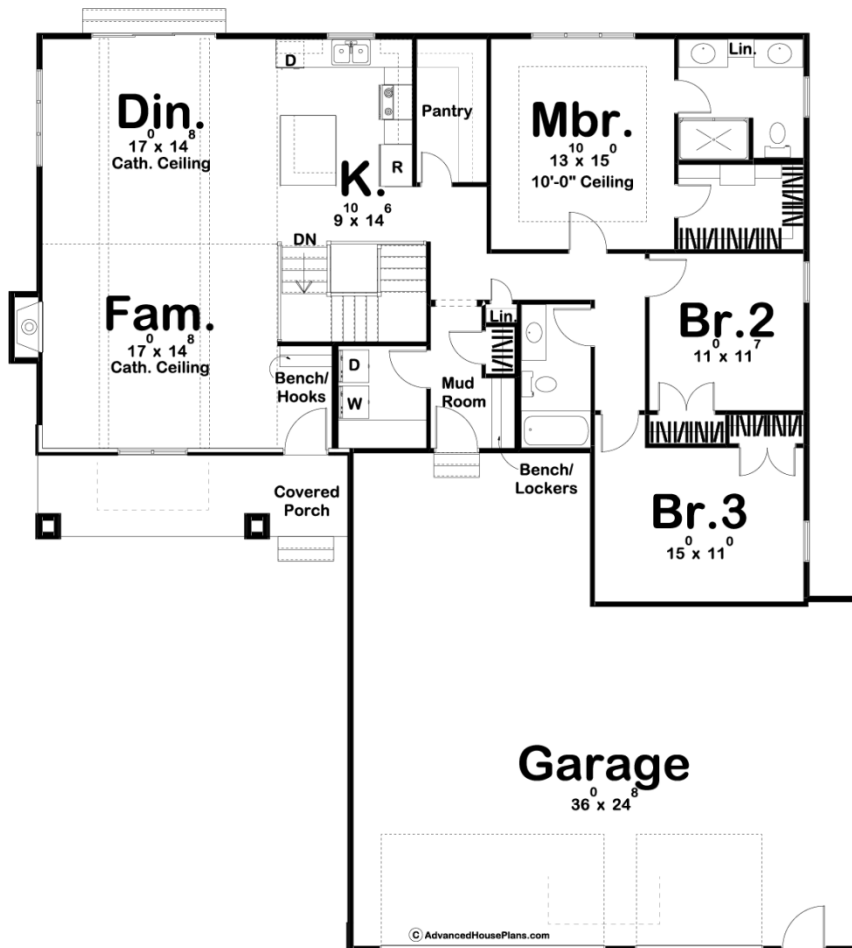

**29738 - Stockport Data Sheet**

1820 SQ FT	3 BEDS	2 BATHS	3 BAYS	61' 0" WIDE	66' 0" DEEP
---------------	-----------	------------	-----------	----------------	----------------



**Construction Specs**

Layout

Bedrooms

Bathrooms	2
-----------	---

Garage Bays	3
-------------	---

### Square Footage

Main Level	1820 Sq. Ft.
------------	--------------

Garage	1098 Sq. Ft.
--------	--------------

Total Finished Area	1820 Sq. Ft.
---------------------	--------------

### Exterior Dimensions

Width	61' 0"
-------	--------

Depth	66' 0"
-------	--------

### Default Construction Stats

*Stats are unique to the individual plan.*

Foundation Type	Basement
-----------------	----------

Exterior Wall Construction	2x4
----------------------------	-----

Roof Pitches	8/12 Primary, 6/12 Secondary
--------------	------------------------------

Foundation Wall Height	9'
------------------------	----

Main Wall Height	9'
------------------	----

## Plan Description

A tasteful array of exterior textures complements the smart interior design of this rustic, craftsman-style house plan. A covered front porch leads guests inside, where you will notice the large open living area under a soaring vaulted ceiling with exposed wood beams. The first room you will enter is the family room which is warmed by a fireplace. The dining room flows perfectly into the kitchen with its large island and walk-in pantry. The dining room leads to the back yard through a sliding rear glass door. The bedrooms are separated nicely from the living area for maximum privacy. The master bedroom lies under a beautiful tray ceiling and includes his/her vanities and a walk-in closet. Bedrooms 2 and 3 share a conveniently located hall bathroom. The home's oversized 3-car garage is accessed through a utility area which includes a laundry room and a mudroom, complete with bench, lockers and a handy catch-all area.