

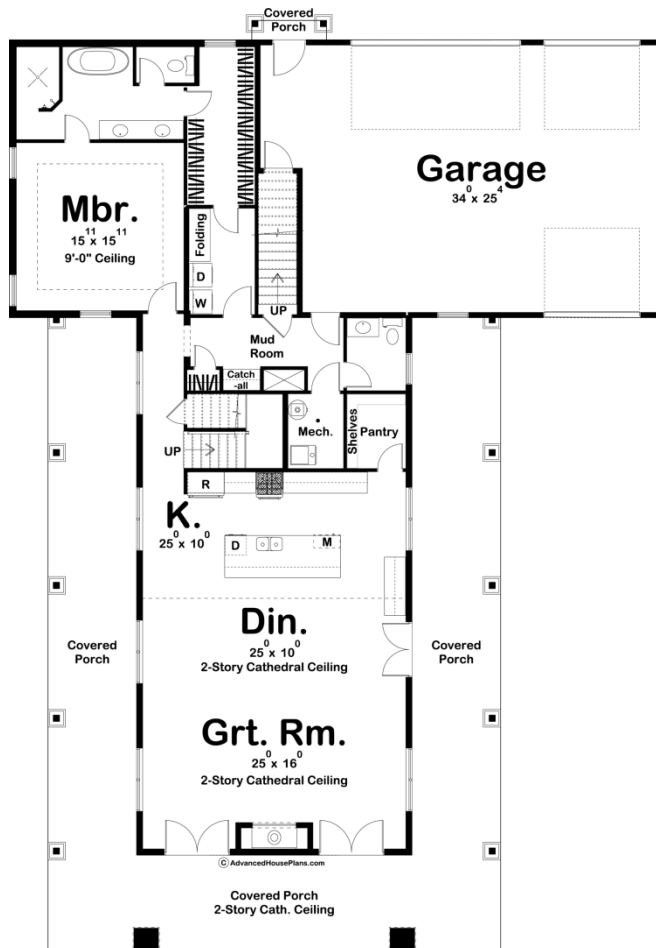

30086 - Stillwater Data Sheet

| | | | | | |
|---------------|-----------|------------|-----------|----------------|----------------|
| 3205 SQ FT | 4 BEDS | 4 BATHS | 3 BAYS | 62' 0" WIDE | 86' 0" DEEP |
|---------------|-----------|------------|-----------|----------------|----------------|

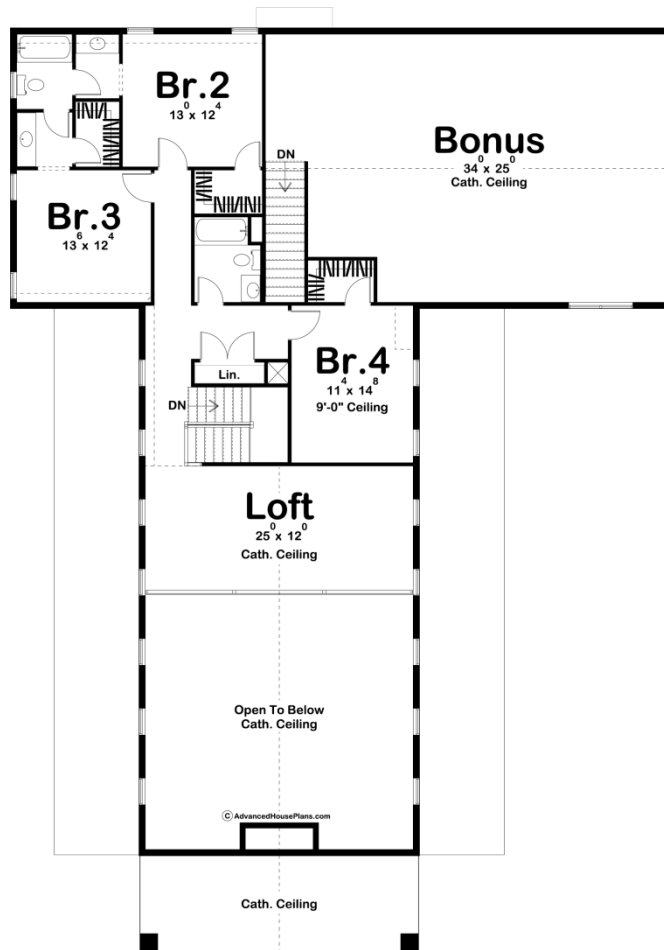



Construction Specs

Layout

| | |
|-------------|---|
| Bedrooms | 4 |
| Bathrooms | 4 |
| Garage Bays | 3 |

Square Footage

| | |
|---------------------|--------------|
| Main Level | 1943 Sq. Ft. |
| Second Level | 1262 Sq. Ft. |
| Covered Area | 1064 Sq. Ft. |
| Garage | 995 Sq. Ft. |
| Total Finished Area | 3205 Sq. Ft. |

Exterior Dimensions

| | |
|--|--------|
| Width | 62' 0" |
| Depth | 86' 0" |
| Ridge Height | 32' |
| <i>Calculated from main floor line</i> | |

Default Construction Stats

Stats are unique to the individual plan.

| | |
|----------------------------|-------------------------------|
| Foundation Type | Slab |
| Exterior Wall Construction | 2x6 |
| Roof Pitches | 12/12 Primary, 4/12 Secondary |
| Main Wall Height | 9' |
| Second Wall Height | 8' |

Plan Description

The Stillwater plan is a wonderful Modern Farmhouse Barndominium. The exterior embraces the Modern Farmhouse aesthetic by incorporating board and batten siding, wood beams, a metal roof, and wood garage doors. A massive wrap around covered front porch creates an inviting warmth for guests. Just inside the front door, you'll find yourself in a massive open layout. The great room lies under a soaring 2 story cathedral ceiling and features a fireplace that is flanked by French doors leading out to the covered porch. The kitchen includes a massive island with a snack bar and a large walk-in pantry. The master suite is located on the main floor and is tucked in the rear of the home for ultimate privacy. The master bedroom lies under a decorative trayed ceiling. The master bathroom features a soaking tub, his and her vanities, and a large walk-in closet that has access to the laundry room. Upstairs, there are 3 additional bedrooms. Bedrooms 2 and 3 share access to a Hollywood-style bathroom. Bedroom 4 shares a centrally located hall bathroom with the upstairs loft. The loft overlooks the main living area. You'll also find a large optional bonus area on the second floor that adds 970 sq ft to the home. Back on the main level, the home's rear load 3 car garage includes a drive-through bay. The garage accesses the home through a convenient mud room with a catch all and coat closet.