

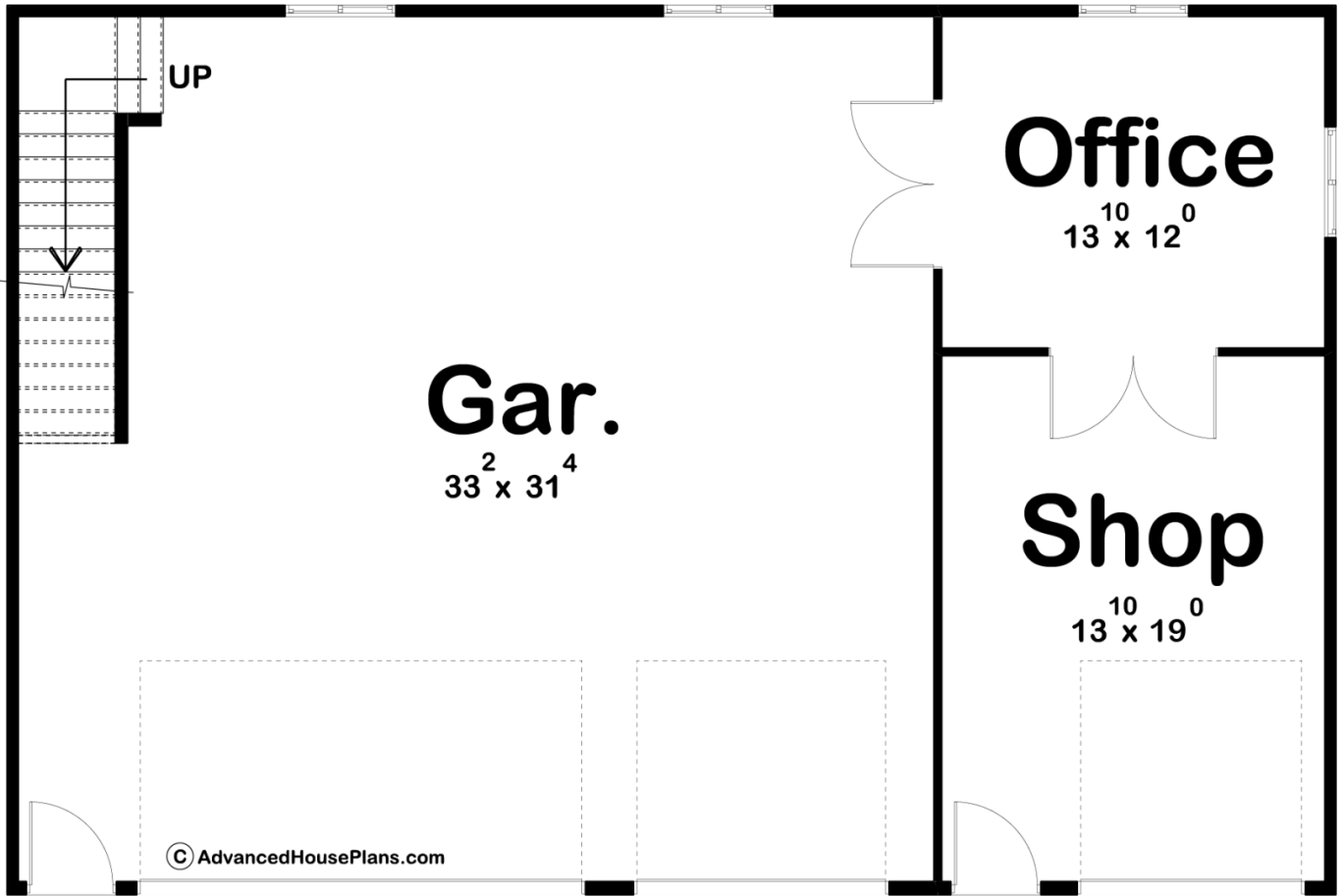

29399 - Stewart Data Sheet

684 SQ FT	0 BEDS	0 BATHS	4 BAYS	48' 0" WIDE	32' 0" DEEP
--------------	-----------	------------	-----------	----------------	----------------

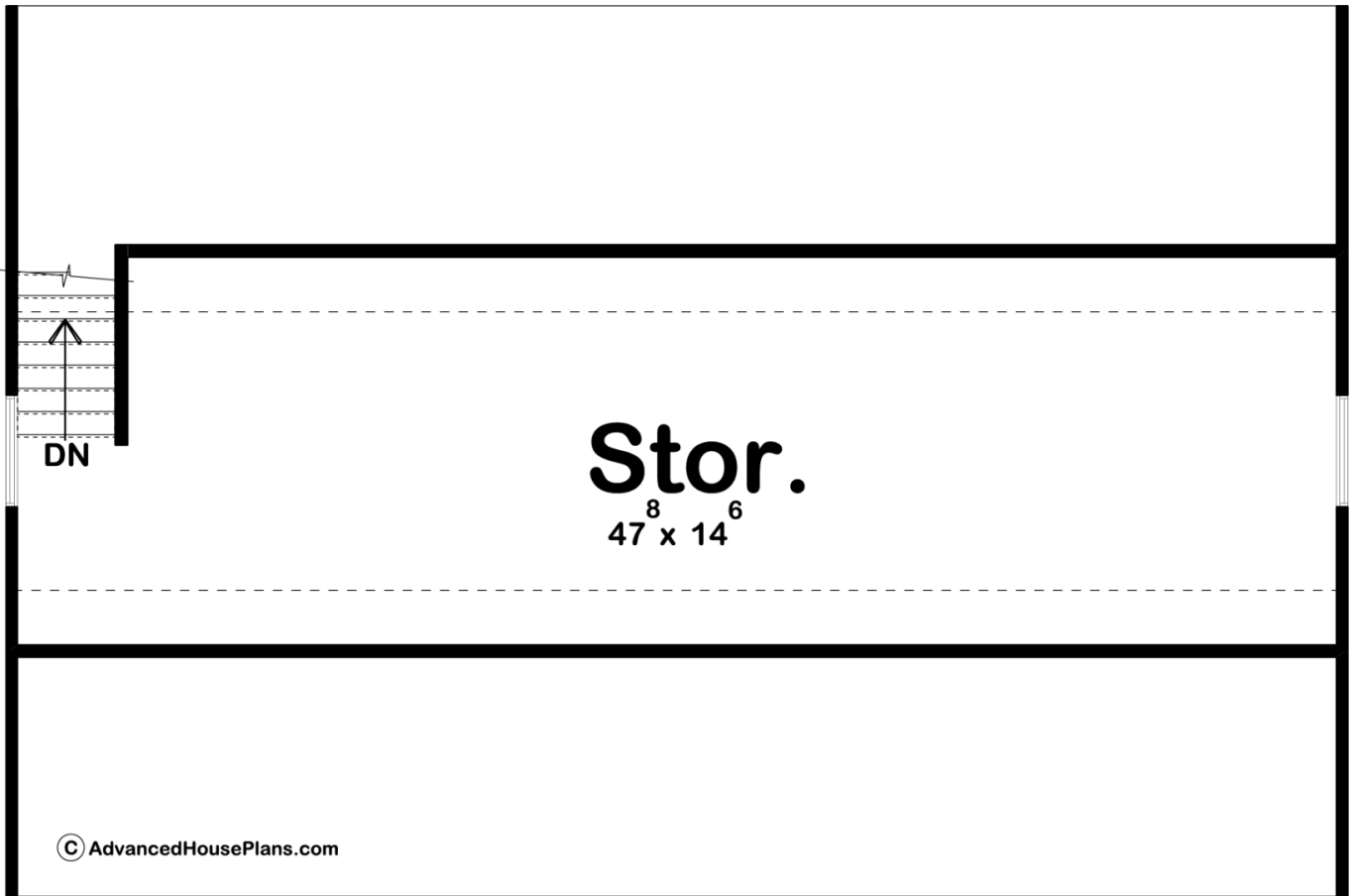



## Construction Specs

### Layout

Garage Bays 4

### Square Footage

Second Level 684 Sq. Ft.

Garage 1536 Sq. Ft.

Total Finished Area 684 Sq. Ft.

### Exterior Dimensions

Width 48' 0"

Depth 32' 0"

### Default Construction Stats

*Stats are unique to the individual plan.*

Foundation Type Slab

Exterior Wall Construction 2x4

Roof Pitches 10/12 Primary

Main Wall Height 10'

## Plan Description

The Stewart garage is a fantastic Craftsman style garage that includes a few unique features. On the exterior, the wood garage doors and shake siding combine with stone to give this garage a definitive craftsman facade. On the left side, there is a 3 car garage that features a 2 car bay and a 1 car bay. On the right side, there is an amazing shop that leads to an office through a set of french doors. On the second floor, you get a ton of storage space.