

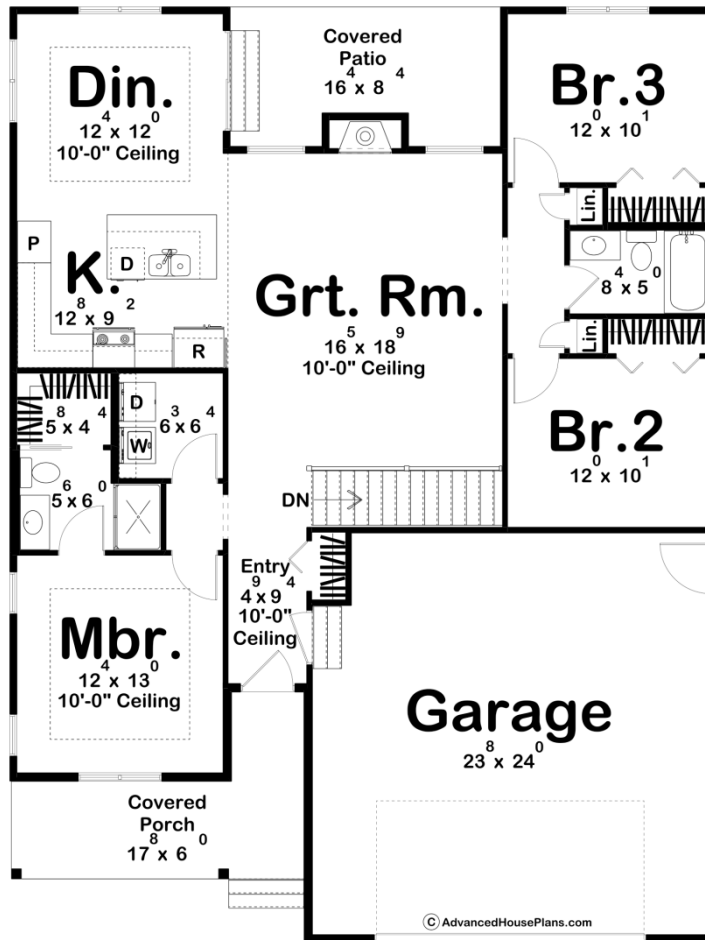

30472 - Springview Data Sheet

1436 SQ FT	3 BEDS	2 BATHS	2 BAYS	42' 0" WIDE	55' 8" DEEP
---------------	-----------	------------	-----------	----------------	----------------



Construction Specs

Layout

Bedrooms

Bathrooms	2
Garage Bays	2

Square Footage

Main Level	1436 Sq. Ft.
Covered Area	267 Sq. Ft.
Garage	580 Sq. Ft.
Total Finished Area	1436 Sq. Ft.

Exterior Dimensions

Width	42' 0"
Depth	55' 8"
Ridge Height <i>Calculated from main floor line</i>	19' 0"

Default Construction Stats

Stats are unique to the individual plan.

Foundation Type	Basement
Exterior Wall Construction	2x4
Roof Pitches	Primary 5/12, Secondary 8/12, 3/12
Foundation Wall Height	9'
Main Wall Height	9'

Plan Description

Discover the perfect blend of comfort and style in this beautiful modern farmhouse style home. This charming 3-bedroom, 2-bath ranch-style home boasts an inviting open floor plan that effortlessly blends style and comfort. Step into the spacious great room, where a cozy fireplace serves as the focal point, perfect for gathering with family and friends. The seamless flow connects the great room to the well-appointed kitchen and dining area, making it ideal for entertaining. The master bedroom, conveniently located next to the entry, features a raised tray ceiling that enhances the sense of space and elegance. Enjoy the luxurious master bath, complete with a walk-in closet that provides ample storage. Two additional bedrooms offer versatility, whether for family, guests, or a home office. This home's modern farmhouse aesthetic is complemented by thoughtful details throughout, creating a warm and inviting atmosphere. Discover the perfect blend of contemporary design and timeless charm in this beautiful ranch-style retreat.