

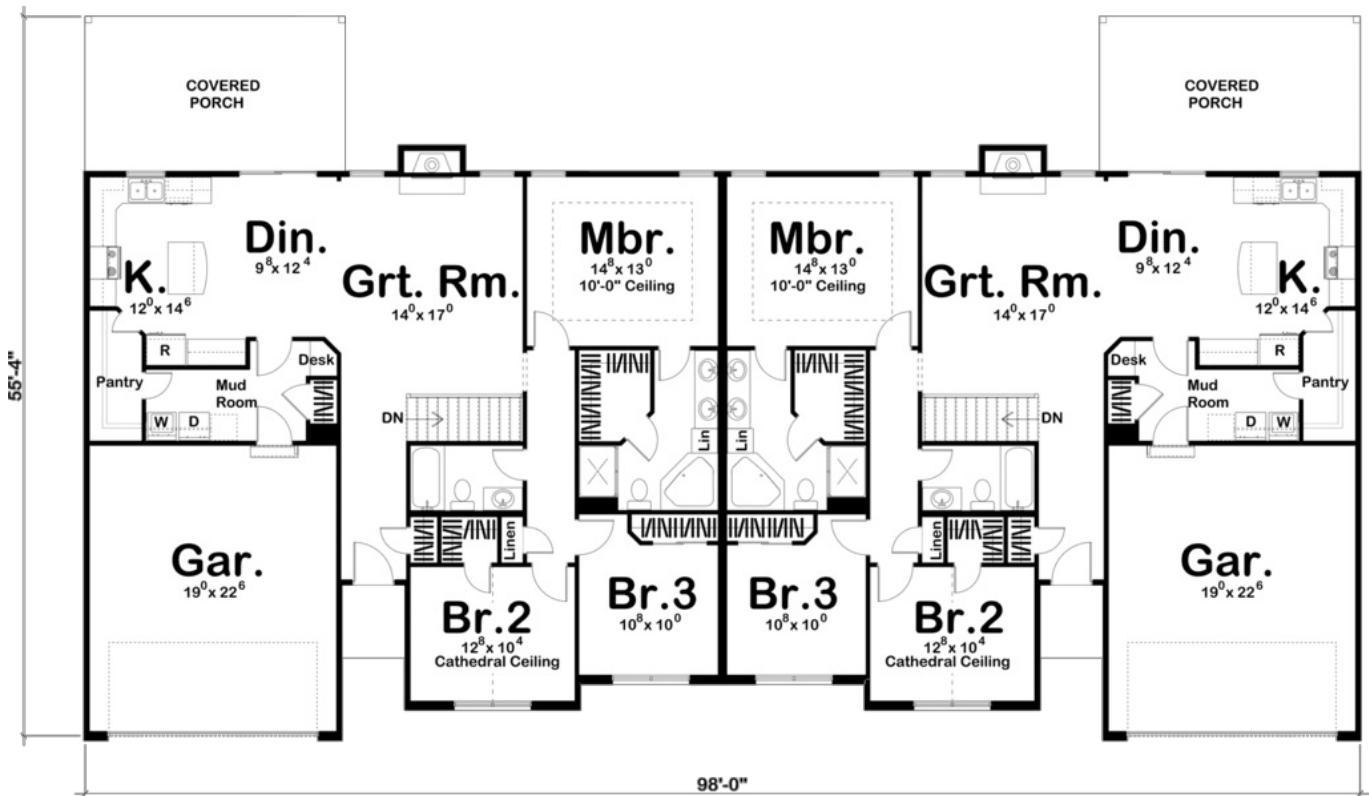

29332 - Snyder Data Sheet

1581 SQ FT	3 BEDS	2 BATHS	2 BAYS	98' 0" WIDE	56' 0" DEEP
---------------	-----------	------------	-----------	----------------	----------------



Construction Specs

Layout

Bedrooms

Bathrooms	2
-----------	---

Garage Bays	2
-------------	---

Square Footage

Main Level	1581 Sq. Ft.
------------	--------------

Garage	457 Sq. Ft.
--------	-------------

Total Finished Area	1581 Sq. Ft.
---------------------	--------------

Exterior Dimensions

Width	98' 0"
-------	--------

Depth	56' 0"
-------	--------

Default Construction Stats

Stats are unique to the individual plan.

Foundation Type	Basement
-----------------	----------

Exterior Wall Construction	2x4
----------------------------	-----

Roof Pitches	6/12 Primary
--------------	--------------

Foundation Wall Height	9'
------------------------	----

Main Wall Height	9'
------------------	----

Plan Description

Based off our popular Hadley house plan, the Snyder is a classy duplex appealing to builders and buyers alike. The floor plan features open living spaces, a generous Master Suite with a spacious walk-in closet, and a Covered Patio for entertaining and relaxing. As always any Advanced House Plans home plan can be customized to fit your needs with our alteration department. Whether you need to add another garage stall, change the front elevation, stretch the home larger or just make the home plan more affordable for your budget we can do that and more for you at Ahp. Unless you purchase an unlimited use license or a multi-use license you may only build one home from a set of plans. Plans cannot be re-sold.