

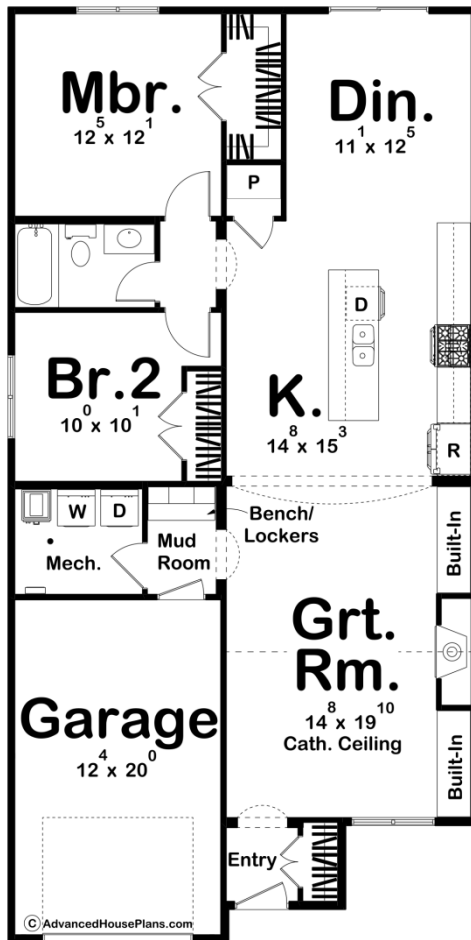

30248 - Seven Springs Data Sheet

1231 SQ FT	2 BEDS	1 BATHS	1 BAYS	28' 0" WIDE	55' 8" DEEP
---------------	-----------	------------	-----------	----------------	----------------



Construction Specs

Layout

Bedrooms

Bathrooms	1
Garage Bays	1
Square Footage	
Main Level	1231 Sq. Ft.
Garage	258 Sq. Ft.
Total Finished Area	1231 Sq. Ft.
Exterior Dimensions	
Width	28' 0"
Depth	55' 8"
Ridge Height <i>Calculated from main floor line</i>	21' 7"
Default Construction Stats <i>Stats are unique to the individual plan.</i>	
Foundation Type	Slab
Exterior Wall Construction	2x4
Roof Pitches	Primary 6/12, Secondary 10/12
Main Wall Height	9'

Plan Description

The Seven Springs is a cute Modern Cottage house plan. The exterior is inviting with a mixture of stone and board & batten siding. The interior embraces the antique aesthetic, but sprinkles in the modern elements. As you enter the front door, you find a coat closet in a vestibule space that separates the entry from the great room. Stepping in further, the great room is has tall cathedral ceilings with built-in fireplace and cabinets. The middle of the home is where you will find a full kitchen with a large island. There is a separate dining space that has access to the rear patio. The left side of the home houses the 1-car garage, a mud room with bench and lockers, and the laundry room which also acts as a mechanical room. This home has two bedrooms that share a hall bathroom.