

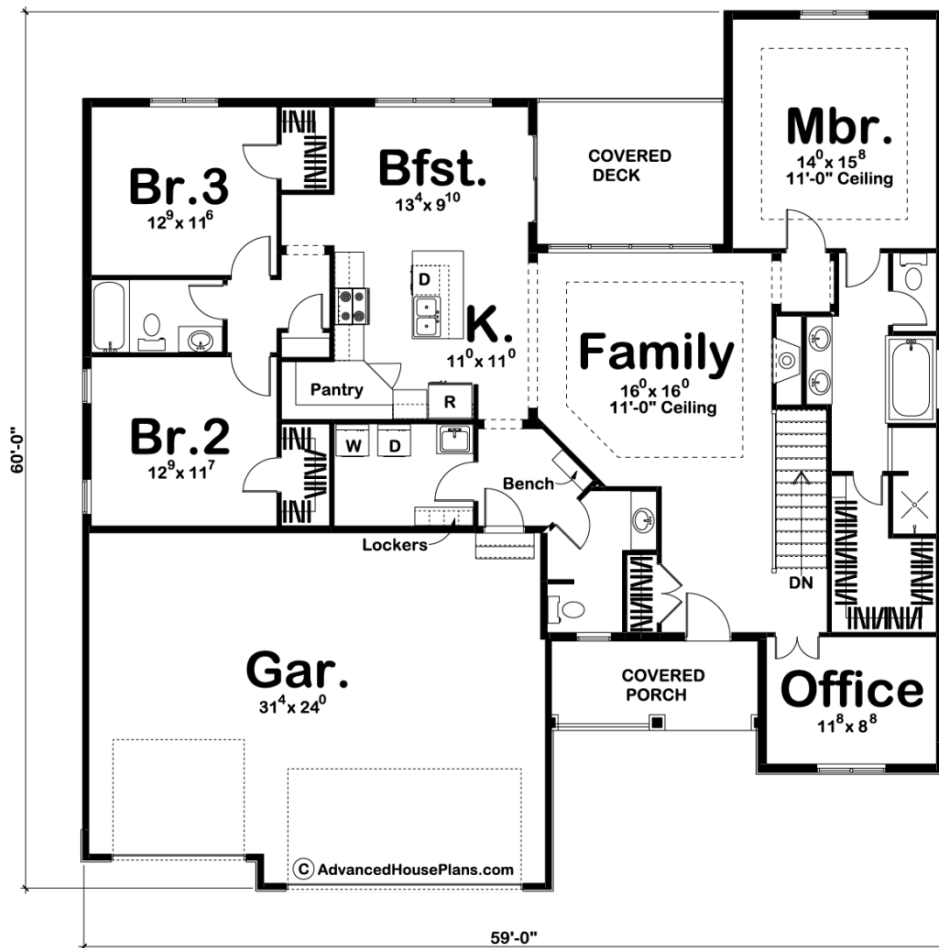

**29292 - Sellhorst Data Sheet**

2027 SQ FT	3 BEDS	3 BATHS	3 BAYS	59' 0" WIDE	60' 0" DEEP
---------------	-----------	------------	-----------	----------------	----------------



**Construction Specs**

**Layout**

Bedrooms

Bathrooms	3
Garage Bays	3

### Square Footage

Main Level	2027 Sq. Ft.
Garage	750 Sq. Ft.
Total Finished Area	2027 Sq. Ft.

### Exterior Dimensions

Width	59' 0"
Depth	60' 0"
Ridge Height <i>Calculated from main floor line</i>	22'

### Default Construction Stats

*Stats are unique to the individual plan.*

Foundation Type	Basement
Exterior Wall Construction	2x4
Roof Pitches	6/12
Foundation Wall Height	9'
Main Wall Height	10'

## Plan Description

Featuring a classic craftsman exterior facade, the Sellhorst is a stunning 1 story house plan with a great floor plan to match! The exterior features board and batten siding, thin-set stone veneer, standing seam metal roof, and a shed dormer over the porch. This 3 bedroom home plan has a unique open floor plan perfect for entertaining. 2 covered porches make a nice place to nestle in with your morning coffee. The master suite has a tub, walk-in shower, and a roomy closet. On the opposite side of the home, cooking will be a breeze with a large island in the kitchen and spacious walk-in pantry to keep things organized. Behind the kitchen has 2 secondary bedrooms with a shared hall bath and each bedroom has a walk-in closet.