

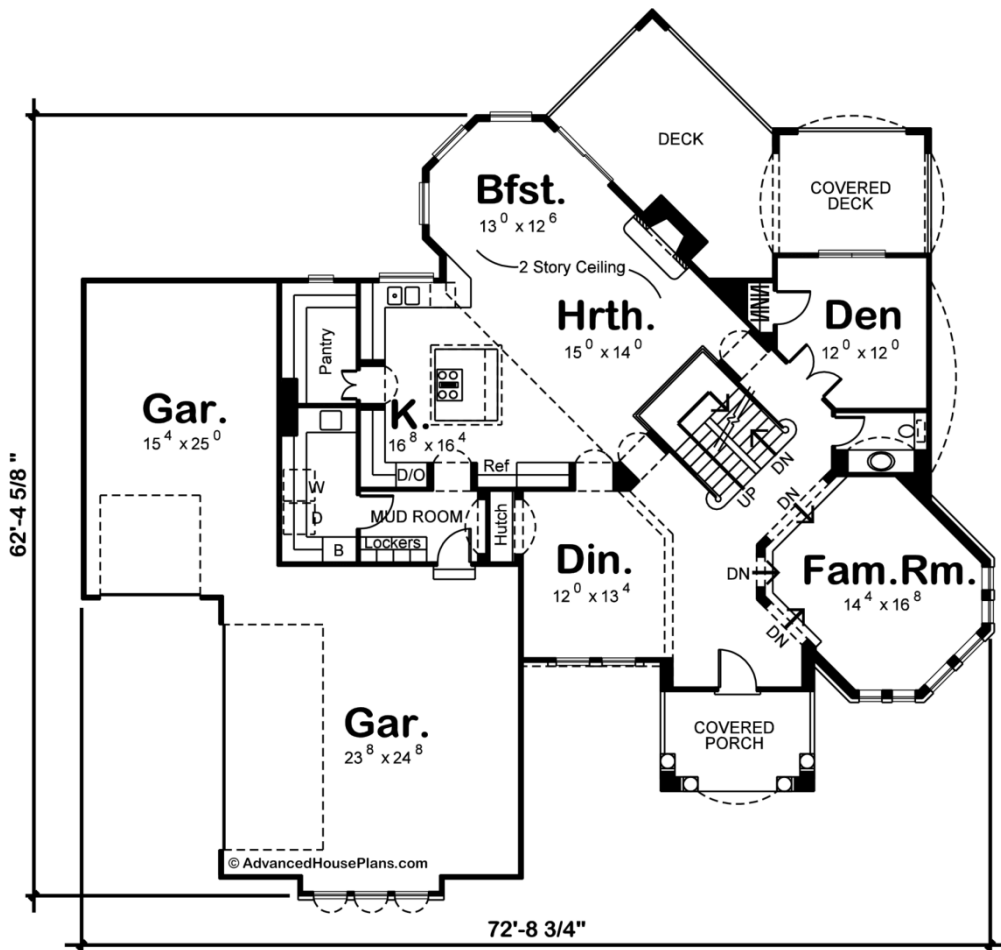

29246 - Santa Clara Data Sheet

3086 SQ FT	4 BEDS	4 BATHS	3 BAYS	73' 0" WIDE	63' 0" DEEP
---------------	-----------	------------	-----------	----------------	----------------

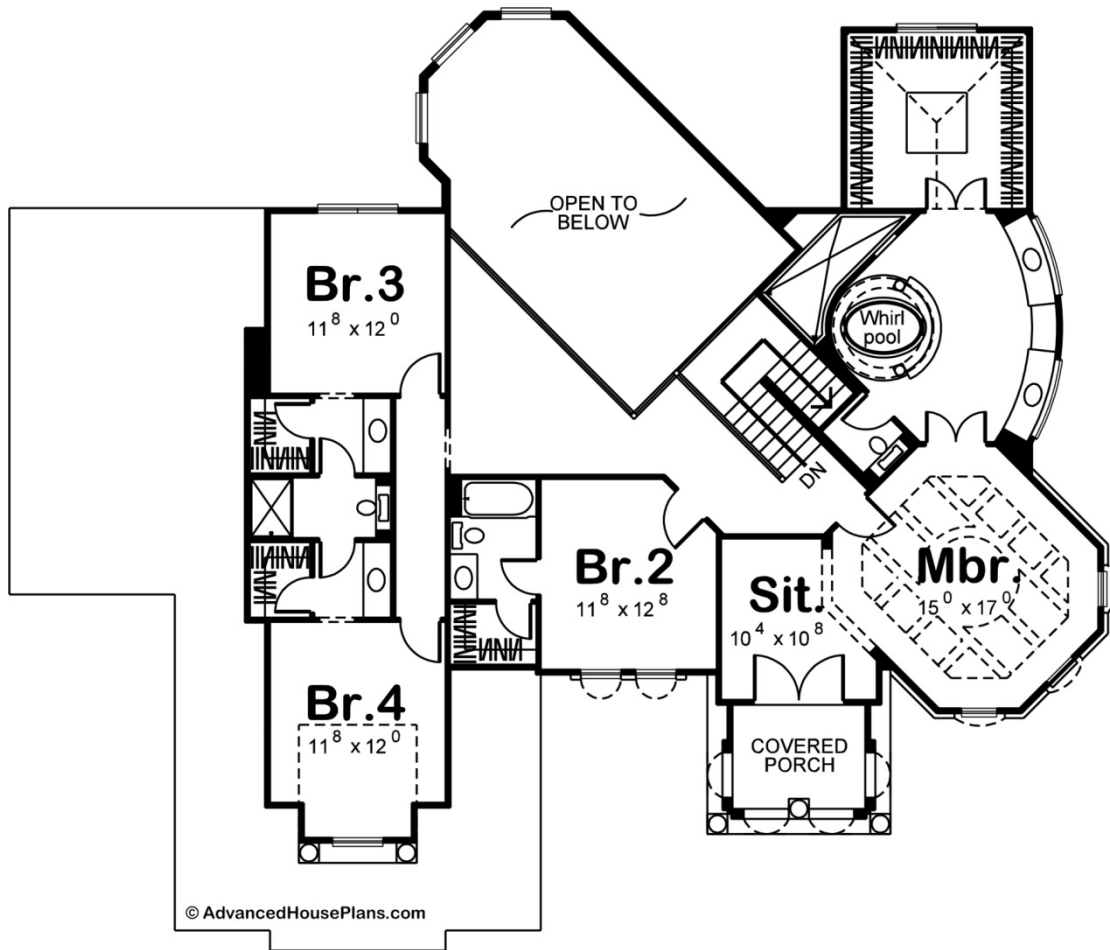



Construction Specs

Layout

Bedrooms	4
Bathrooms	4
Garage Bays	3

Square Footage

Main Level	1780 Sq. Ft.
Second Level	1306 Sq. Ft.
Garage	1011 Sq. Ft.
Total Finished Area	3086 Sq. Ft.

Exterior Dimensions

Width	73' 0"
Depth	63' 0"
Ridge Height	29'
<i>Calculated from main floor line</i>	

Default Construction Stats

Stats are unique to the individual plan.

Foundation Type	Basement
Exterior Wall Construction	2x4
Roof Pitches	6/12
Foundation Wall Height	9'
Main Wall Height	9'
Second Wall Height	9'

Plan Description

29246 Santa Clara Striking design details abound in this 4-bedroom, 2-story, Mediterranean style house plan. Upon entering the home, guest are treated to views into both the formal dining room, with built-in hutch, and the sunken family room, which is brightened by an array of tall windows. Beyond the family room, a pair of double doors open to the den, which enjoys access to a covered rear deck. Angled away from the den, beyond the staircase, a hearth room and breakfast area reside beneath a 2-story-high ceiling. Entertaining options are greatly expanded where the breakfast area accesses an open rear deck that adjoins the covered deck. The kitchen is a cook's dream, with an abundance of counter space, large island work area and sizeable walk-in pantry. Just off the kitchen lies a mud room with lockers and an adjoining laundry room with ample counter space and soaking sink. The mud room provides passage to and from the home's 3-car garage. Amazing details continue to be found upstairs, where the master suite resides with a sitting room, private covered porch, and sprawling bath area that showcases a soaking tub, his-and-her vanities, large walk-in shower and roomy walk-in closet. Bedroom 2 has a walk-in closet and private bath. Bedrooms 3 and 4 each have walk-in closets and share a Jack-n-Jill bath. advanced house plans