

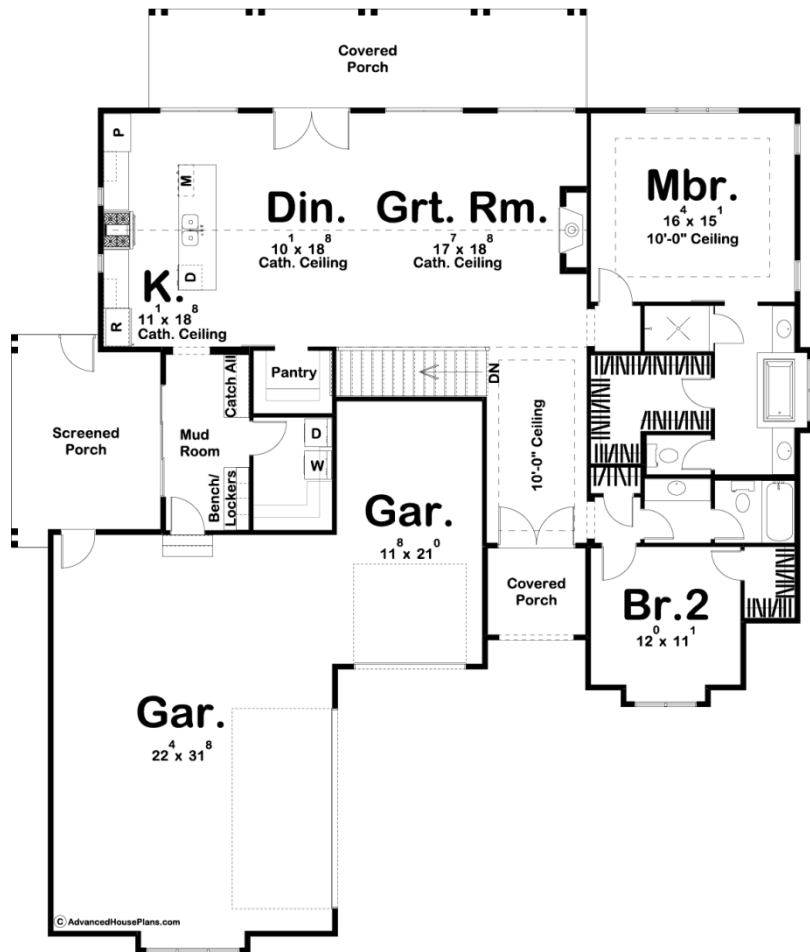

29608 - Sanibel Data Sheet

1900 SQ FT	2 BEDS	2 BATHS	3 BAYS	64' 0" WIDE	75' 4" DEEP
---------------	-----------	------------	-----------	----------------	----------------



Construction Specs

Layout

Bedrooms

Bathrooms	2
-----------	---

Garage Bays	3
-------------	---

Square Footage

Main Level	1900 Sq. Ft.
------------	--------------

Garage	1019 Sq. Ft.
--------	--------------

Total Finished Area	1900 Sq. Ft.
---------------------	--------------

Exterior Dimensions

Width	64' 0"
-------	--------

Depth	75' 4"
-------	--------

Default Construction Stats

Stats are unique to the individual plan.

Foundation Type	Basement
-----------------	----------

Exterior Wall Construction	2x4
----------------------------	-----

Roof Pitches	10/12 Primary, 12/12 6/12 Secondary
--------------	-------------------------------------

Foundation Wall Height	9'
------------------------	----

Main Wall Height	9'
------------------	----

Plan Description

This beautifully configured Modern Farmhouse plan offers amenities that are usually found in much larger home designs. On the outside, board and batten siding and a covered porch put on a striking display of curb appeal. Just inside, you'll be amazed at the open floor plan including a magnificent Great Room, which is warmed by a fireplace and flows into a dining room and large kitchen. The kitchen boasts plenty of counter space in addition to the spacious island. Just beyond the dining area, a covered porch extends entertaining options. The master suite enjoys a luxurious bath, complete with compartmented toilet, walk-in shower, dual vanities, and a large walk-in closet. On the other side of this house plan, the large 3 car garage accesses the home through a convenient mud room complete with a bench, lockers, and a catch-all. As always any Advanced House Plans home plan can be customized to fit your needs with our alteration department. Whether you need to add another garage stall, change the front elevation, stretch the home larger or just make the home plan more affordable for your budget we can do that and more for you at Ahp.