

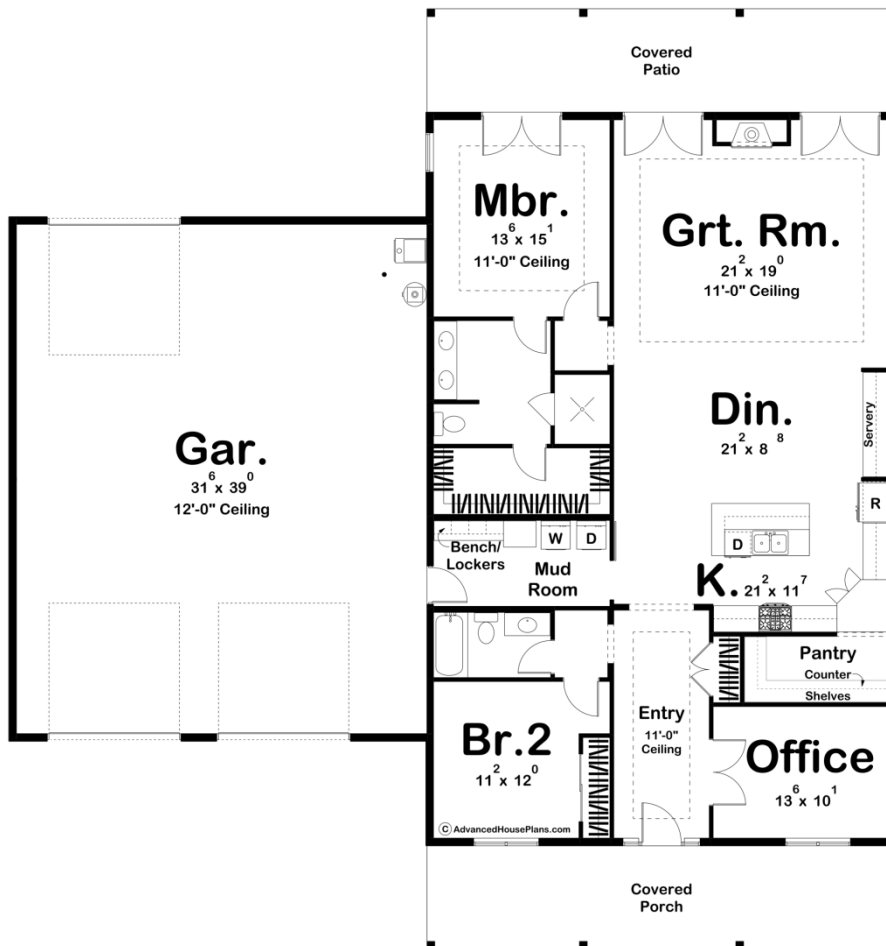

30122 - Rolling Hills Data Sheet

| | | | | | |
|---------------|-----------|------------|-----------|----------------|----------------|
| 2016 SQ FT | 2 BEDS | 2 BATHS | 3 BAYS | 68' 0" WIDE | 72' 0" DEEP |
|---------------|-----------|------------|-----------|----------------|----------------|



Construction Specs

Layout

Bedrooms

| | |
|-----------|---|
| Bathrooms | 2 |
|-----------|---|

| | |
|-------------|---|
| Garage Bays | 3 |
|-------------|---|

Square Footage

| | |
|------------|--------------|
| Main Level | 2016 Sq. Ft. |
|------------|--------------|

| | |
|--------------|-------------|
| Covered Area | 576 Sq. Ft. |
|--------------|-------------|

| | |
|--------|--------------|
| Garage | 1280 Sq. Ft. |
|--------|--------------|

| | |
|---------------------|--------------|
| Total Finished Area | 2016 Sq. Ft. |
|---------------------|--------------|

Exterior Dimensions

| | |
|-------|--------|
| Width | 68' 0" |
|-------|--------|

| | |
|-------|--------|
| Depth | 72' 0" |
|-------|--------|

Default Construction Stats

Stats are unique to the individual plan.

| | |
|-----------------|------|
| Foundation Type | Slab |
|-----------------|------|

| | |
|----------------------------|-----|
| Exterior Wall Construction | 2x6 |
|----------------------------|-----|

| | |
|--------------|------------------------------|
| Roof Pitches | 6/12 Primary, 3/12 Secondary |
|--------------|------------------------------|

| | |
|------------------|-----|
| Main Wall Height | 10' |
|------------------|-----|

Plan Description

The Rolling Hills plan is a beautiful Barndominium style house plan. A trio of dormers and a large front covered porch invite guests into the home. Immediately inside the home, you'll find a practical home office that is perfect for working from home. Further inside the home, you'll notice the wide open layout of this home. The kitchen includes a large island with a snack ledge and a pantry with built-in shelves. The dining room has an amazing built-in server. The stunning great room lies under an 11' tall trayed ceiling and is warmed by a fireplace. A pair of French doors lead from the great room to the rear covered patio. Just off the great room, there is an amazing master suite. The master bathroom includes dual vanities, a walk-in shower, and a large walk-in closet. A second bedroom is located in the front of the home and shares a bathroom with the rest of the living area. The home's oversized 3 car drive through garage enters the home through a mud room that includes a bench and lockers.