

ADVANCED
HOUSE PLANS

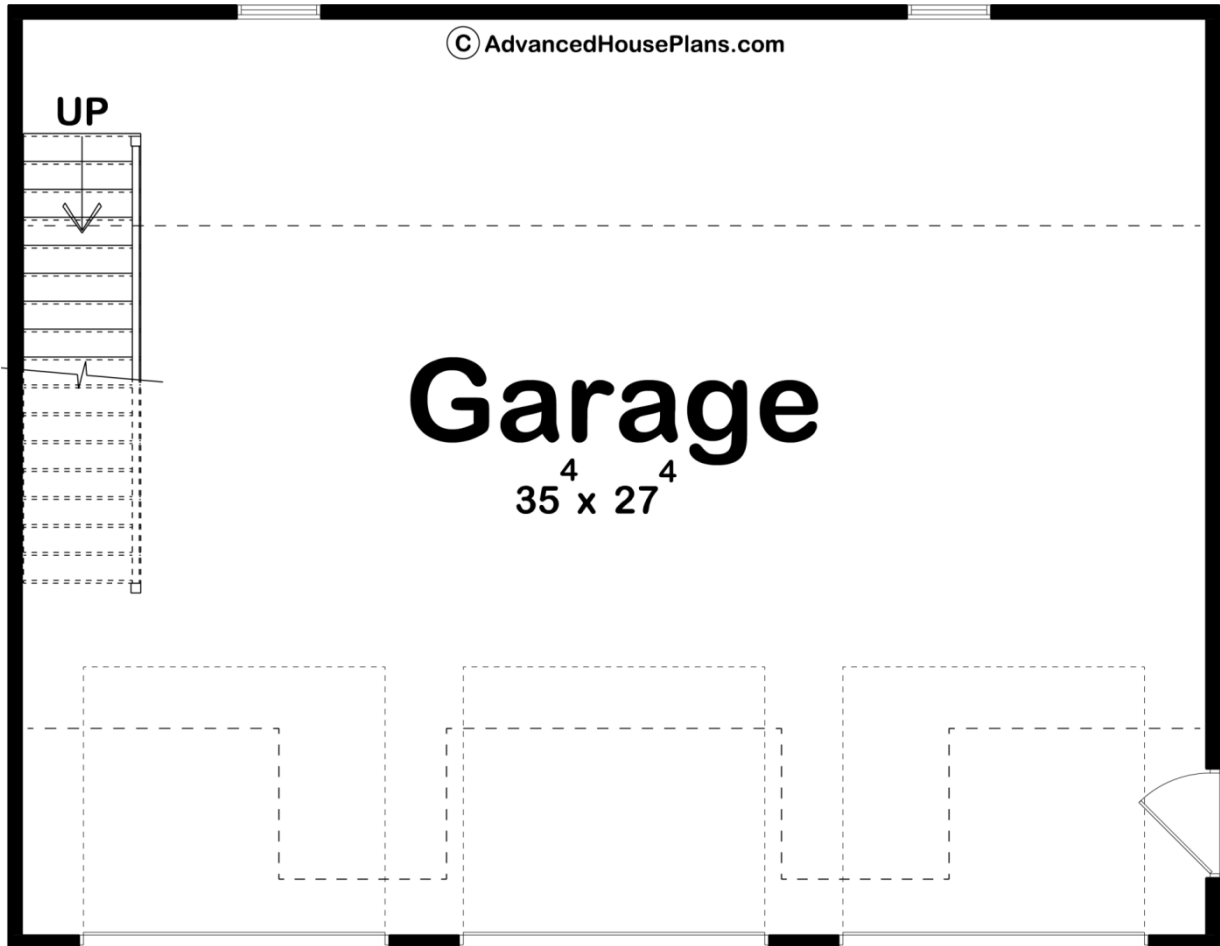

30014 - Ranger Data Sheet

0 SQ FT	0 BEDS	0 BATHS	3 BAYS	36' 0" WIDE	28' 0" DEEP
------------	-----------	------------	-----------	----------------	----------------



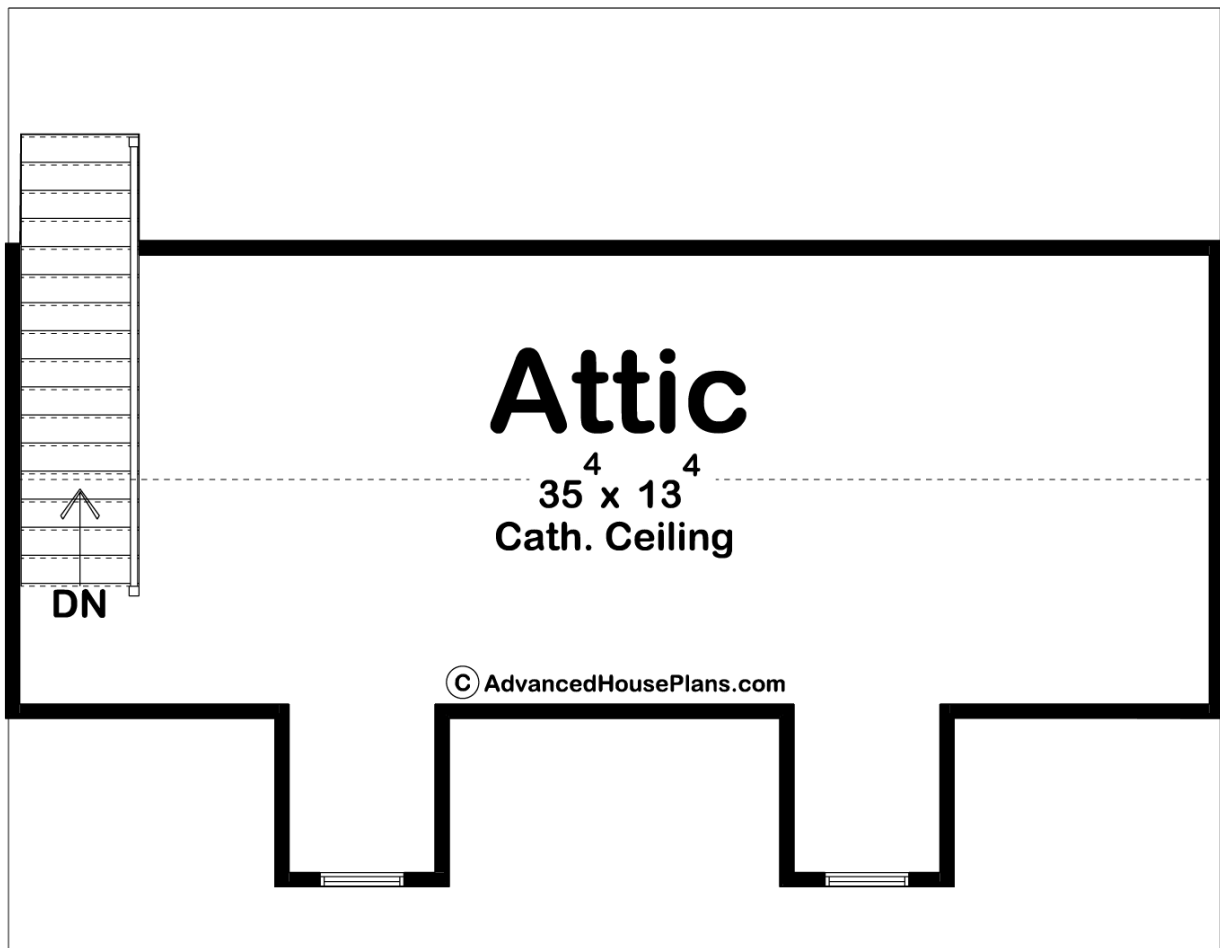

Construction Specs

Layout

Garage Bays 3

Square Footage

Garage 1008 Sq. Ft.

Exterior Dimensions

Width 36' 0"

Depth 28' 0"

Ridge Height 23'
Calculated from main floor line

Default Construction Stats

Stats are unique to the individual plan.

Foundation Type Slab

Exterior Wall Construction 2x4

Roof Pitches 10/12 Primary

Main Wall Height 9'

Plan Description

This is a traditional style 3 car garage plan. It is built on a slab foundation. The garage includes attic space above with built-in stairs for easy access. The attic space has two usable dormers with windows in them for natural light. It has a cathedral ceiling.