

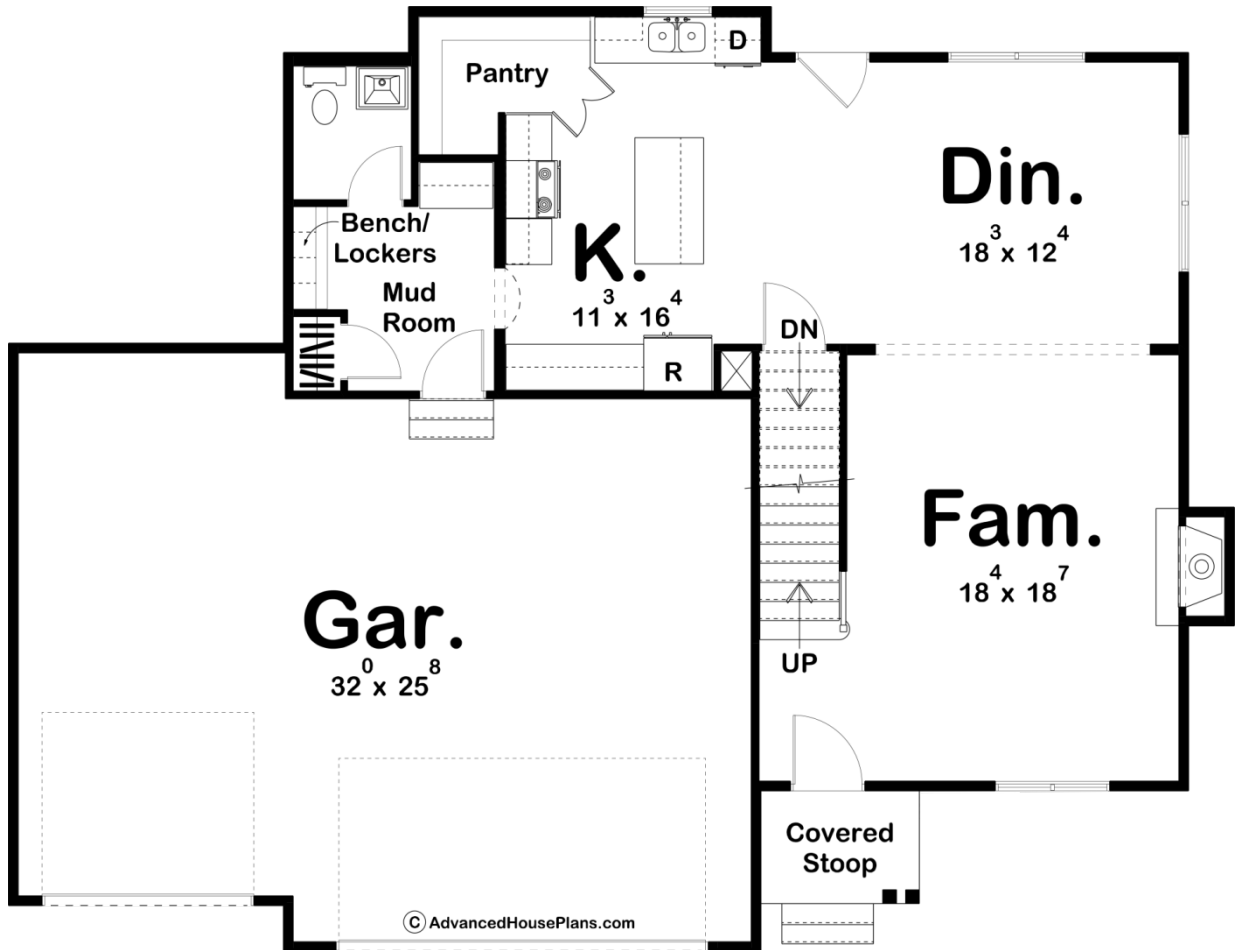

**29689 - Prairie Rose Data Sheet**

2198 SQ FT	4 BEDS	3 BATHS	3 BAYS	52' 0" WIDE	41' 0" DEEP
---------------	-----------	------------	-----------	----------------	----------------

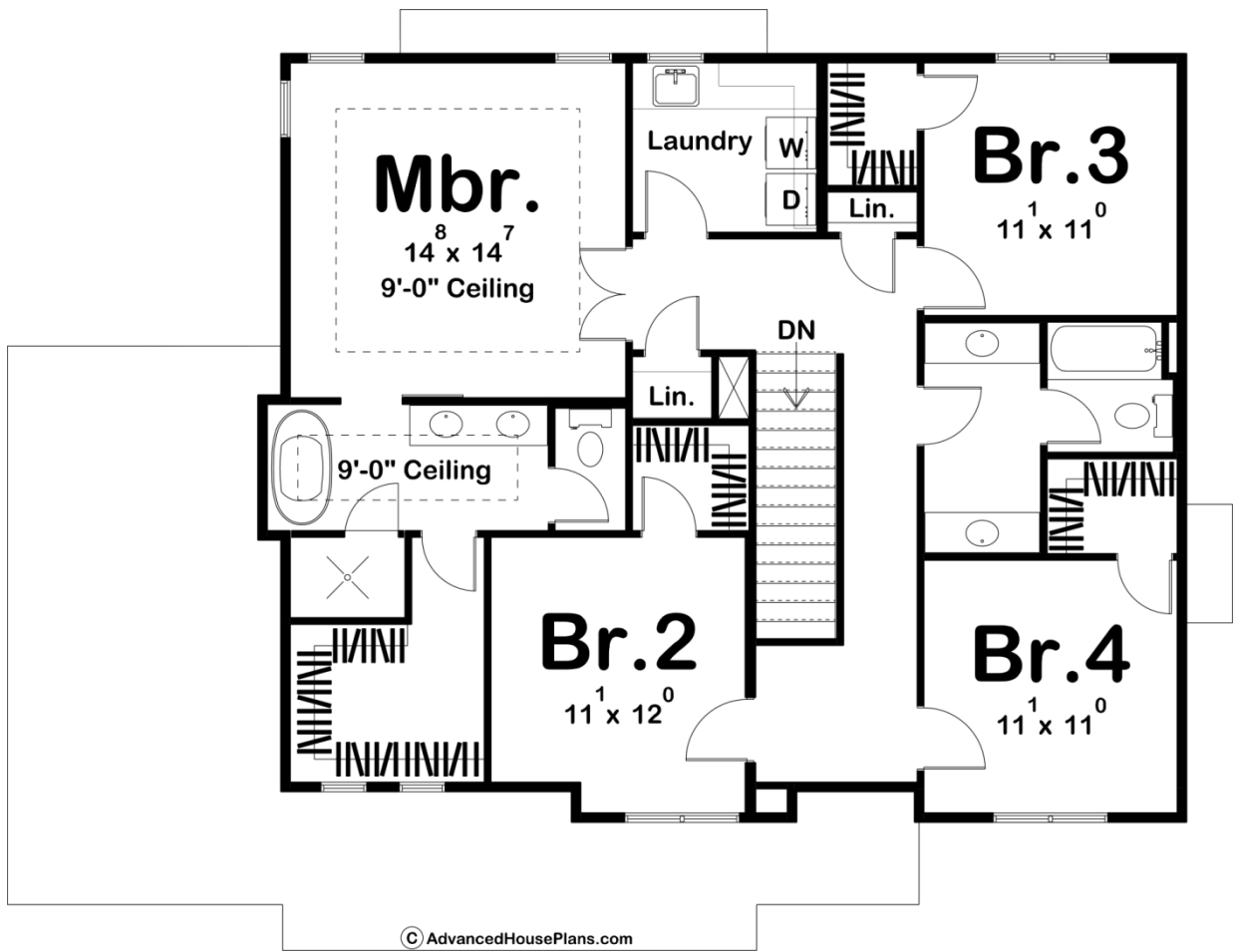



## Construction Specs

### Layout

Bedrooms	4
Bathrooms	3
Garage Bays	3

### Square Footage

Main Level	948 Sq. Ft.
Second Level	1250 Sq. Ft.
Garage	788 Sq. Ft.
Total Finished Area	2198 Sq. Ft.

### Exterior Dimensions

Width	52' 0"
Depth	41' 0"

### Default Construction Stats

*Stats are unique to the individual plan.*

Foundation Type	Basement
-----------------	----------

Exterior Wall Construction	2x4
Roof Pitches	6/12 Primary, 8/12 Secondary
Foundation Wall Height	9'
Main Wall Height	9'
Second Wall Height	8'

## Plan Description

The Prairie Rose is a charming Modern Farmhouse style plan. The front elevation features a front stoop with wood columns and stone accents. Upon entry, you will see an excellent open floorplan that has great flow. The Family Room is warmed by a fireplace and flows perfectly to the dining room. The kitchen is great for the cook in the house and it has ample storage with the walk-in pantry. Upstairs in this 2 story house plan, you have 4 bedrooms. Bedrooms 2, 3 and 4 share a centrally located bathroom that comes with dual vanities. The master suite includes a beautiful bathroom that features a walk-in shower and a private stool room. This 2 story house plan is great for your growing family!