

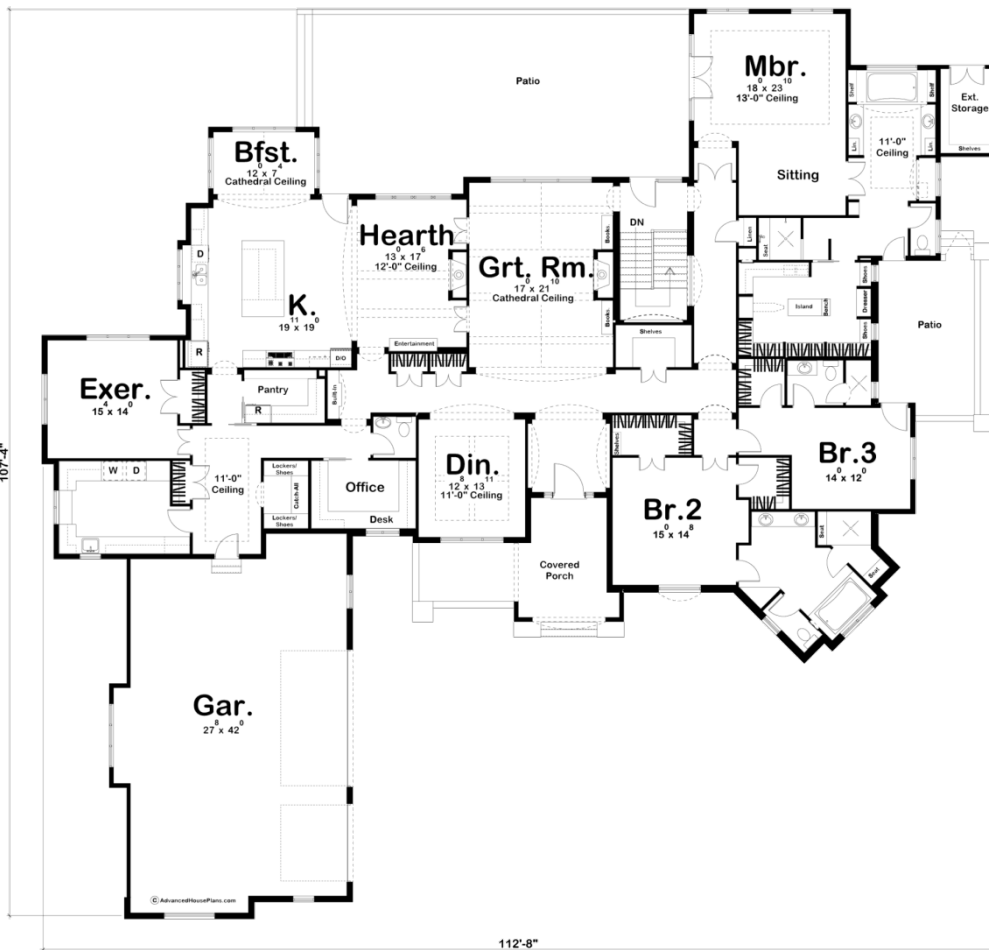

29390 - Prairie Pines Data Sheet

| | | | | | |
|---------------|-----------|------------|-----------|-----------------|-----------------|
| 4853 SQ FT | 3 BEDS | 4 BATHS | 3 BAYS | 113' 0" WIDE | 108' 0" DEEP |
|---------------|-----------|------------|-----------|-----------------|-----------------|



Construction Specs

Layout

Bedrooms

| | |
|--|--------------|
| Bathrooms | 4 |
| Garage Bays | 3 |
| Square Footage | |
| Main Level | 4853 Sq. Ft. |
| Garage | 1145 Sq. Ft. |
| Total Finished Area | 4853 Sq. Ft. |
| Exterior Dimensions | |
| Width | 113' 0" |
| Depth | 108' 0" |
| Ridge Height <i>Calculated from main floor line</i> | 35' |
| Default Construction Stats <i>Stats are unique to the individual plan.</i> | |
| Foundation Type | Basement |
| Exterior Wall Construction | 2x4 |
| Roof Pitches | 12/12 |
| Foundation Wall Height | 9' |
| Main Wall Height | 10' |

Plan Description

Prairie Pines is a luxurious house plan, exquisitely designed and full of beautiful features and elegant surprises. Every inch of this home has been thoughtfully considered - this is truly a dream home of the highest order! With refined French Country styling from front to back, Prairie Pines is sure to stand out from the crowd. This gorgeous ranch home plan features finely detailed rooms, including a cathedral ceiling great room with decorative wood trusses. There is an informal breakfast nook as well as a formal dining room for special occasions. The Master Suite is impressive with a large tub, walk-in tile shower, and a large walk-in closet with plenty of storage space. Prairie Pines is designed with 10' 2x6 walls, with 12/12 roof pitches. The plan has a basement foundation with 9' walls.