

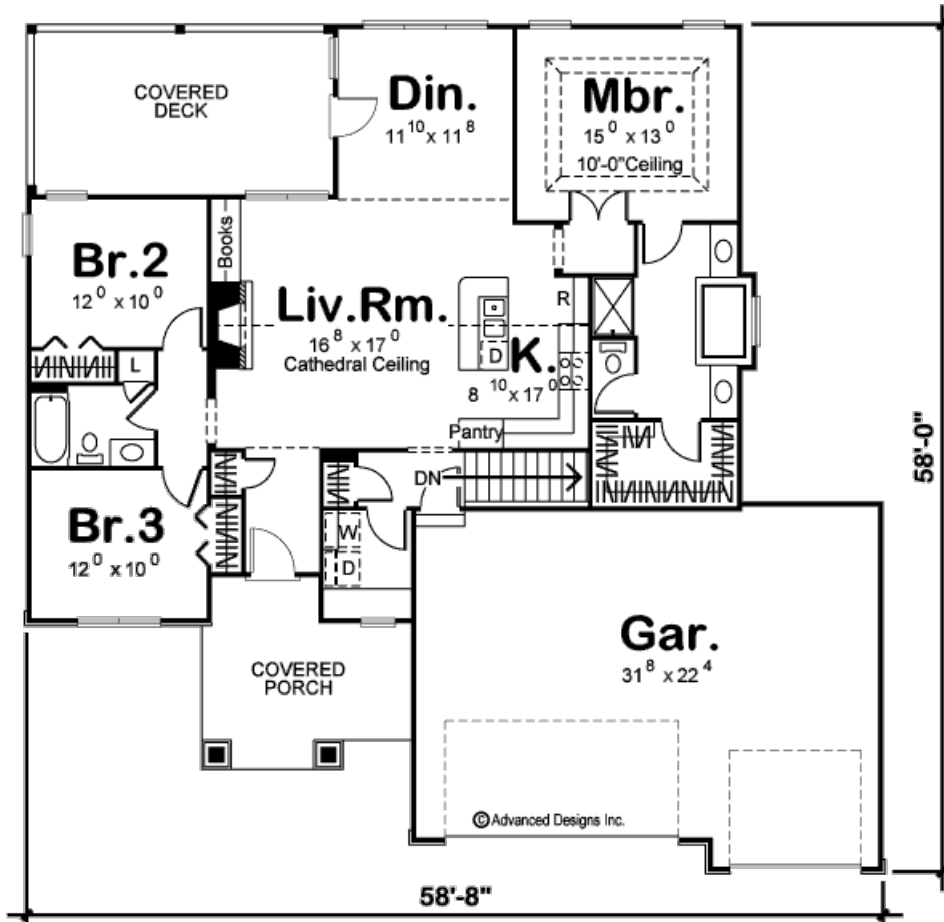

29194 - Picket Data Sheet

1568 SQ FT	3 BEDS	2 BATHS	3 BAYS	59' 0" WIDE	58' 0" DEEP
---------------	-----------	------------	-----------	----------------	----------------



Construction Specs

Layout

Bedrooms

Bathrooms	2
Garage Bays	3

Square Footage

Main Level	1568 Sq. Ft.
Garage	761 Sq. Ft.
Total Finished Area	1568 Sq. Ft.

Exterior Dimensions

Width	59' 0"
Depth	58' 0"
Ridge Height <i>Calculated from main floor line</i>	23'

Default Construction Stats

Stats are unique to the individual plan.

Foundation Type	Basement
Exterior Wall Construction	2x4
Roof Pitches	6/12
Foundation Wall Height	9'
Main Wall Height	9'

Plan Description

A tasteful blend of textures adorns the exterior of this 1,568 sq. ft., Traditional-style, 1-story house plan. Just inside from the deep covered front porch, the entry hall invites guests into the living room, with its cathedral ceiling, fireplace, and built-in bookcase. The kitchen and dining room share this open space for easy entertaining. The kitchen itself features an island workspace, wrapping counters, and a pantry. The adjacent dining area accesses a rear covered deck, perfect for enjoying meals outside. On the opposite side of the kitchen, a utility area intercepts outside traffic from the home's 3-car, front-load garage. Just off the kitchen, an alcove grants access to the private master suite, where the bedroom resides beneath a 10-foot-high ceiling. The bath area features his-and-her vanities, a soaking tub, shower, compartmented toilet and walk-in closet. Secondary bedrooms are found on the opposing side of the home, where they share a hall bath.

Traditional-style, 1-story house plan. Just inside from the deep covered front porch, the entry hall invites guests into the living room, with its cathedral ceiling, fireplace and built-in bookcase. The kitchen and dining room share this open space for easy entertaining. The kitchen itself features an island workspace, wrapping counters, and a pantry. The adjacent dining area accesses a rear covered deck, perfect for enjoying meals outside. On the opposite side of the kitchen, a utility area intercepts outside traffic from the home's 3-car, front-load garage. Just off the kitchen, an alcove grants access to the private master suite, where the bedroom resides beneath a 10-foot-high ceiling. The bath area features his-and-her vanities, a soaking tub, shower, compartmented toilet and walk-in closet. Secondary bedrooms are found on the opposing side of the home, where they share a hall bath.