

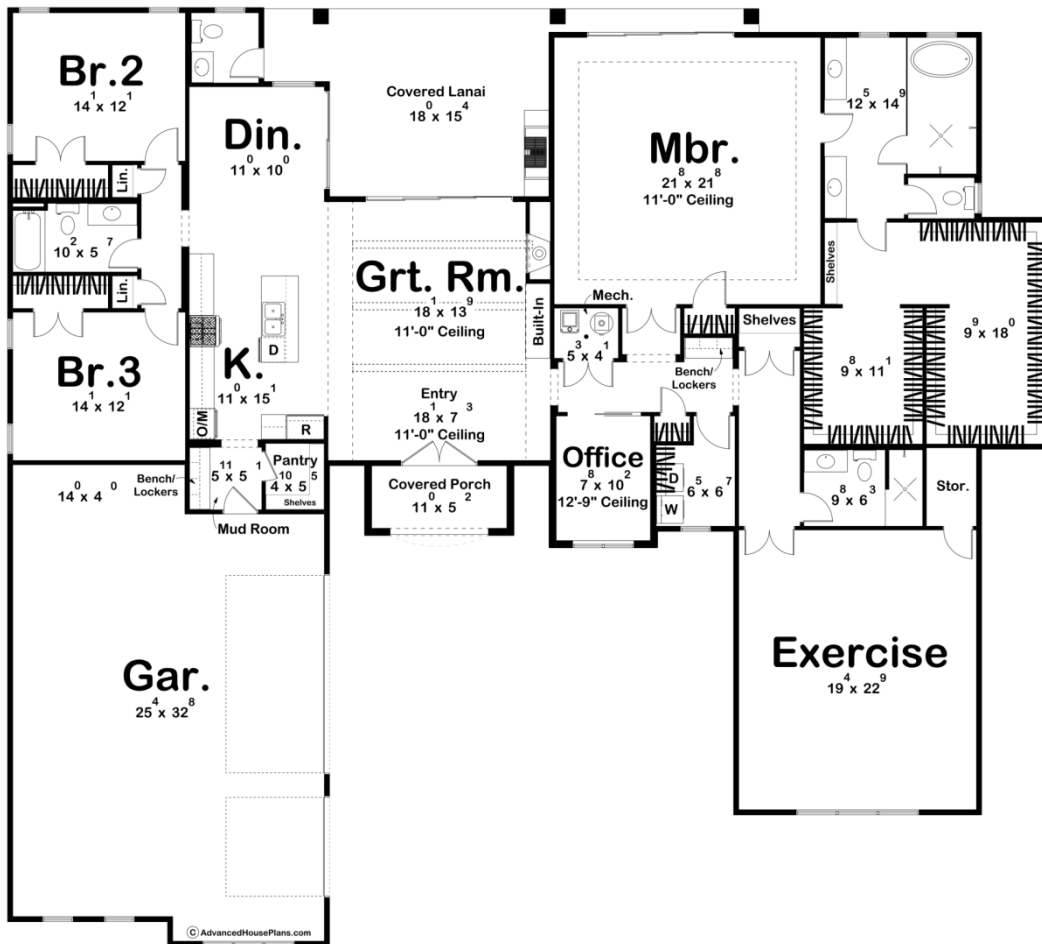

30334 - Northside Data Sheet

3334 SQ FT	3 BEDS	3 BATHS	3 BAYS	84' 8" WIDE	76' 0" DEEP
---------------	-----------	------------	-----------	----------------	----------------



Construction Specs

Layout

Bedrooms

Bathrooms	3
Garage Bays	3

Square Footage

Main Level	3334 Sq. Ft.
Covered Area	342 Sq. Ft.
Garage	941 Sq. Ft.
Total Finished Area	3334 Sq. Ft.

Exterior Dimensions

Width	84' 8"
Depth	76' 0"
Ridge Height <i>Calculated from main floor line</i>	21' 5"

Default Construction Stats

Stats are unique to the individual plan.

Foundation Type	Slab
Exterior Wall Construction	2x4
Roof Pitches	6/12 Primary
Main Wall Height	10'

Plan Description

Welcome to the epitome of Mediterranean elegance and modern living, embodied in this exquisite house plan. Drawing inspiration from the timeless beauty of Mediterranean architecture, this home seamlessly blends Old World charm with contemporary comforts. As you approach the front entrance, you're greeted by the grandeur of a 3-car courtyard garage, hinting at the luxury that awaits within. Stepping through the front door, you're immediately enveloped in the warm embrace of the great room. The tray ceiling adorned with intricate wood beams creates a sense of architectural grandness, inviting you to gaze upwards in awe. At the heart of this room, a striking fireplace adds a touch of coziness and creates a focal point that exudes comfort and style. Natural light floods the great room, courtesy of a generously proportioned sliding door that seamlessly connects the indoors with the outdoors. This sliding door opens onto a covered lanai in the rear, blurring the boundaries between interior and exterior spaces. Here, you can envision lazy afternoons and evening gatherings, basking in the Mediterranean breeze while enjoying the tranquility of your private outdoor oasis. The kitchen stands as the heart of the home, open to both the great room and the adjacent dining area. A hub of culinary creativity and conviviality, it offers a perfect setting for creating gourmet meals or entertaining loved ones. The dining area's proximity ensures that every meal is an occasion, with a seamless flow between dining and relaxation. The architectural layout thoughtfully divides the sleeping quarters into distinct wings. On the left side, two bedrooms share a well-appointed hall bathroom. These bedrooms provide cozy havens for family members or guests, ensuring privacy and comfort. On the right wing lies a true sanctuary—the master suite. A spacious retreat, the master bedroom exudes luxury with its ample proportions and elegant design. The ensuite master bathroom is a symphony of opulence, boasting features that transform daily routines into indulgent rituals. His and her walk-in closets provide abundant storage and organization space, catering to the

needs of modern living. For those committed to a healthy lifestyle, the presence of a large exercise room on the right side is a welcome addition. It offers the perfect space for workouts and physical well-being, ensuring that health goals are easily within reach. In this Mediterranean-inspired haven, every detail has been meticulously crafted to evoke a sense of luxury, comfort, and sophistication. With its harmonious blend of architectural elegance, modern amenities, and an innate connection to nature, this house plan promises an exceptional living experience that is both timeless and contemporary.