

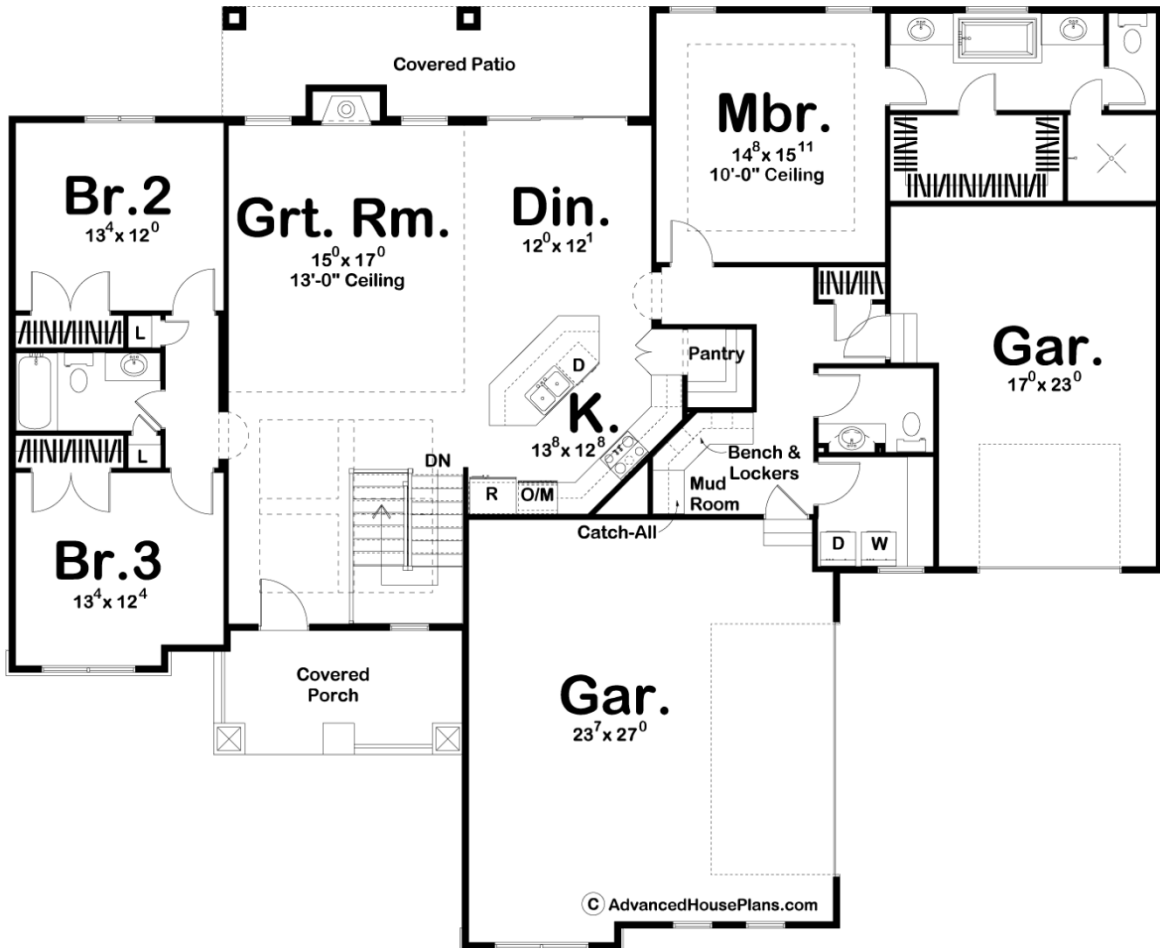

**29334 - Nordstrom Data Sheet**

2070 SQ FT	3 BEDS	3 BATHS	3 BAYS	74' 0" WIDE	60' 0" DEEP
---------------	-----------	------------	-----------	----------------	----------------



**Construction Specs**

**Layout**

Bedrooms

Bathrooms	3
-----------	---

Garage Bays	3
-------------	---

### Square Footage

Main Level	2070 Sq. Ft.
------------	--------------

Garage	991 Sq. Ft.
--------	-------------

Total Finished Area	2070 Sq. Ft.
---------------------	--------------

### Exterior Dimensions

Width	74' 0"
-------	--------

Depth	60' 0"
-------	--------

Ridge Height	28' 0"
--------------	--------

*Calculated from main floor line*

### Default Construction Stats

*Stats are unique to the individual plan.*

Foundation Type	Basement
-----------------	----------

Exterior Wall Construction	2x4
----------------------------	-----

Roof Pitches	8/12 F-B, 10/12 S-S
--------------	---------------------

Foundation Wall Height	9'
------------------------	----

Main Wall Height	9'
------------------	----

## Plan Description

The Nordstrom is an elegant balance of beautiful design and cost-saving simplicity making it an attractive option for builders and homeowners alike. The home's traditional facade has a light craftsman touch with tapered columns on the covered front porch, and the gabled roof line will help this home stand out in any neighborhood. The plan features open living spaces, split-load garage, and spacious secondary bedrooms. The over-sized Master Suite has 10' ceilings and a generous walk-in closet and sauna-like tile shower. Homeowners will love to show off their great room with 13' ceilings and covered patio that can be enjoyed on warm summer evenings.