

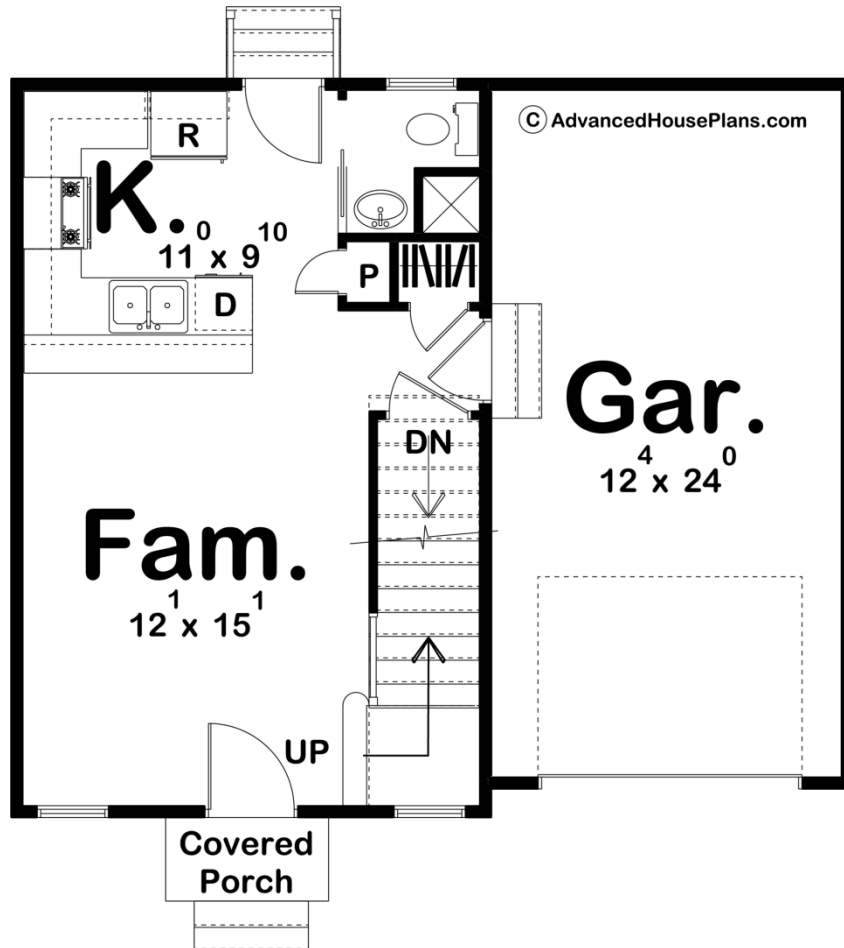

29704 - Naughton Data Sheet

| | | | | | |
|--------------|-----------|------------|-----------|----------------|----------------|
| 932 SQ FT | 2 BEDS | 2 BATHS | 1 BAYS | 29' 4" WIDE | 28' 8" DEEP |
|--------------|-----------|------------|-----------|----------------|----------------|

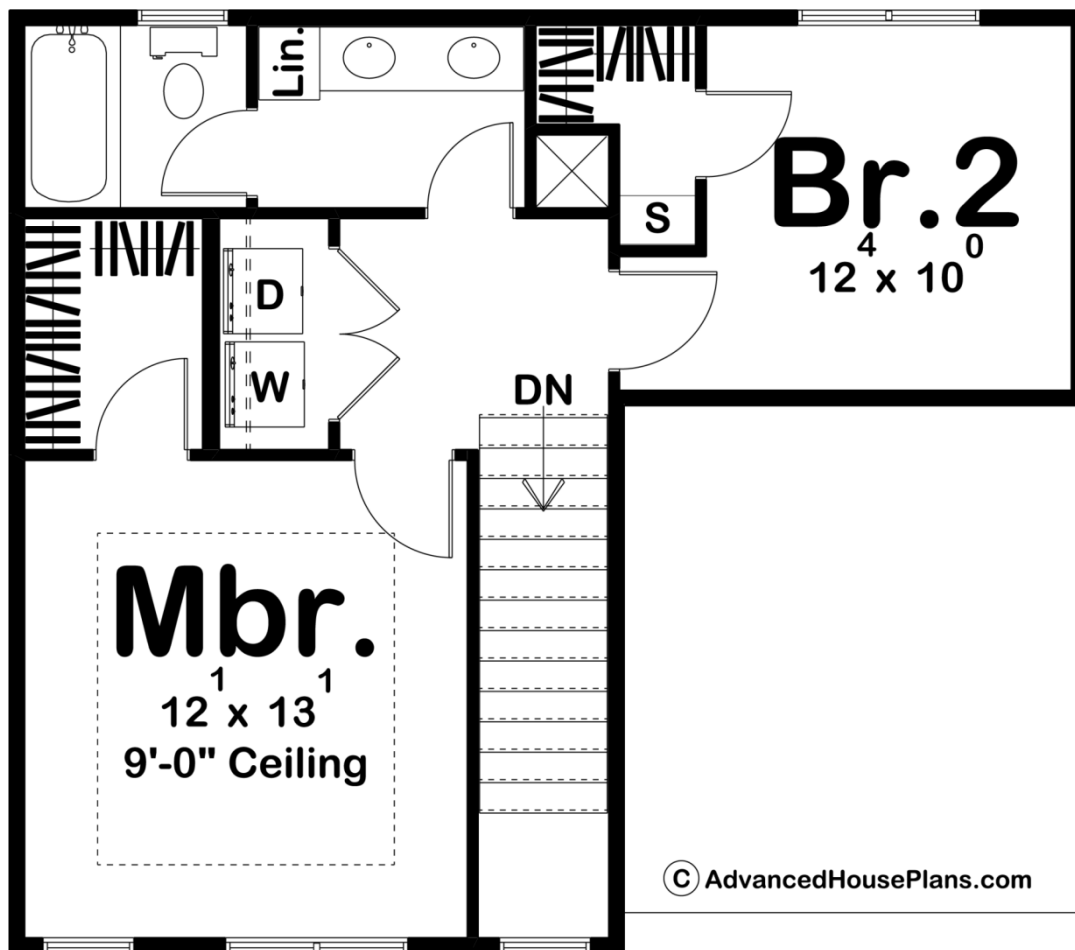



Construction Specs

Layout

| | |
|-------------|---|
| Bedrooms | 2 |
| Bathrooms | 2 |
| Garage Bays | 1 |

Square Footage

| | |
|---------------------|-------------|
| Main Level | 424 Sq. Ft. |
| Second Level | 508 Sq. Ft. |
| Garage | 312 Sq. Ft. |
| Total Finished Area | 932 Sq. Ft. |

Exterior Dimensions

| | |
|-------|--------|
| Width | 29' 4" |
| Depth | 28' 8" |

Default Construction Stats

Stats are unique to the individual plan.

| | |
|-----------------|----------|
| Foundation Type | Basement |
|-----------------|----------|

| | |
|----------------------------|--------------|
| Exterior Wall Construction | 2x4 |
| Roof Pitches | 8/12 Primary |
| Foundation Wall Height | 9' |
| Main Wall Height | 9' |
| Second Wall Height | 8' |

Plan Description

Perfect for narrow lots, this 30-foot-wide house plan is super efficient. Inside, guests are immediately greeted by the family room. The main floor includes a coat closet and a powder bath. The kitchen features a breakfast bar, pantry, and practical counter space. Upstairs, the master bedroom features a sizeable walk-in closet. A wall separates its bath area from the centrally located laundry. Just off the second-floor landing, the bedrooms share a hall bath. Check out our other small house plans!