

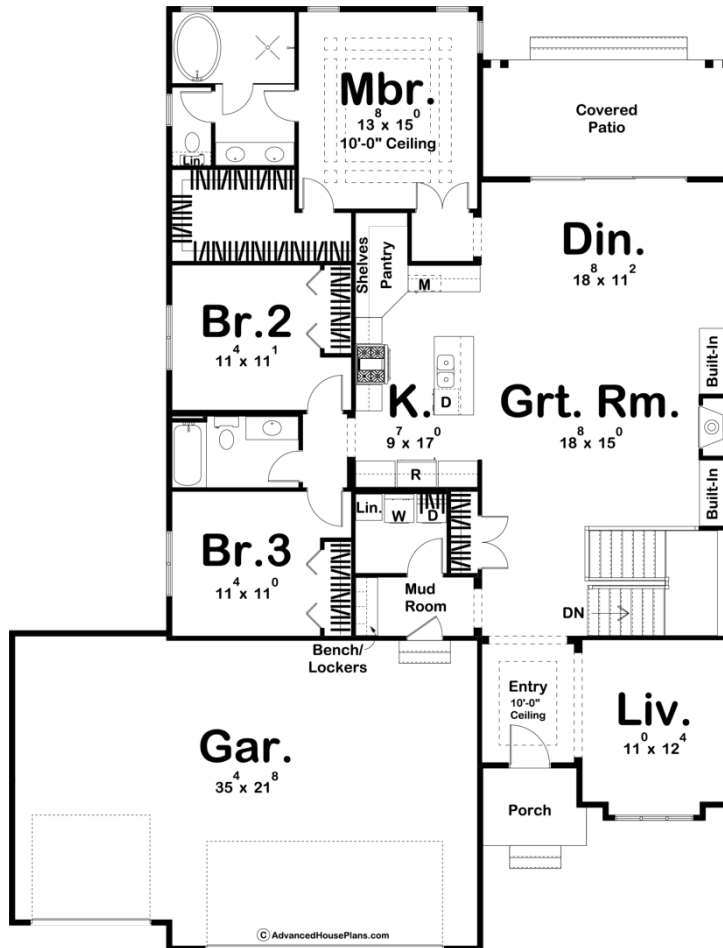

29938 - Naperville Data Sheet

2061 SQ FT	3 BEDS	2 BATHS	3 BAYS	55' 0" WIDE	72' 0" DEEP
---------------	-----------	------------	-----------	----------------	----------------



Construction Specs

Layout

Bedrooms

Bathrooms	2
Garage Bays	3

Square Footage

Main Level	2061 Sq. Ft.
Covered Area	171 Sq. Ft.
Garage	833 Sq. Ft.
Total Finished Area	2061 Sq. Ft.

Exterior Dimensions

Width	55' 0"
Depth	72' 0"

Default Construction Stats

Stats are unique to the individual plan.

Foundation Type	Basement
Exterior Wall Construction	2x4
Roof Pitches	10/12 Primary
Foundation Wall Height	9'
Main Wall Height	9'

Plan Description

Featuring a beautiful modern farmhouse exterior facade, the Naperville is a charming 1 story house plan with a great floor plan to match! The front of the house shows fantastic curb appeal with its porch and contrasting siding materials and colors. The Naperville features an open floor plan that feels huge! It's got a deep walk-in pantry, hidden by cabinet-faced doors and bench and locker storage in the mudroom to keep your belongings organized. The great room is warmed by a fireplace that is flanked by built-in bookshelves. At the rear of the home, the master suite is generously sized with a shower and spa room and a spacious walk-in closet. Located on the left side of the home, bedrooms 2 and 3 share a centrally located hall bathroom.