

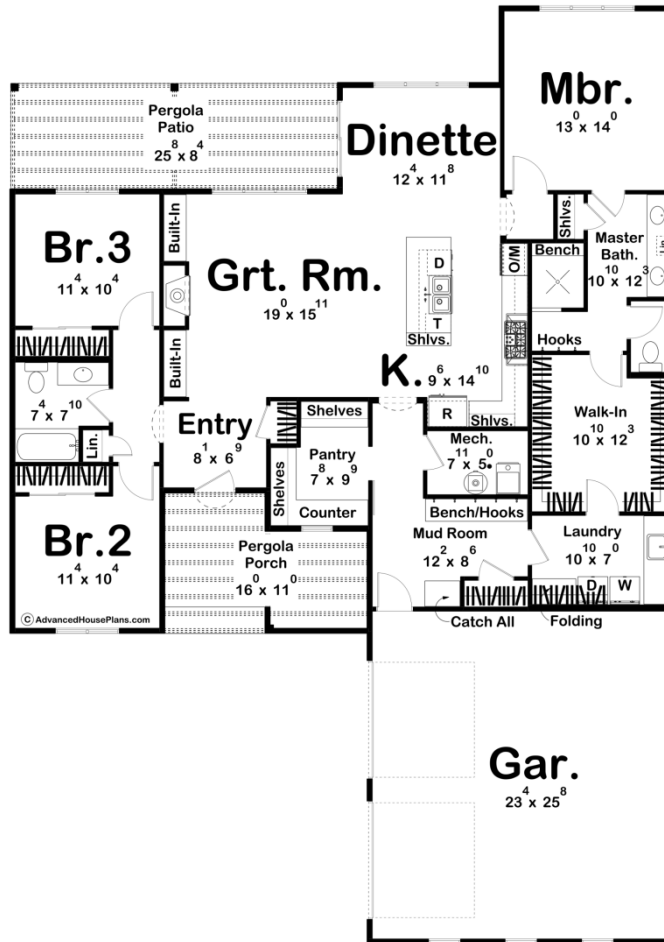

30364 - Moreno Valley Data Sheet

1873 SQ FT	3 BEDS	2 BATHS	2 BAYS	52' 0" WIDE	73' 4" DEEP
---------------	-----------	------------	-----------	----------------	----------------



Construction Specs

Layout

Bedrooms

Bathrooms	2
Garage Bays	2
Square Footage	
Main Level	1873 Sq. Ft.
Covered Area	352 Sq. Ft.
Garage	624 Sq. Ft.
Total Finished Area	1873 Sq. Ft.
Exterior Dimensions	
Width	52' 0"
Depth	73' 4"
Default Construction Stats <i>Stats are unique to the individual plan.</i>	
Foundation Type	Slab
Exterior Wall Construction	2x4
Roof Pitches	Flat
Main Wall Height	10'

Plan Description

Introducing this elegant house plan, a captivating blend of Spanish and Adobe architectural styles that effortlessly marries tradition with modern functionality. This distinctive house plan embraces the timeless appeal of a parapet flat roof, while its thoughtful layout and well-appointed features cater to contemporary living needs. Spanning across one level, this plan boasts 3 bedrooms and 2 bathrooms, ensuring ample space for relaxation and rejuvenation. The heart of the home is a harmonious convergence of the kitchen, dining area, and great room, creating an inviting open concept that fosters connection and shared experiences among family and friends. Natural light cascades through carefully placed windows, casting a warm ambiance upon the interconnected spaces. A true sanctuary, the master suite is thoughtfully positioned for privacy. Its ensuite bathroom exudes luxury and convenience, seamlessly flowing into an expansive walk-in closet, cleverly connecting to the adjacent laundry room – a practical design that enhances everyday ease. For added versatility, the secondary bedrooms share a well-appointed hall bathroom, catering to the needs of both family members and guests. The careful consideration of space extends outdoors, where two pergola porches – one at the front, inviting a charming welcome, and the other at the rear, providing an idyllic setting for outdoor relaxation and entertainment. Reflecting a touch of old-world charm, the garage is a courtyard load, enhancing the overall aesthetic while maintaining functionality. The courtyard design creates a sense of exclusivity and tranquility within the property. With its alluring synthesis of Spanish and Adobe elements, this house plan is a testament to the art of architectural fusion and a canvas upon which a modern, stylish, and comfortable lifestyle can be effortlessly painted. This is a residence that captures the essence of past and present, delivering a truly unique living experience for those who appreciate the beauty of both.