

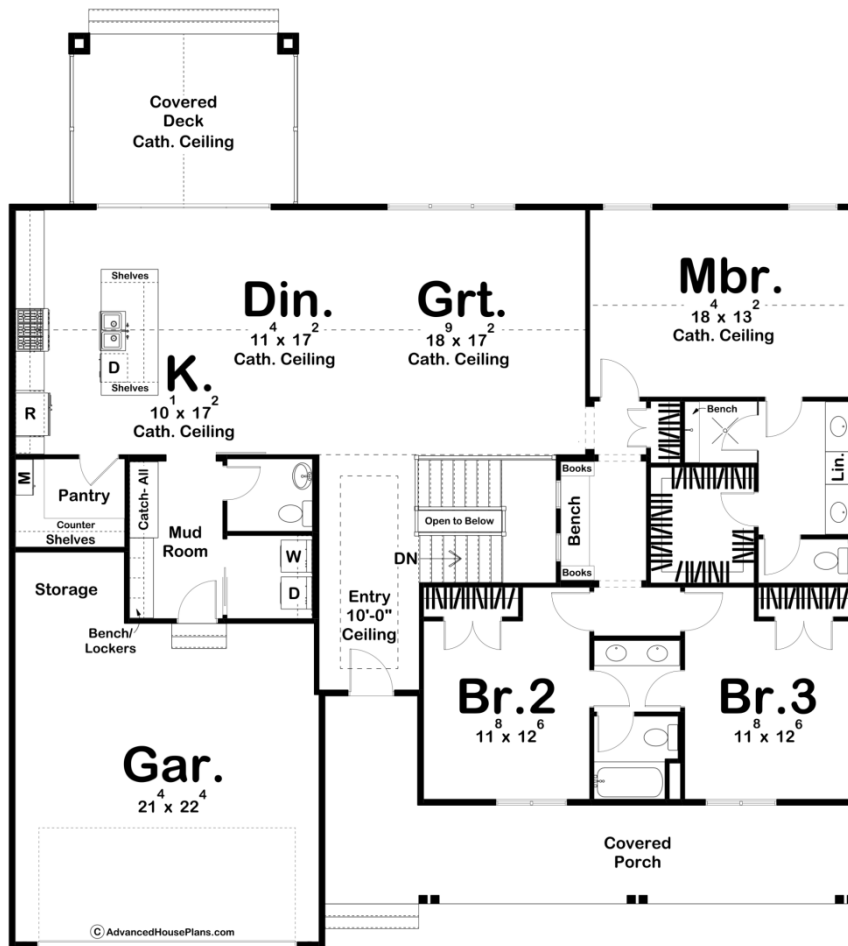

30305 - Minderman Data Sheet

2126 SQ FT	3 BEDS	3 BATHS	2 BAYS	59' 4" WIDE	64' 0" DEEP
---------------	-----------	------------	-----------	----------------	----------------



Construction Specs

Layout

Bedrooms

Bathrooms	3
Garage Bays	2

Square Footage

Main Level	2126 Sq. Ft.
Covered Area	504 Sq. Ft.
Garage	540 Sq. Ft.
Total Finished Area	2126 Sq. Ft.

Exterior Dimensions

Width	59' 4"
Depth	64' 0"
Ridge Height <i>Calculated from main floor line</i>	23' 10"

Default Construction Stats

Stats are unique to the individual plan.

Foundation Type	Basement
Exterior Wall Construction	2x4
Roof Pitches	Primary 8/12, Secondary 10/12, 4/12
Foundation Wall Height	9'
Main Wall Height	9'

Plan Description

The Minderman's deep, covered entry opens to an expansive cathedral-ceiling great room and dining area with wide open views out of the back of the home. The kitchen, resting off to one side, extends this gathering area, with a large island, walk-in pantry and an ever-practical mud room, complete with bench and lockers. Sleeping rooms maintain their privacy from the living areas. The master suite's bath includes a compartmented toilet, walk-in shower and his/hers vanities. The secondary bedrooms share a jack-and-jill bath with a double vanity. A fun library area separates the master bedroom from the others. On the outside, a large covered porch enhances the home's immediate sense of warmth and hospitality. Balancing this comfortable outdoor space at the rear of the home, is a roomy covered deck, perfect for entertaining guests, rain or shine.