

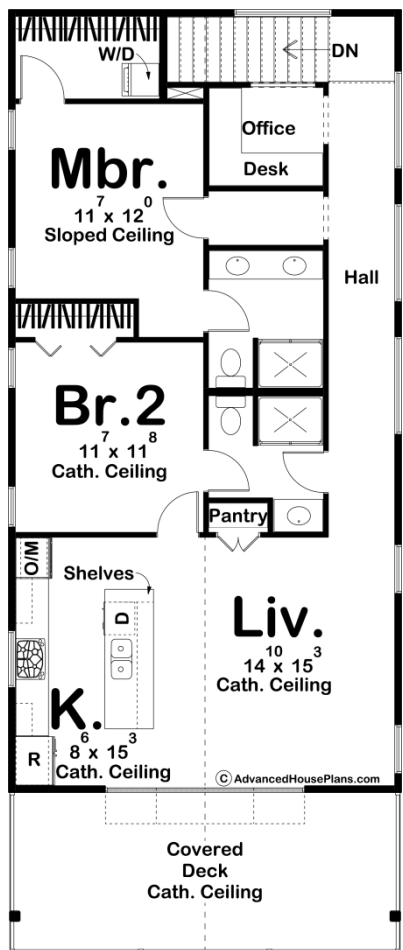

29825 - Millard Heights Data Sheet

1318 SQ FT	2 BEDS	2 BATHS	2 BAYS	24' 0" WIDE	58' 0" DEEP
---------------	-----------	------------	-----------	----------------	----------------





Construction Specs

Layout	
Bedrooms	2
Bathrooms	2
Garage Bays	2
Square Footage	
Main Level	223 Sq. Ft.
Second Level	1095 Sq. Ft.
Garage	929 Sq. Ft.
Total Finished Area	1318 Sq. Ft.
Exterior Dimensions	
Width	24' 0"
Depth	58' 0"
Default Construction Stats	
<i>Stats are unique to the individual plan.</i>	
Foundation Type	Slab

Exterior Wall Construction	2x4
Roof Pitches	6/12 Primary
Main Wall Height	9'
Second Wall Height	8'

Plan Description

If you are looking for a carriage house that will give you a unique blend of textures, look no further than the Millard Heights plan. A mixture of stone, siding, and wood gives this garage a modern rustic feel. On the main level, you find a 2 car garage that includes a workshop with a built-in workbench. Upstairs you'll find a wonderfully efficient 2 bedroom apartment. The apartments open floor plan makes great use of the space. The kitchen includes a pantry and a large island with a snack bar. The master bedroom has its own bathroom while the second bedroom and the main living space share a convenient bathroom.