

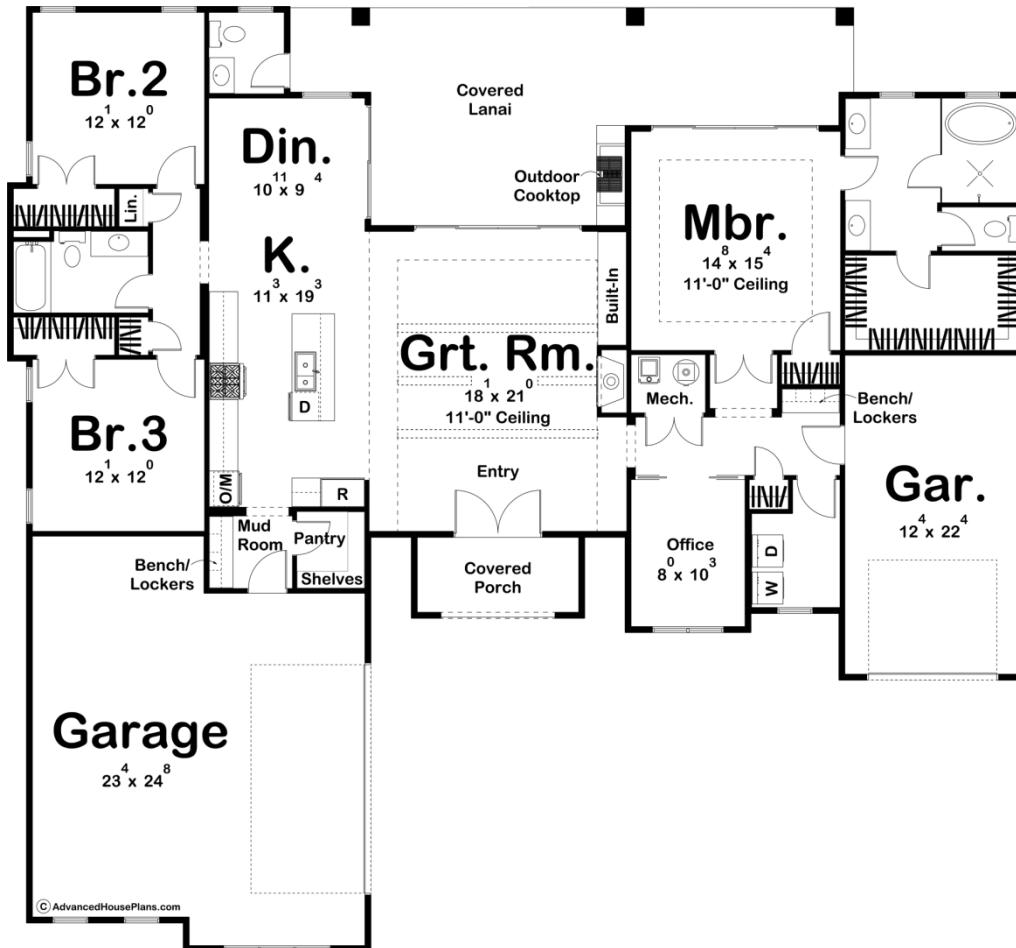

29866 - Melbourne Data Sheet

2073 SQ FT	3 BEDS	3 BATHS	3 BAYS	71' 4" WIDE	66' 0" DEEP
---------------	-----------	------------	-----------	----------------	----------------



Construction Specs

Layout

Bedrooms

Bathrooms	3
Garage Bays	3

Square Footage

Main Level	2073 Sq. Ft.
Garage	921 Sq. Ft.
Total Finished Area	2073 Sq. Ft.

Exterior Dimensions

Width	71' 4"
Depth	66' 0"

Default Construction Stats

Stats are unique to the individual plan.

Foundation Type	Slab
Exterior Wall Construction	2x4
Roof Pitches	6/12 Primary
Main Wall Height	10'

Plan Description

Melbourne is an elegant Mediterranean style 1 story home. The exterior is highlighted by white stucco and contrasting black clay tile roof. An arched entry and wood garage doors finish off the Mediterranean curb appeal. Upon entry to the home, you'll step into the large great room that lies under a high trayed ceiling and is warmed by a fireplace with built-in bookshelves. The great room flows seamlessly with the kitchen and dining room in a wide-open layout. The kitchen includes a large island and a walk-in pantry. On the right side of the home, you'll find a large master suite that includes his/her vanities, a wet room, an enclosed toilet, and a walk-in shower. Just outside the master, a convenient office is a perfect place to work from home. On the opposite side of the home, 2 bedrooms share a conveniently located hall bathroom. Attached to the rear of the home, your outdoor entertainment will be taken to the next level with a large covered lanai that features an outdoor cooktop and its own bathroom.