

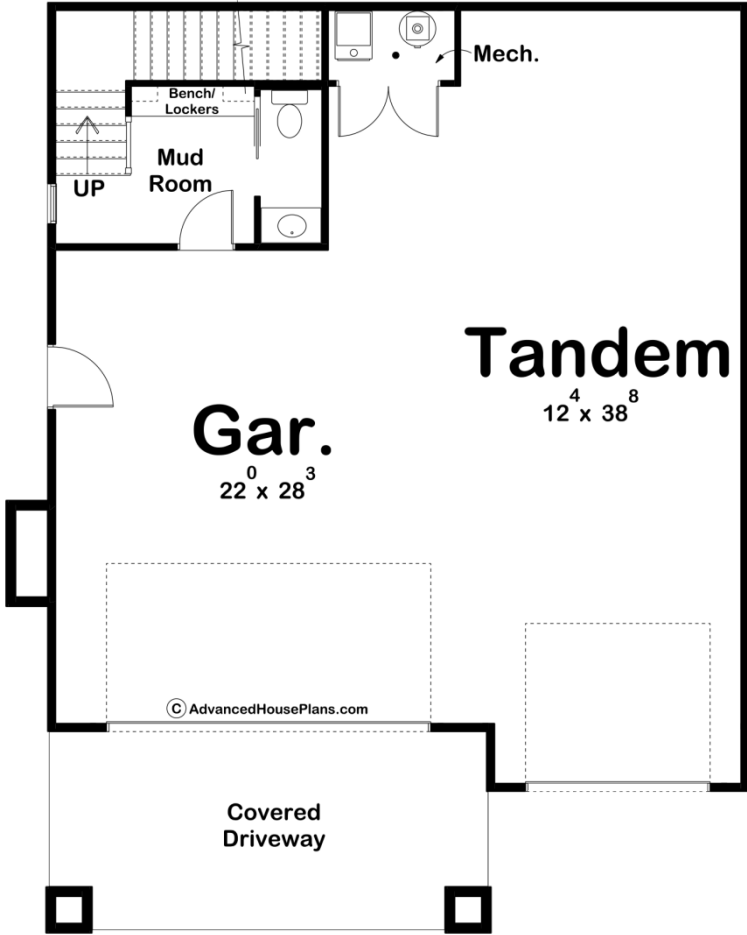

30204 - Meadow Lane Data Sheet

1453 SQ FT	2 BEDS	2 BATHS	3 BAYS	37' 0" WIDE	46' 4" DEEP
---------------	-----------	------------	-----------	----------------	----------------

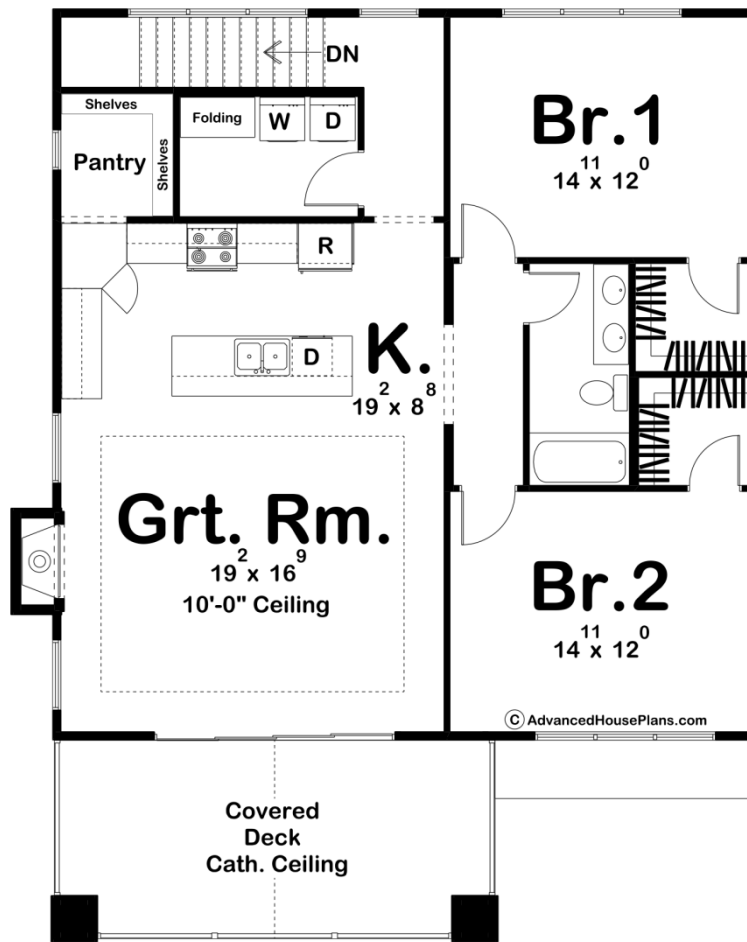



## Construction Specs

### Layout

Bedrooms	2
Bathrooms	2
Garage Bays	3

### Square Footage

Main Level	169 Sq. Ft.
Second Level	1284 Sq. Ft.
Covered Area	219 Sq. Ft.
Garage	1142 Sq. Ft.
Total Finished Area	1453 Sq. Ft.

### Exterior Dimensions

Width	37' 0"
Depth	46' 4"
Ridge Height	33' 2"
<i>Calculated from main floor line</i>	

## Default Construction Stats

*Stats are unique to the individual plan.*

Foundation Type	Slab
Exterior Wall Construction	2x4
Roof Pitches	Primary 10/12, Secondary 8/12, 4/12
Main Wall Height	10'
Second Wall Height	9'

## Plan Description

The Meadow Lane is a stunning apartment garage that features 2 bedrooms above a 3 car garage. On the main level there is a mudroom equipped with bench & lockers and a half bath. There is extra storage space in the rear of the single car stall. Upstairs, a well-thought out apartment includes 2 bedrooms with walk-in closets and a shared hall bath. The open concept flows from the full kitchen with a walk-in pantry to the large great room that houses a fireplace and tray ceiling. Off the great room is a large slider door that opens to a covered deck with cathedral ceiling.