

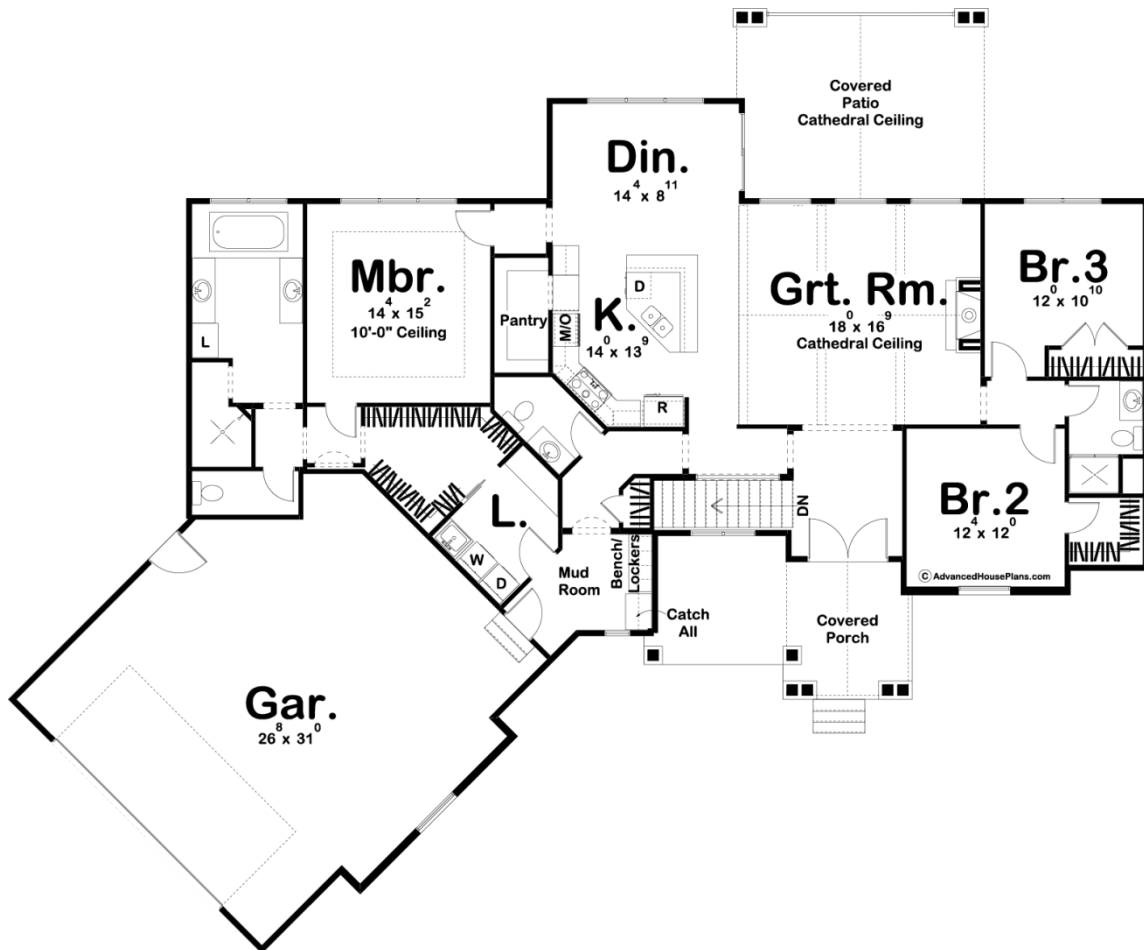

29687 - Marietta Data Sheet

2215 SQ FT	3 BEDS	3 BATHS	2 BAYS	88' 0" WIDE	73' 0" DEEP
---------------	-----------	------------	-----------	----------------	----------------



Construction Specs

Layout

Bedrooms

Bathrooms	3
Garage Bays	2

Square Footage

Main Level	2215 Sq. Ft.
Total Finished Area	2215 Sq. Ft.

Exterior Dimensions

Width	88' 0"
Depth	73' 0"

Default Construction Stats

Stats are unique to the individual plan.

Foundation Type	Basement
Exterior Wall Construction	2x4
Roof Pitches	10/12 Primary
Foundation Wall Height	9'
Main Wall Height	9'

Plan Description

Modern Mountain styling and an angled footprint contribute to this 1-story house plan's outstanding curb appeal. Double doors within a deep covered front porch opens to the great room residing beneath a cathedral ceiling with wood beams and showcasing a fireplace with thinset stone veneer. This home plans kitchen and dining area openly interact with the great room for easy entertaining. The kitchen features a large island work area and a roomy walk-in pantry. Entertaining options are expanded by the adjacent dining area, which accesses to a rear patio. Just off the kitchen, a mudroom with built-in bench and lockers accesses the home's angled 2-car garage. The master suite has access to a well-appointed bath area that includes dual sinks, soaking tub, walk-in shower, compartmented toilet and a roomy walk-in closet that has access to the laundry room. On the opposite side of the home, two secondary bedrooms share a hall bath and bedroom 2 includes a walk-in closet. As always any Advanced House Plans home plan can be customized to fit your needs with our alteration department. Whether you need to add another garage stall, change the front elevation, stretch the home larger or just make the home plan more affordable for your budget we can do that and more for you at Ahp.