

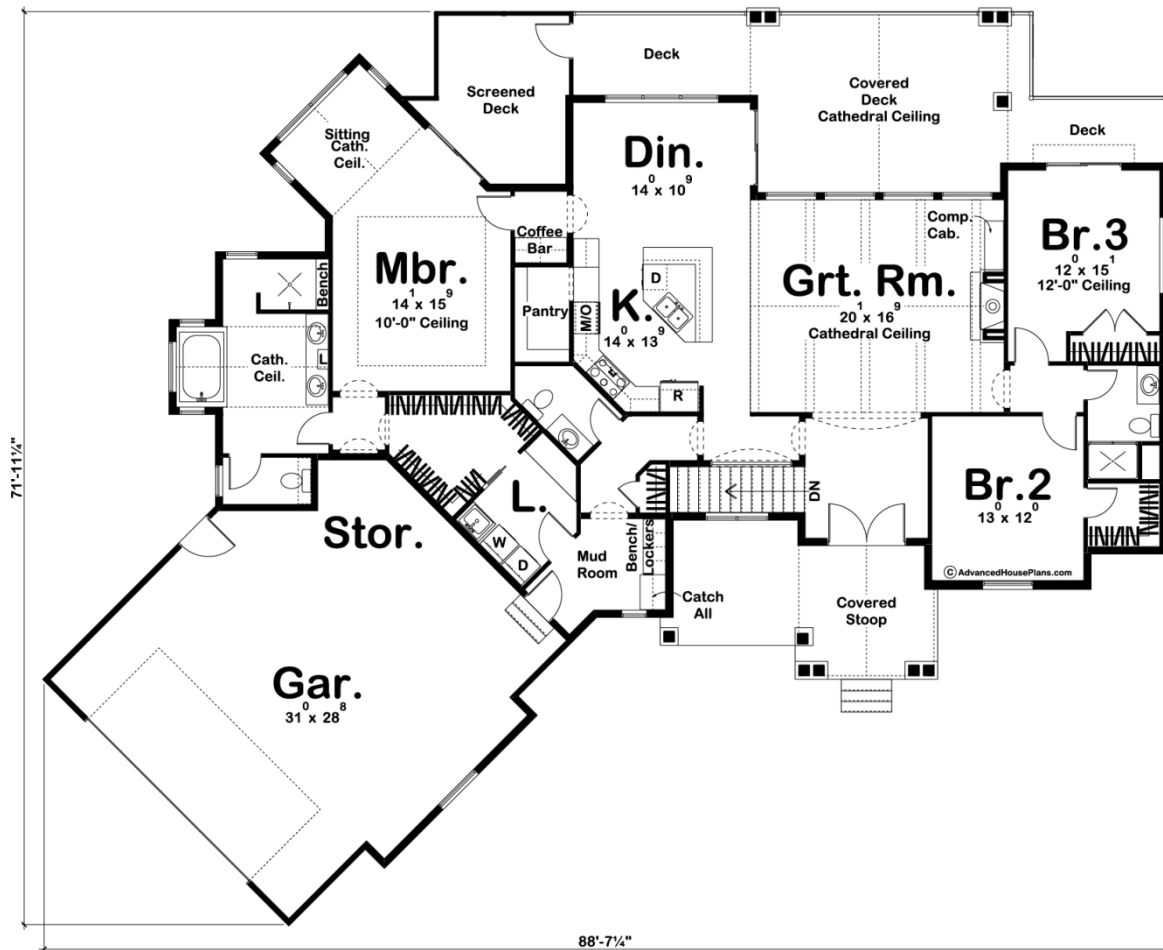

29513 - Manchester Data Sheet

2349 SQ FT	3 BEDS	3 BATHS	2 BAYS	88' 7" WIDE	71' 11" DEEP
---------------	-----------	------------	-----------	----------------	-----------------



Construction Specs

Layout

Bedrooms

Bathrooms	3
Garage Bays	2
Square Footage	
Main Level	2349 Sq. Ft.
Garage	841 Sq. Ft.
Total Finished Area	2349 Sq. Ft.
Exterior Dimensions	
Width	88' 7"
Depth	71' 11"
Ridge Height <i>Calculated from main floor line</i>	30'
Default Construction Stats <i>Stats are unique to the individual plan.</i>	
Foundation Type	Basement
Exterior Wall Construction	2x4
Roof Pitches	10/12
Foundation Wall Height	9'
Main Wall Height	9'

Plan Description

Craftsman styling and an angled footprint contribute to this 1-story house plan's outstanding curb appeal. Double doors within a deep covered front porch opens to the great room residing beneath a cathedral ceiling with wood beams and showcasing a fireplace with thinset stone veneer. This home plans kitchen and dining area openly interact with the great room for easy entertaining. The kitchen features a large island work area and a roomy walk-in pantry. Entertaining options are expanded by the adjacent dining area, which accesses to a rear patio. Just off the kitchen, a mudroom with built-in bench, lockers, and catch-all access the home's angled 2-car garage. Additional space in the garage awaits use as a work area or for storage. Also, behind the kitchen is a conveniently located coffee bar as you enter the master suite. The master features a sitting room with a private door to a screened-in porch. The master bath has access to a well-appointed bath area that includes dual sinks, soaking tub, walk-in shower, compartmented toilet, and roomy walk-in closet. On the opposite side of the home, two secondary bedrooms with a hall bath and walk-in closet.