

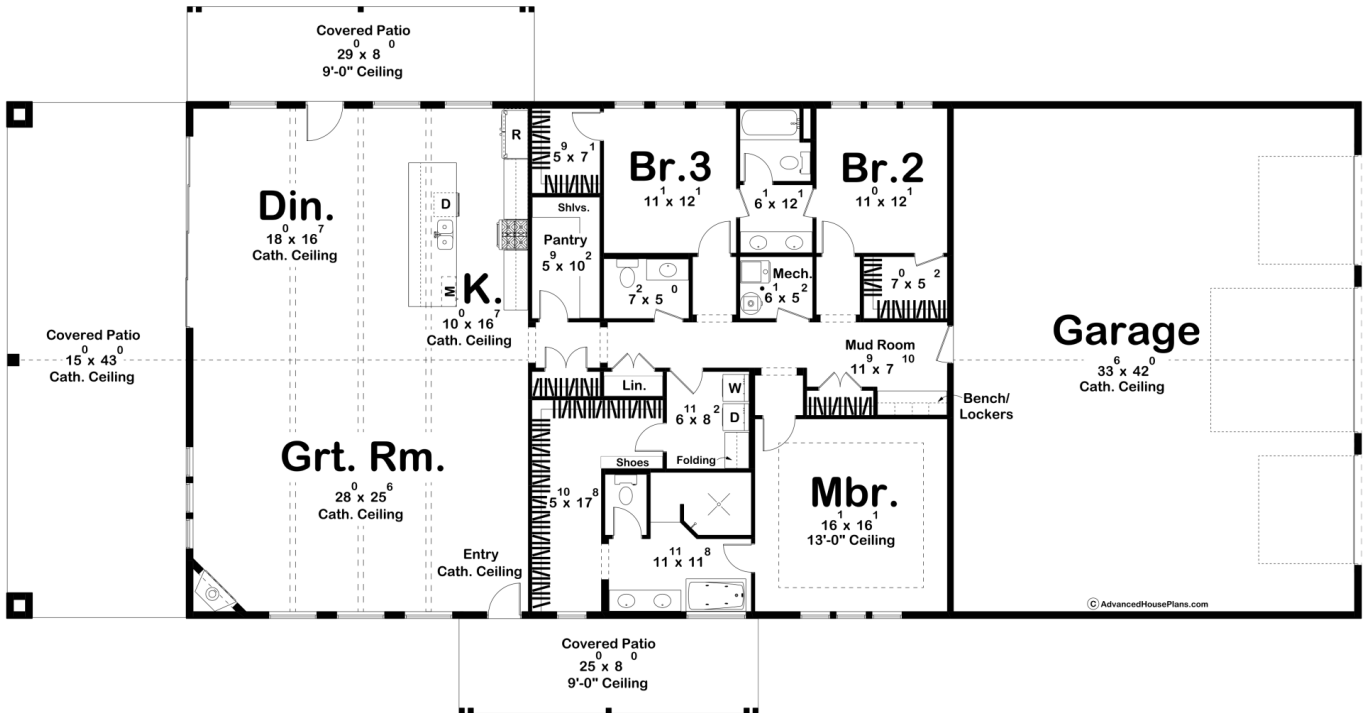

**30440 - Limestone Data Sheet**

2722 SQ FT	3 BEDS	3 BATHS	3 BAYS	113' 0" WIDE	59' 0" DEEP
---------------	-----------	------------	-----------	-----------------	----------------



**Construction Specs**

Layout

Bedrooms

Bathrooms	3
Garage Bays	3
<b>Square Footage</b>	
Main Level	2722 Sq. Ft.
Covered Area	1077 Sq. Ft.
Garage	1462 Sq. Ft.
Total Finished Area	2722 Sq. Ft.
<b>Exterior Dimensions</b>	
Width	113' 0"
Depth	59' 0"
Ridge Height <i>Calculated from main floor line</i>	24' 6"
<b>Default Construction Stats</b> <i>Stats are unique to the individual plan.</i>	
Foundation Type	Slab
Exterior Wall Construction	2x6
Roof Pitches	Primary 6/12, Flat
Main Wall Height	12'

## Plan Description

Introducing the Barndominium Style House Plan: Limestone. This single-story modern house plan is a harmonious blend of rustic charm and contemporary elegance. Its exterior showcases a dark exterior with minimal wood accents creating a sleek facade. The focal point of this barndominium is its expansive three-car garage, providing ample space for vehicles, storage, and even a workshop. An open floor plan unfolds into a spacious living area where the boundaries between indoors and outdoors blur. Large windows and glass doors flood the interior with natural light, offering breathtaking views of the landscape. Step outside onto multiple covered patios, where the fusion of dark metal and warm wood continues. An outdoor living space, complete with comfortable seating, beckons for relaxation and entertainment, making it the perfect spot to enjoy the serene evenings. This modern barndominium is a testament to the marriage of contemporary design and rustic charm, providing a luxurious and comfortable retreat that embraces the beauty of its natural surroundings while offering the convenience of a three-car garage and an open, seamless living space.