

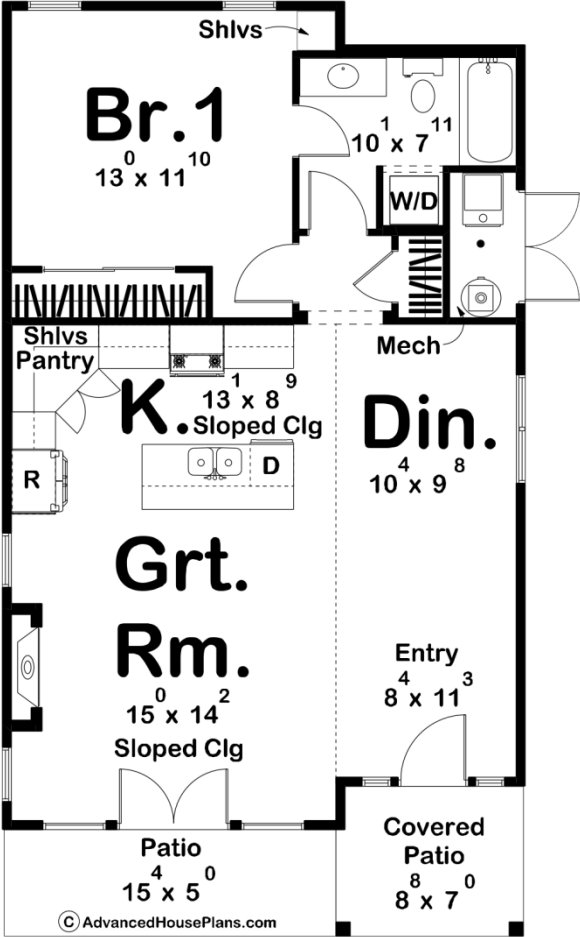

30560 - Laporte Data Sheet

858 SQ FT	1 BEDS	1 BATHS	0 BAYS	24' 0" WIDE	43' 0" DEEP
--------------	-----------	------------	-----------	----------------	----------------



Construction Specs

Layout

Bedrooms

Bathrooms 1

Square Footage

Main Level	858 Sq. Ft.
Covered Area	60 Sq. Ft.
Total Finished Area	858 Sq. Ft.

Exterior Dimensions

Width	24' 0"
Depth	43' 0"
Ridge Height <i>Calculated from main floor line</i>	15' 4"

Default Construction Stats

Stats are unique to the individual plan.

Foundation Type	Slab
Exterior Wall Construction	2x4
Roof Pitches	4/12
Main Wall Height	9'

Plan Description

Our modern style ADU plan, Laporte, offers a contemporary living experience that's both stylish and functional. With its open concept main area, you'll enjoy a spacious layout that seamlessly integrates the living, dining, and kitchen areas, perfect for hosting gatherings or simply relaxing in style. The sloped ceilings add a touch of architectural elegance, creating a sense of openness and airiness. Imagine cozying up by the electric fireplace on chilly evenings, adding warmth and ambiance to your space. The bedroom and bathroom, conveniently located off the main area, provide comfort and privacy, making it an ideal retreat at the end of the day. Whether you're looking for a modern guest house, a comfortable space for aging parents, or a stylish rental unit, Laporte offers the perfect blend of contemporary design and practicality to meet your needs. Don't miss out on the opportunity to make Laporte your own modern oasis!