

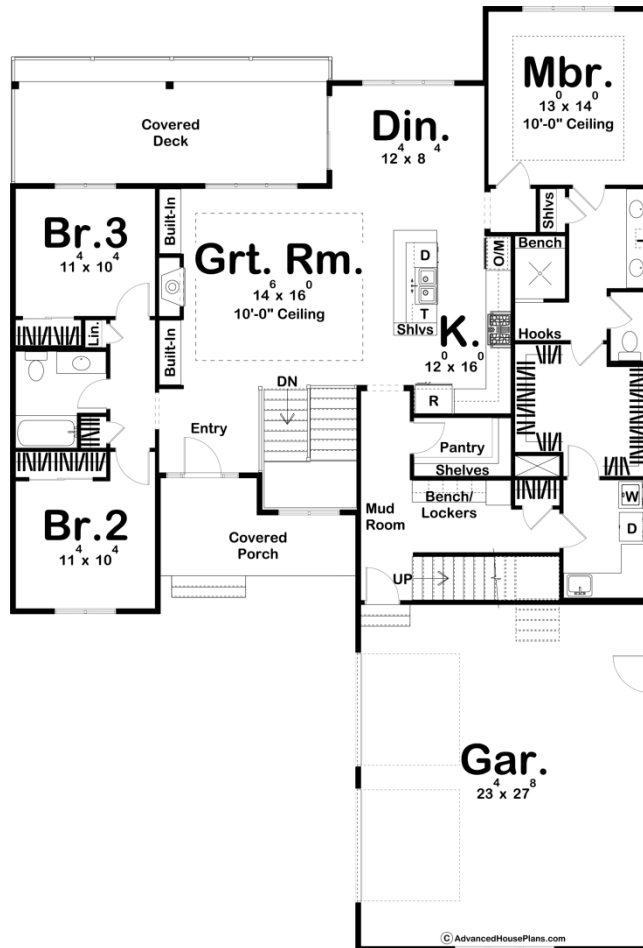

**29885 - Lakeland Data Sheet**

1936 SQ FT	3 BEDS	2 BATHS	2 BAYS	52' 0" WIDE	76' 4" DEEP
---------------	-----------	------------	-----------	----------------	----------------

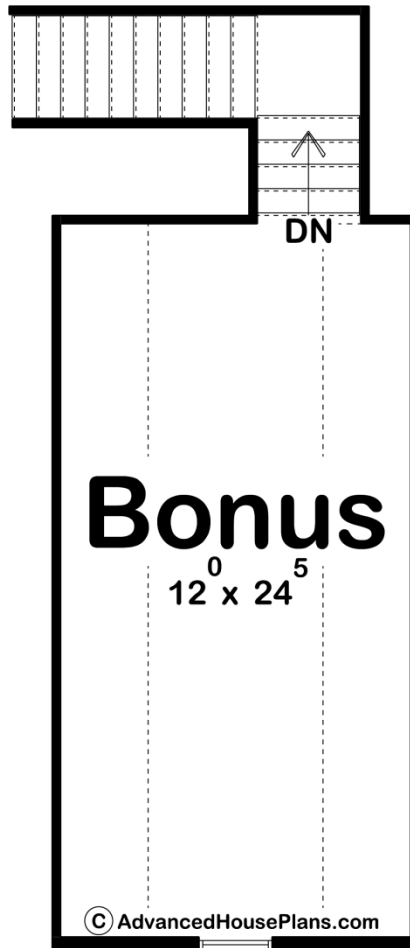



## Construction Specs

### Layout

Bedrooms	3
Bathrooms	2
Garage Bays	2

### Square Footage

Main Level	1936 Sq. Ft.
Garage	672 Sq. Ft.
Total Finished Area	1936 Sq. Ft.

### Exterior Dimensions

Width	52' 0"
Depth	76' 4"
Ridge Height <i>Calculated from main floor line</i>	22' 0"

### Default Construction Stats

*Stats are unique to the individual plan.*

Foundation Type	Basement
Exterior Wall Construction	2x4
Roof Pitches	8/12 Primary, 12/12 Secondary
Foundation Wall Height	9'
Main Wall Height	9'

## Plan Description

The Lakeland plan is a beautiful modern farmhouse plan. The exterior features board and batten siding with a courtyard garage. At just over 1900 square feet, this plan is a great size for any family. Just inside the home, you'll walk into a large great room that is warmed by a fireplace with built-in bookshelves. The kitchen flows seamlessly with the great room and dining room in an open layout. The kitchen includes a walk-in pantry and a large island with built-in shelves. The master suite includes his/her vanities, a walk-in shower and a large walk-in closet that accesses the laundry room. Bedrooms 2 and 3 share a centrally located hall bathroom. An optional bonus room above the garage adds 315 sq ft.