

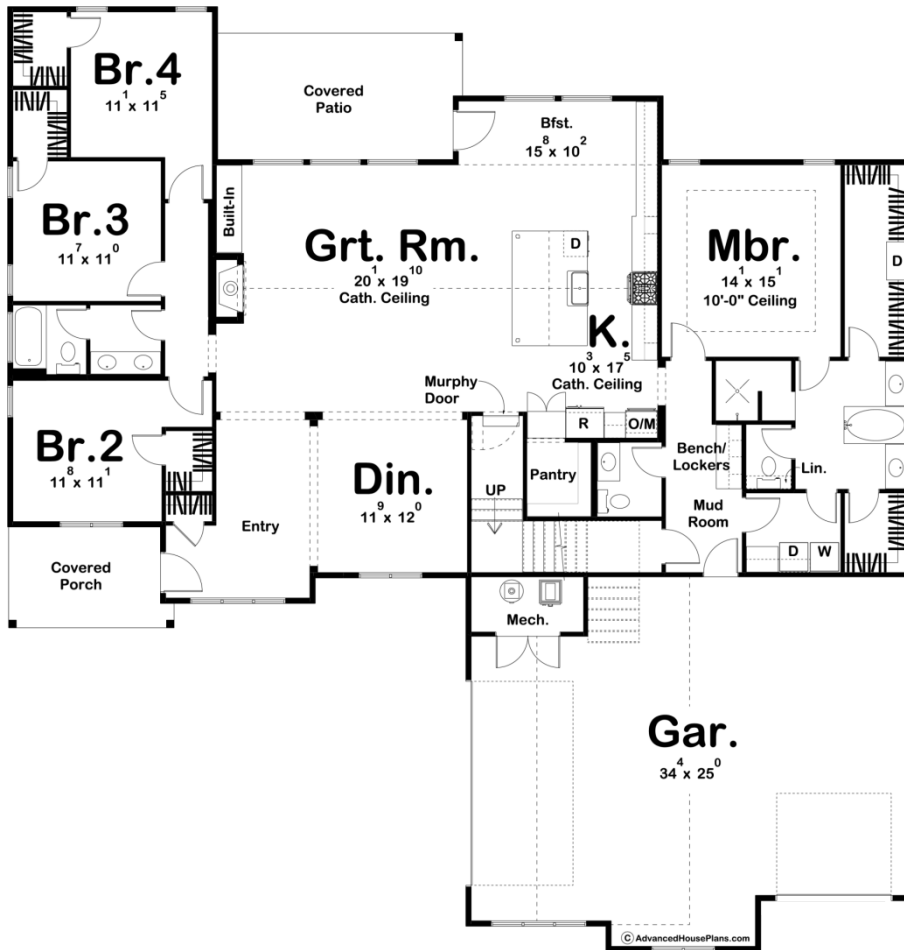

**29880 - Knoxville Data Sheet**

2572 SQ FT	4 BEDS	3 BATHS	3 BAYS	71' 0" WIDE	74' 0" DEEP
---------------	-----------	------------	-----------	----------------	----------------

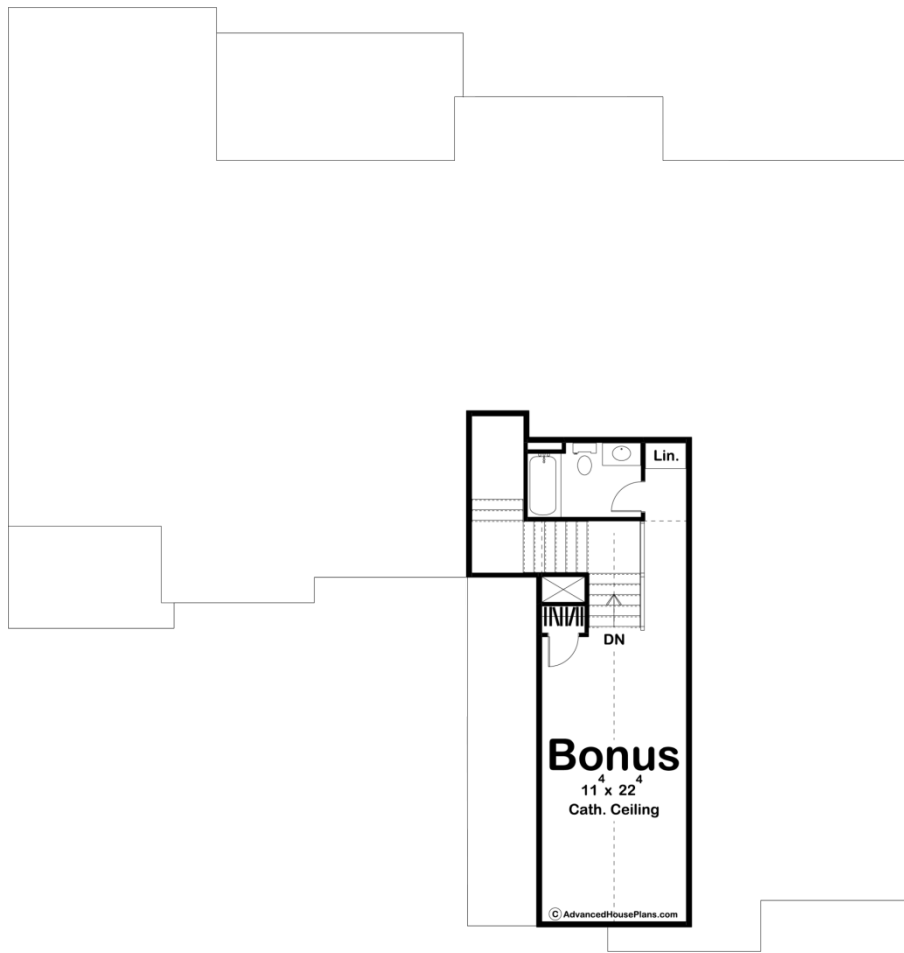



## Construction Specs

### Layout

Bedrooms	4
Bathrooms	3
Garage Bays	3

### Square Footage

Main Level	2572 Sq. Ft.
Garage	957 Sq. Ft.
Total Finished Area	2572 Sq. Ft.

### Exterior Dimensions

Width	71' 0"
Depth	74' 0"

### Default Construction Stats

*Stats are unique to the individual plan.*

Foundation Type	Crawlspace
Exterior Wall Construction	2x4

Roof Pitches	10/12 Primary, 6/12 4/12 Secondary
Main Wall Height	9'
Second Wall Height	8'

## Plan Description

This charming Modern Farmhouse plan has everything you need. The charming exterior textures of board and batten siding and wood accents give this home great curb appeal. Once you step inside the home, you will be blown away by the large great room that lies under a cathedral ceiling. Adjacent to the great room you will find the kitchen and dinette. The kitchen includes a walk-in pantry and a kitchen island with built-in seating. The master suite includes a large master bath with his/her vanities, a soaking tub, and a walk-in closet. The left side of the home features 3 bedrooms that share a conveniently located hall bathroom. All bedrooms have their own walk-in closet. A 3 car split load garage accesses the home through a convenient mudroom.