

**ADVANCED**  
HOUSE PLANS

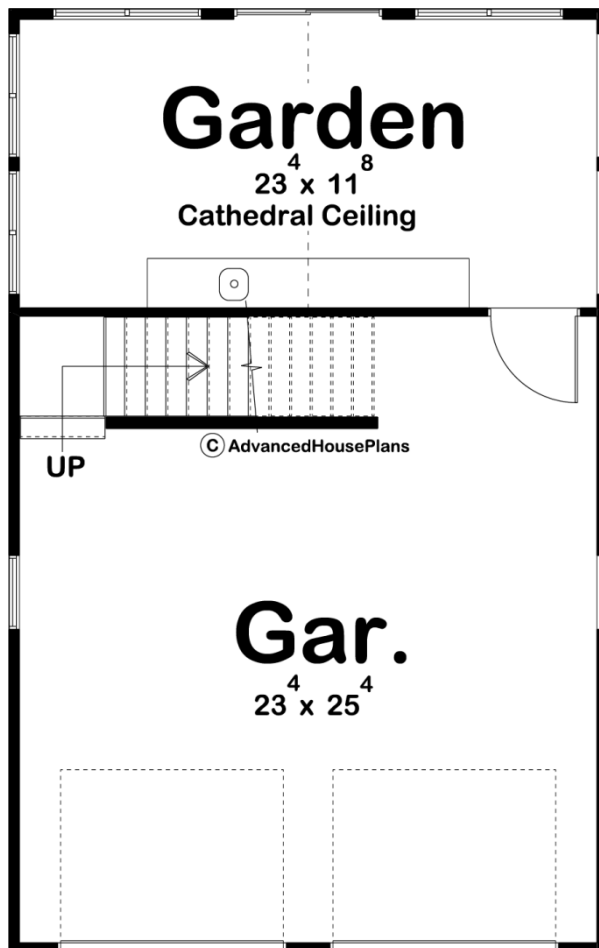

### 29376 - Kistler Data Sheet

730 SQ FT	0 BEDS	0 BATHS	2 BAYS	24' 0" WIDE	38' 0" DEEP
--------------	-----------	------------	-----------	----------------	----------------



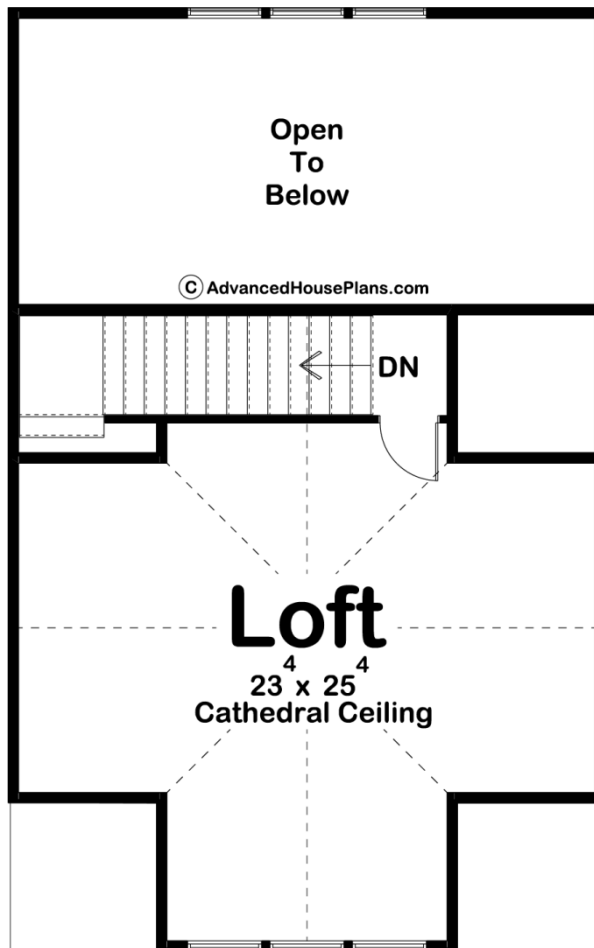

## Construction Specs

### Layout

Garage Bays 2

### Square Footage

Main Level 288 Sq. Ft.

Second Level 442 Sq. Ft.

Garage 624 Sq. Ft.

Total Finished Area 730 Sq. Ft.

### Exterior Dimensions

Width 24' 0"

Depth 38' 0"

### Default Construction Stats

*Stats are unique to the individual plan.*

Foundation Type Slab

Exterior Wall Construction 2x4

Roof Pitches 12/12 Primary

Main Wall Height	9'
Second Wall Height	6'

## Plan Description

Kistler is a 2-story traditional garage built on a slab foundation. There is an attic space above the garage and a 2-story garden room in the rear. The second story walls are built at 6' and the ceiling slopes up to approximately 10'. The garden room has windows on 3 sides and a large sliding patio door on the rear.