

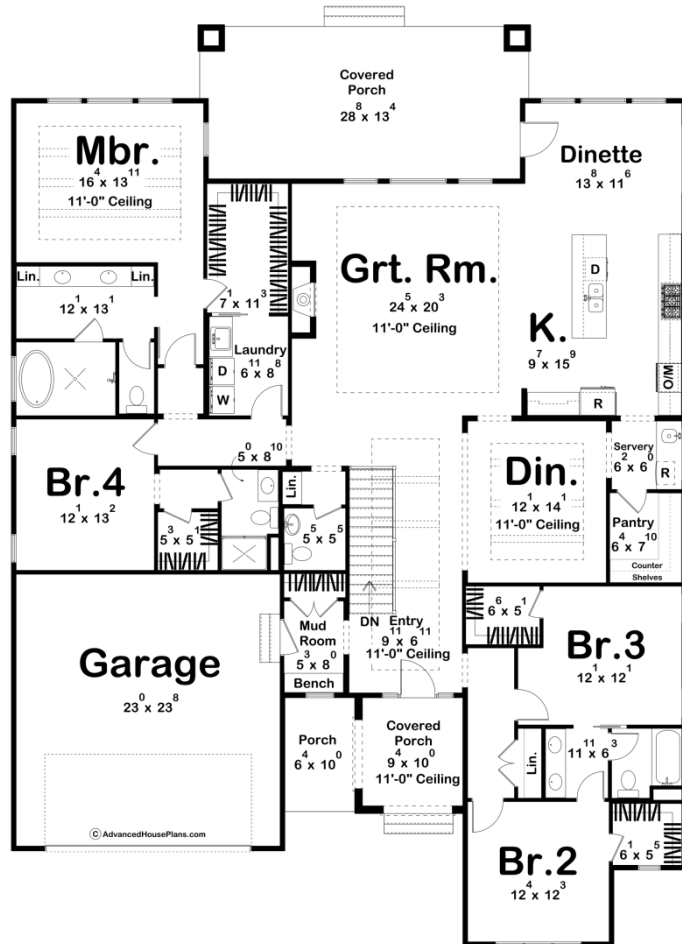

30521 - Kinsley Data Sheet

2987 SQ FT	4 BEDS	3 BATHS	2 BAYS	58' 8" WIDE	80' 0" DEEP
---------------	-----------	------------	-----------	----------------	----------------



Construction Specs

Layout

Bedrooms

Bathrooms	3
Garage Bays	2
Square Footage	
Main Level	2987 Sq. Ft.
Covered Area	436 Sq. Ft.
Garage	564 Sq. Ft.
Total Finished Area	2987 Sq. Ft.
Exterior Dimensions	
Width	58' 8"
Depth	80' 0"
Default Construction Stats	
<i>Stats are unique to the individual plan.</i>	
Foundation Type	Basement
Exterior Wall Construction	2x4
Roof Pitches	Primary 14/12, Secondary 6/12, 10/12, Flat
Foundation Wall Height	9'
Main Wall Height	9'

Plan Description

Introducing the Kinsley, a modern 1-story home that epitomizes modern elegance and comfort. The exterior showcases a sleek stucco finish with a flat roof over the front porch, setting a sophisticated tone from the moment you arrive. Inside, the Kinsley offers four bedrooms and three bathrooms, thoughtfully designed to provide ample space for family living and guests. The entryway welcomes you with a tray ceiling adorned with elegant beams, creating an immediate sense of luxury. The heart of the home is the great room, where a tray ceiling and cozy fireplace create a warm and inviting atmosphere, perfect for both relaxation and entertaining. Large windows allow natural light to flood the space, enhancing the home's open and airy feel. Step outside to the large covered porch in the back, an ideal spot for outdoor dining or simply unwinding while enjoying the view. The Kinsley combines modern design with practical functionality, making it the perfect home for those who appreciate style and comfort.