

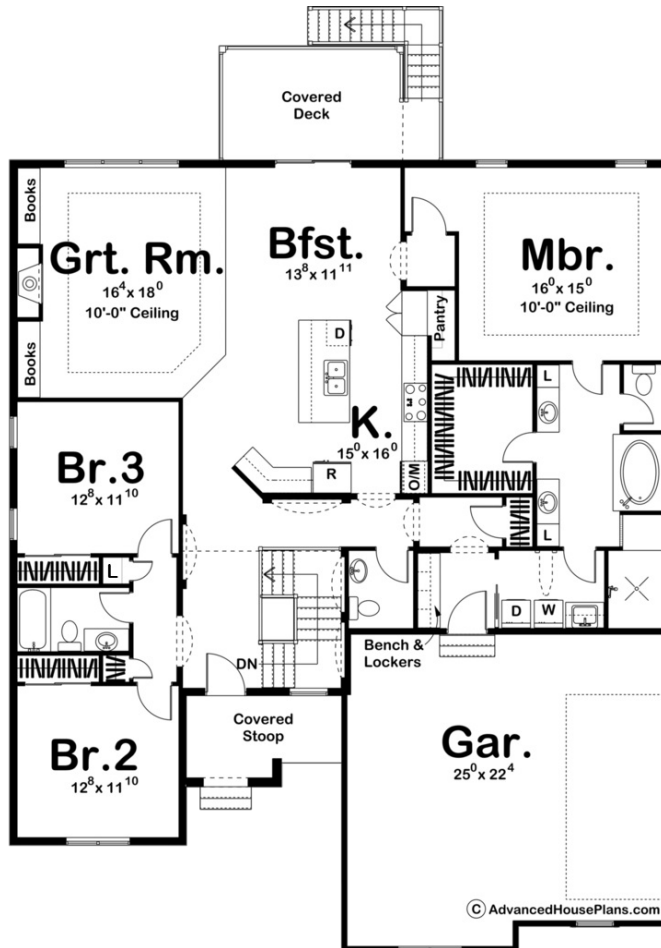

## 29318 - Katzberg Data Sheet

2195 SQ FT	3 BEDS	3 BATHS	2 BAYS	52' 0" WIDE	62' 0" DEEP
---------------	-----------	------------	-----------	----------------	----------------



## Construction Specs

Layout

Bedrooms

Bathrooms	3
-----------	---

Garage Bays	2
-------------	---

### Square Footage

Main Level	2195 Sq. Ft.
------------	--------------

Garage	607 Sq. Ft.
--------	-------------

Total Finished Area	2195 Sq. Ft.
---------------------	--------------

### Exterior Dimensions

Width	52' 0"
-------	--------

Depth	62' 0"
-------	--------

Ridge Height	24' 0"
--------------	--------

*Calculated from main floor line*

### Default Construction Stats

*Stats are unique to the individual plan.*

Foundation Type	Basement
-----------------	----------

Exterior Wall Construction	2x4
----------------------------	-----

Foundation Wall Height	9'
------------------------	----

Main Wall Height	10'
------------------	-----

## Plan Description

The beautiful Mediterranean style of this 1 story house plan makes this house fit in any neighborhood type. A mixture of stucco and stone on the exterior gives this plan great curb appeal. On the inside of this beautiful home, you'll find a fantastic floor plan. The kitchen includes a large kitchen island with a snack bar and a walk-in pantry. The great room lies under a 10' high tray ceiling and is warmed by a fireplace that is flanked by built-in bookshelves. The master suite lies on the opposite side of the home to give privacy from the other bedrooms and includes a bath with his/her vanities and a large walk-in closet. The master bedroom also has convenient access to the laundry room. The 2 car garage enters the home through a mudroom that includes a bench and lockers.