

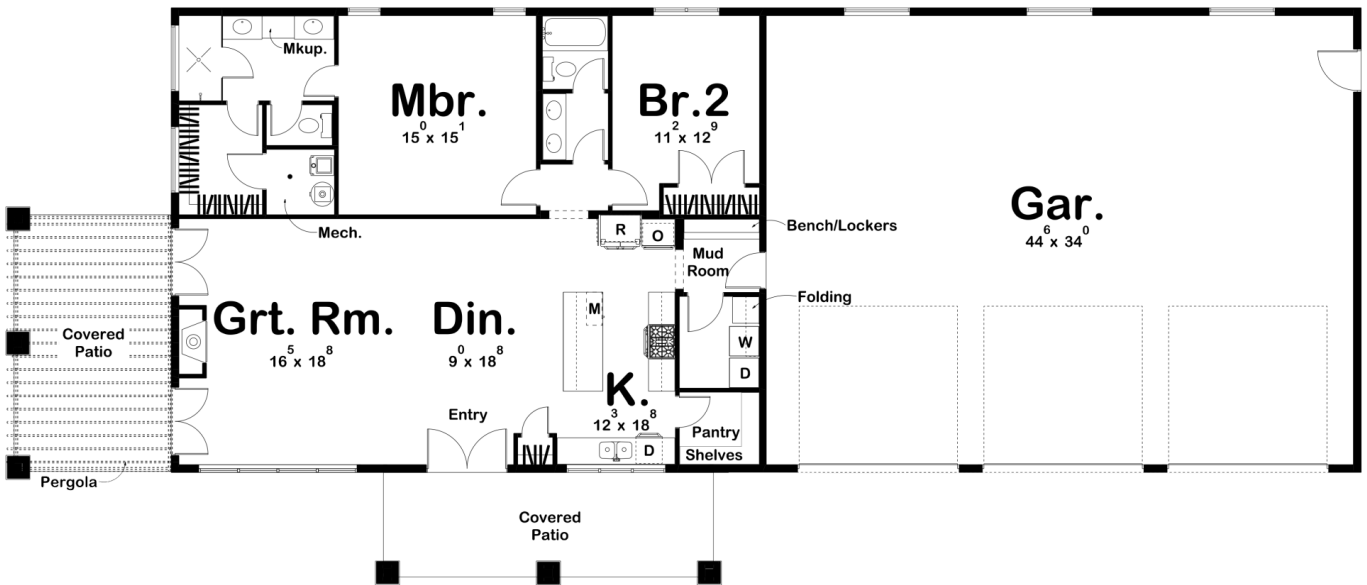

**30206 - Jonesboro Data Sheet**

1575 SQ FT	2 BEDS	2 BATHS	3 BAYS	102' 4" WIDE	43' 4" DEEP
---------------	-----------	------------	-----------	-----------------	----------------



**Construction Specs**

Layout

Bedrooms

Bathrooms	2
-----------	---

Garage Bays	3
-------------	---

### Square Footage

Main Level	1575 Sq. Ft.
------------	--------------

Covered Area	423 Sq. Ft.
--------------	-------------

Garage	1575 Sq. Ft.
--------	--------------

Total Finished Area	1575 Sq. Ft.
---------------------	--------------

### Exterior Dimensions

Width	102' 4"
-------	---------

Depth	43' 4"
-------	--------

### Default Construction Stats

*Stats are unique to the individual plan.*

Foundation Type	Slab
-----------------	------

Exterior Wall Construction	2x6
----------------------------	-----

Roof Pitches	Primary 2/12, Secondary 4/12
--------------	------------------------------

Main Wall Height	12'
------------------	-----

## Plan Description

This modern barndominium has a touch that makes the home not only feel luxurious, but also comfortable. As soon as you step in through the large three car garage, you're greeted by a beautiful mudroom and a great open space for gathering with the family. The kitchen features a walk-in pantry and a wide space with a view straight to the great room, leaving no guest unnoticed. There are two bedrooms in the Jonesboro plan, one with a shared bath, and the other with a large vanity, soaking tub, and walk-in closet. Step outside onto the covered patio and under the gorgeous pergola, perfect for adding lights to create the perfect mood for your evenings. This barndominium is unlike any other, and a perfect space for all things entertaining.