

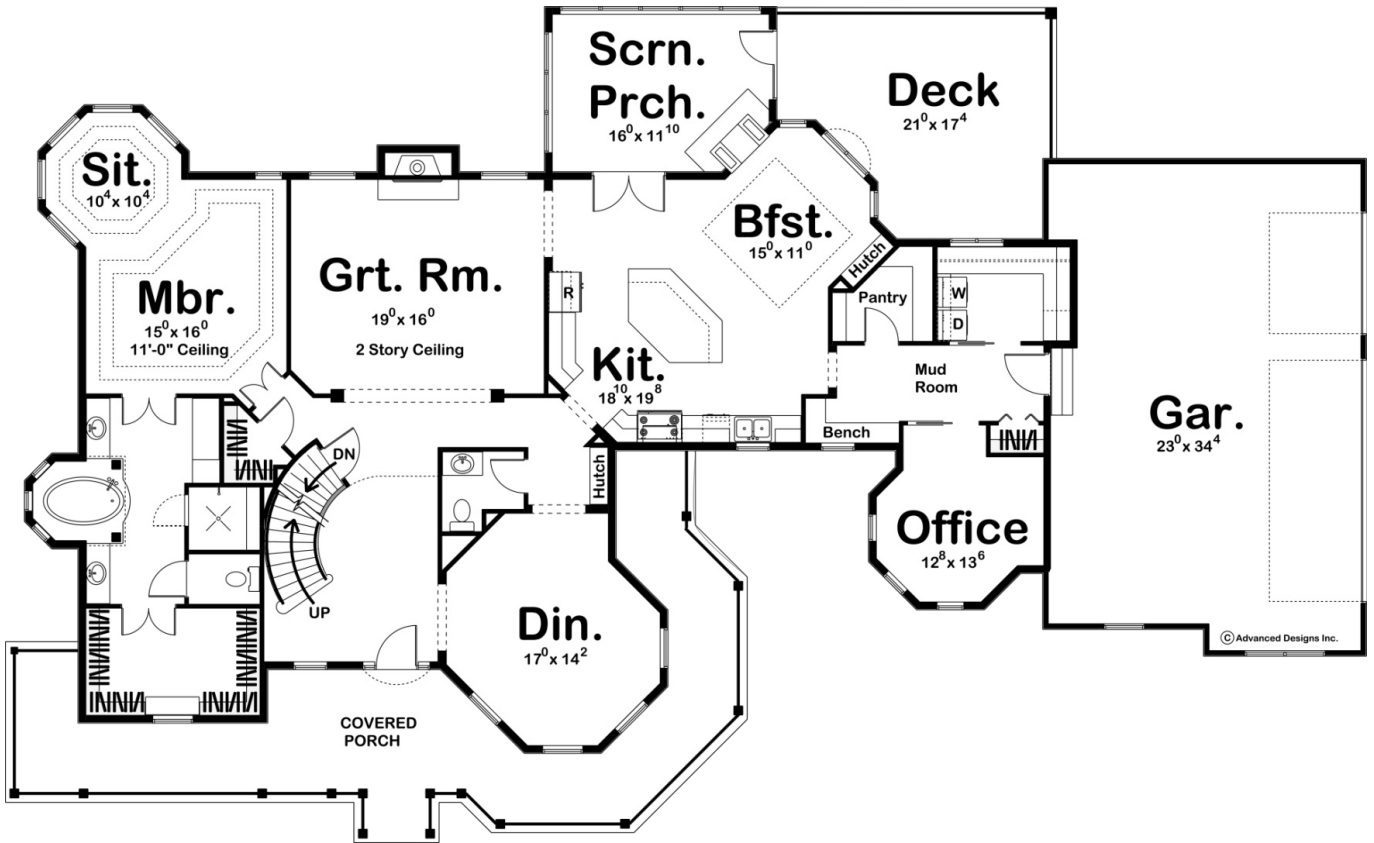

© WWW.ADVANCEDHOUSEPLANS.COM

29049 - Isabelle Data Sheet

3542 SQ FT	4 BEDS	4 BATHS	3 BAYS	100' 0" WIDE	56' 0" DEEP
---------------	-----------	------------	-----------	-----------------	----------------



© Advanced Designs Inc.

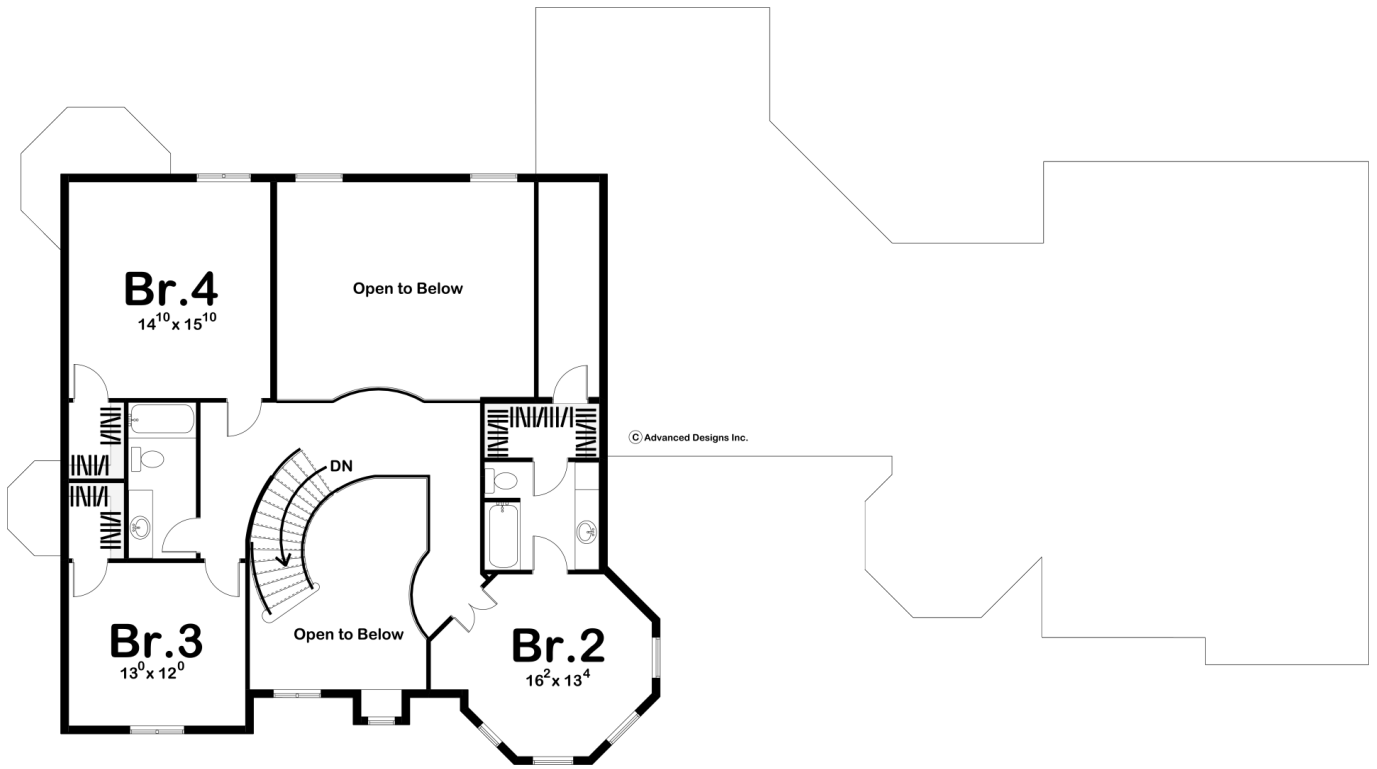

Construction Specs

Layout

Bedrooms	4
Bathrooms	4
Garage Bays	3

Square Footage

Main Level	2488 Sq. Ft.
Second Level	1054 Sq. Ft.
Garage	844 Sq. Ft.
Total Finished Area	3542 Sq. Ft.

Exterior Dimensions

Width	100' 0"
Depth	56' 0"
Ridge Height	32' 0"
<i>Calculated from main floor line</i>	

Default Construction Stats

Stats are unique to the individual plan.

Foundation Type	Basement
Exterior Wall Construction	2x4
Roof Pitches	8/1
Foundation Wall Height	9'
Main Wall Height	9'
Second Wall Height	8'

Plan Description

Charming gingerbread details adorn this classic Victorian-style, 1-1/2 story house plan. A wrapping front porch enhances this home's sense of warmth and extends a friendly invitation to all. Once inside, guests are greeted with views into both the formal bayed dining room and the great room. The great room features a fireplace, flanked by sunny windows, beneath a 2-story-high ceiling. Adjacent to the great room, the island kitchen and breakfast area are comfortably arranged for efficiency and easy entertaining. A screened porch expands dining options to the outdoors. Just off the kitchen, a utility area features a pantry, laundry room, and a mud room with a built-in bench and coat closet to intercept traffic from the 3-car garage. Also in this area is a sunny bayed office, which enjoys privacy from the main living areas of the home. On the opposite side of the home, a stunning master suite privately resides behind double doors. The bedroom includes a sunlit, bayed sitting area -- perfect for relaxing with a book. The bath area includes his-and-her vanities that flank an oval soaking tub -- set within a charming bay of windows, walk-in shower, compartmented toilet and walk-in closet with a window to the front. Upstairs, all secondary bedrooms have walk-in closets. Bedroom 2 is flooded with natural light from an array of bayed windows and enjoys its own bath. Bedrooms 3 and 4 share a central hall bath. An upper-level landing offers views to the great room and entry hall below.