

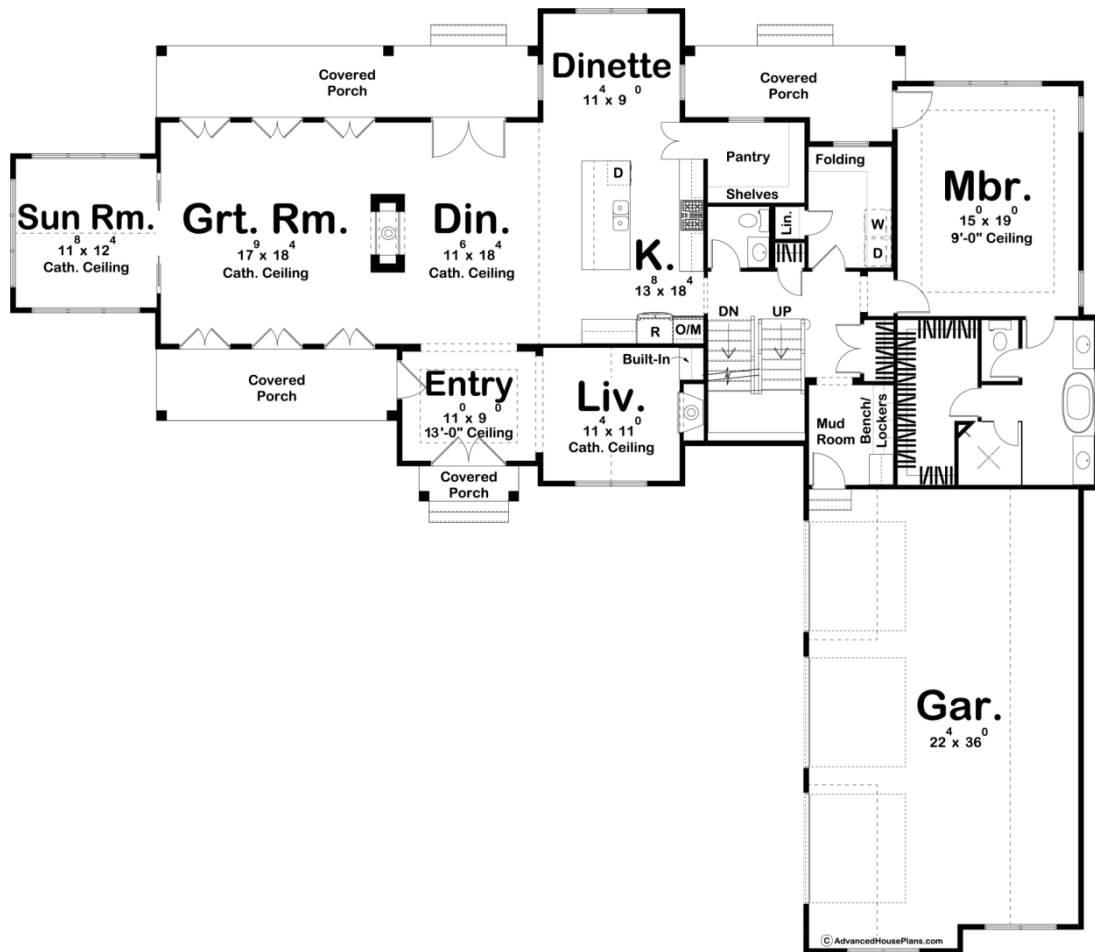

**30087 - Hudson Data Sheet**

3299 SQ FT	4 BEDS	4 BATHS	3 BAYS	90' 0" WIDE	78' 0" DEEP
---------------	-----------	------------	-----------	----------------	----------------

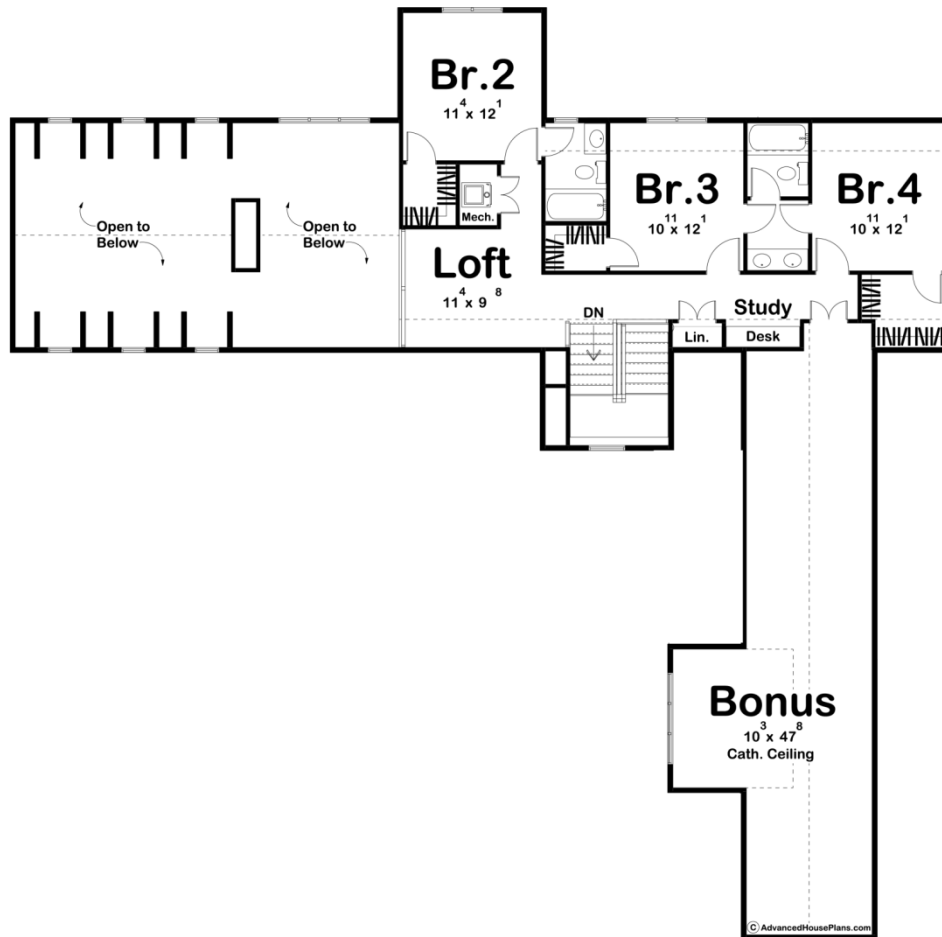



## Construction Specs

### Layout

Bedrooms	4
Bathrooms	4
Garage Bays	3

### Square Footage

Main Level	2370 Sq. Ft.
Second Level	929 Sq. Ft.
Covered Area	456 Sq. Ft.
Garage	862 Sq. Ft.
Total Finished Area	3299 Sq. Ft.

### Exterior Dimensions

Width	90' 0"
Depth	78' 0"

### Default Construction Stats

*Stats are unique to the individual plan.*

Foundation Type	Basement
Exterior Wall Construction	2x4
Roof Pitches	10/12 Primary, 4/12 Secondary
Foundation Wall Height	9'
Main Wall Height	9'
Second Wall Height	8'

## Plan Description

The Hudson plan is a magnificent 1.5 Story Modern Farmhouse style house plan. The exterior features a 3 car courtyard garage, board and batten siding and dormers. Just inside the front door, you'll find yourself in an amazing entry with a 10' ceiling. Just to the right of the entry is a formal living room with a fireplace that is a perfect place to relax. The great room lies under a soaring 2 story cathedral ceiling and shared a double-sided fireplace with the dining room. Just off the great room is a sun room. The kitchen includes a large island with a snack bar and a walk-in pantry. Tucked away on the right side of the main level is the stunning master suite. The massive master suite features a soaking tub, his/her vanities, a walk-in shower, an enclosed toilet area, and a massive walk-in closet. The second level features 3 additional bedrooms and a large bonus room above the garage. Bedrooms 3 and 4 share a bathroom, while bedroom has access to it's own bathroom. An optional bonus area adds 615 sq ft.