

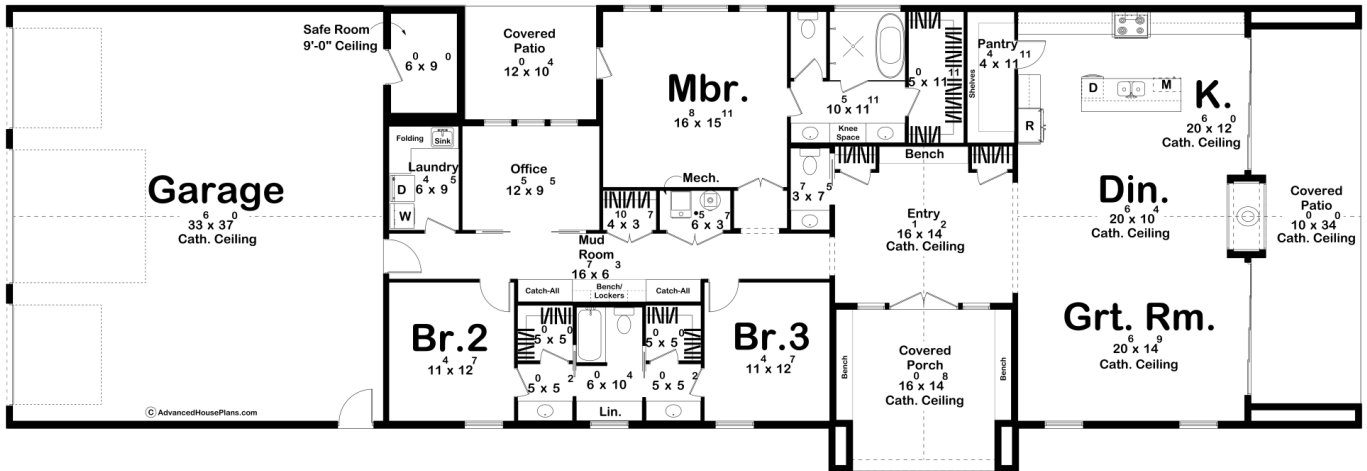

30652 - Horseshoe Bend Data Sheet

2583 SQ FT	3 BEDS	3 BATHS	3 BAYS	122' 4" WIDE	42' 0" DEEP
---------------	-----------	------------	-----------	-----------------	----------------



Construction Specs

Layout

Bedrooms

Bathrooms	3
-----------	---

Garage Bays	3
-------------	---

Square Footage

Main Level	2583 Sq. Ft.
------------	--------------

Covered Area	689 Sq. Ft.
--------------	-------------

Garage	1292 Sq. Ft.
--------	--------------

Total Finished Area	2583 Sq. Ft.
---------------------	--------------

Exterior Dimensions

Width	122' 4"
-------	---------

Depth	42' 0"
-------	--------

Default Construction Stats

Stats are unique to the individual plan.

Foundation Type	Slab
-----------------	------

Exterior Wall Construction	2x6
----------------------------	-----

Roof Pitches	Primary 6/12, Secondary 8/12
--------------	------------------------------

Main Wall Height	12'
------------------	-----

Plan Description

Welcome to Horseshoe Bend, a 3-bedroom, 3-bath modern barndominium that offers both style and comfort. The inviting entry features a covered porch with benches on either side and a striking cathedral ceiling. Inside, the main living space has a grand cathedral ceiling and a dual-sided fireplace that extends to a spacious covered patio, perfect for gatherings. The master suite is a true sanctuary, offering a private covered patio for quiet moments. Inside the master bath, you'll find a luxurious shower with a freestanding tub nestled within, creating a spa-like experience. The double vanity provides ample space, and the expansive walk-in closet offers plenty of room for all your wardrobe needs. With large windows in the office for natural light, a dedicated laundry room complete with folding space, and a safe room in the 3-car garage, Horseshoe Bend blends modern design with thoughtful, functional features for everyday living.