

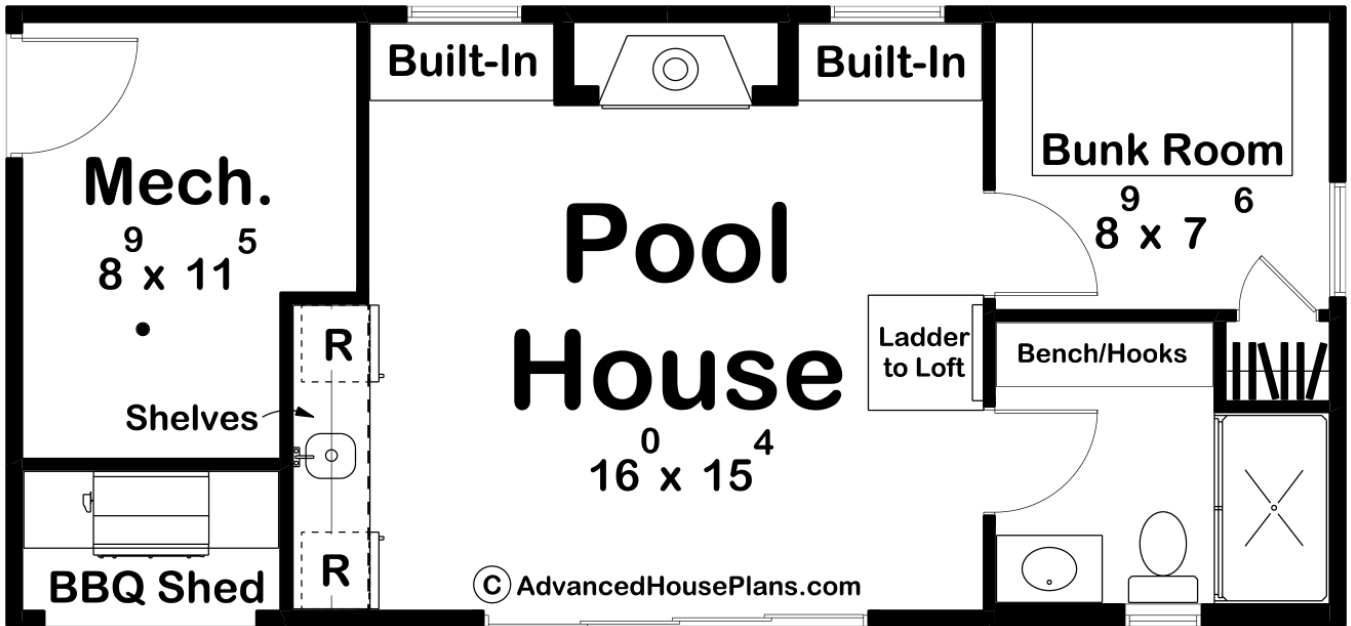

**30242 - Holly Grove Data Sheet**

685 SQ FT	0 BEDS	1 BATHS	0 BAYS	34' 8" WIDE	16' 0" DEEP
--------------	-----------	------------	-----------	----------------	----------------

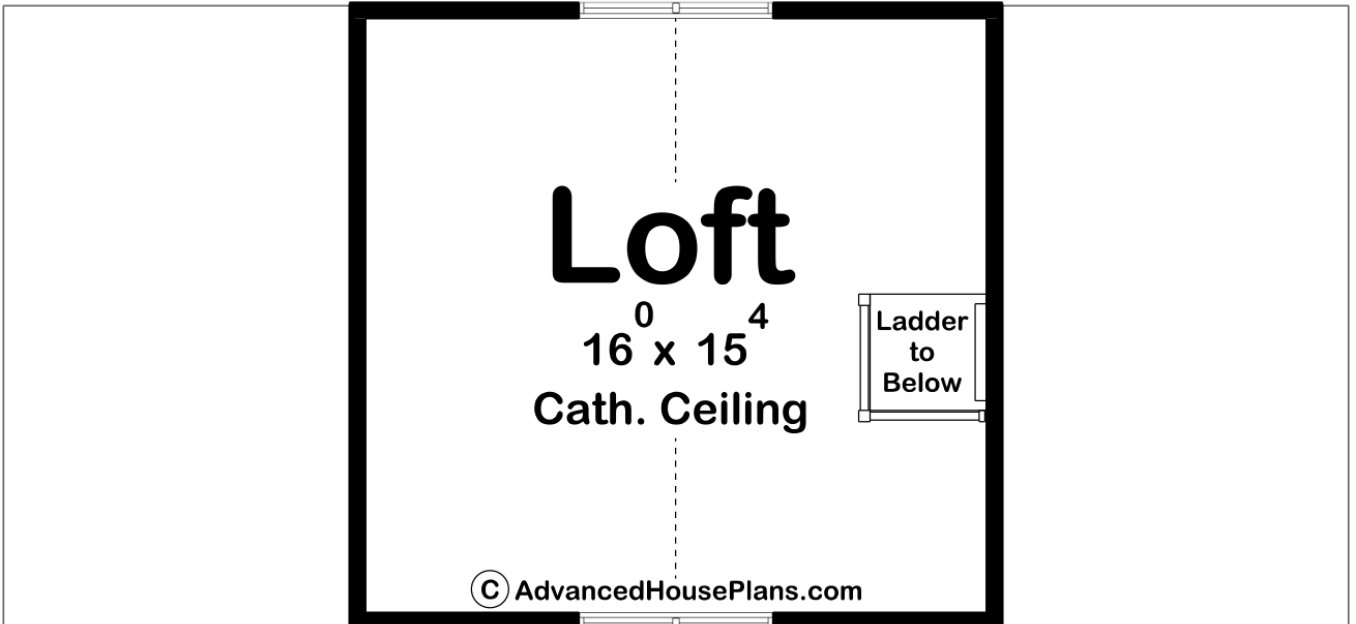



## Construction Specs

### Layout

Bathrooms 1

### Square Footage

Main Level 427 Sq. Ft.

Second Level 258 Sq. Ft.

Total Finished Area 685 Sq. Ft.

### Exterior Dimensions

Width 34' 8"

Depth 16' 0"

Ridge Height 22' 2"  
*Calculated from main floor line*

### Default Construction Stats

*Stats are unique to the individual plan.*

Foundation Type Slab

Exterior Wall Construction 2x4

Roof Pitches

Primary 10/12, Secondary 3/12

Main Wall Height

8'

Second Wall Height

5'

## Plan Description

The modern farmhouse pool house is a stunning and functional addition to any backyard oasis. The pool house features a spacious and inviting living area with a cozy fireplace, perfect for relaxing with friends and family after a long day of swimming and playing in the pool. A wet bar with a sink, mini-fridge, and ample storage space is also included, making it easy to enjoy refreshing beverages and snacks without having to leave the pool area. The pool house also includes a full bathroom, complete with a shower, toilet, and sink, providing a convenient place to rinse off and freshen up after swimming. For added convenience, there is also a bunk room, featuring comfortable and stylish bunk beds, providing a fun and functional sleeping area for kids or guests. The loft above the living area is perfect for playing games, reading, or just hanging out. This versatile space can be used for a variety of purposes, depending on your needs and preferences. In addition to the main pool house, there is also a bbq shed that can be accessed from the exterior, providing a convenient and covered area for grilling and preparing meals. With ample seating and plenty of space to relax and unwind, the modern farmhouse pool house is the perfect place to enjoy the great outdoors and make lasting memories with family and friends.