

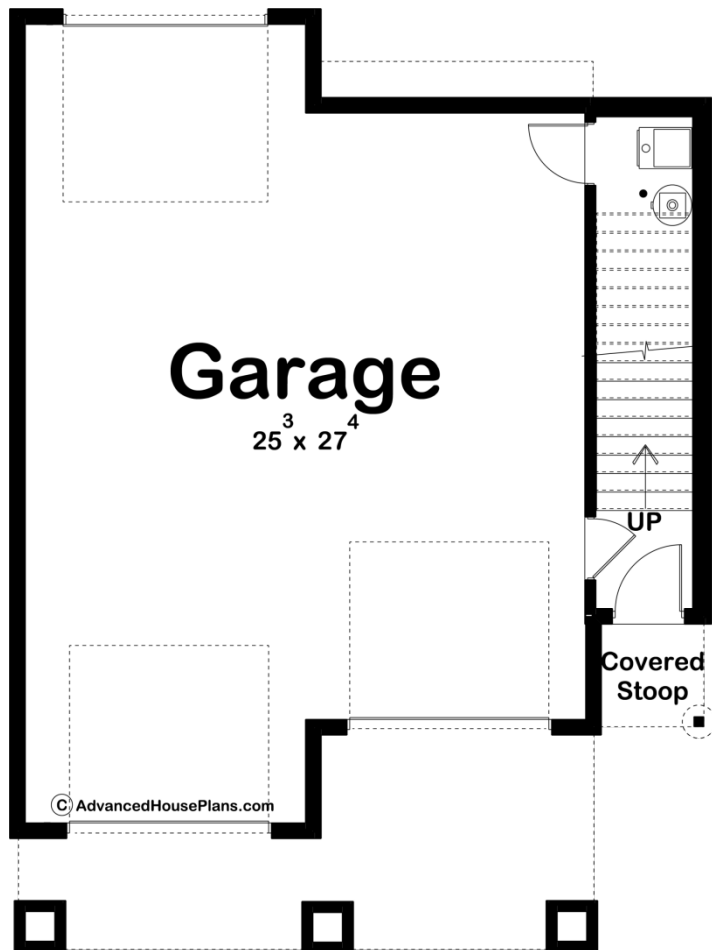

## 29822 - Holling Heights Data Sheet

984 SQ FT	2 BEDS	2 BATHS	2 BAYS	31' 0" WIDE	42' 0" DEEP
--------------	-----------	------------	-----------	----------------	----------------

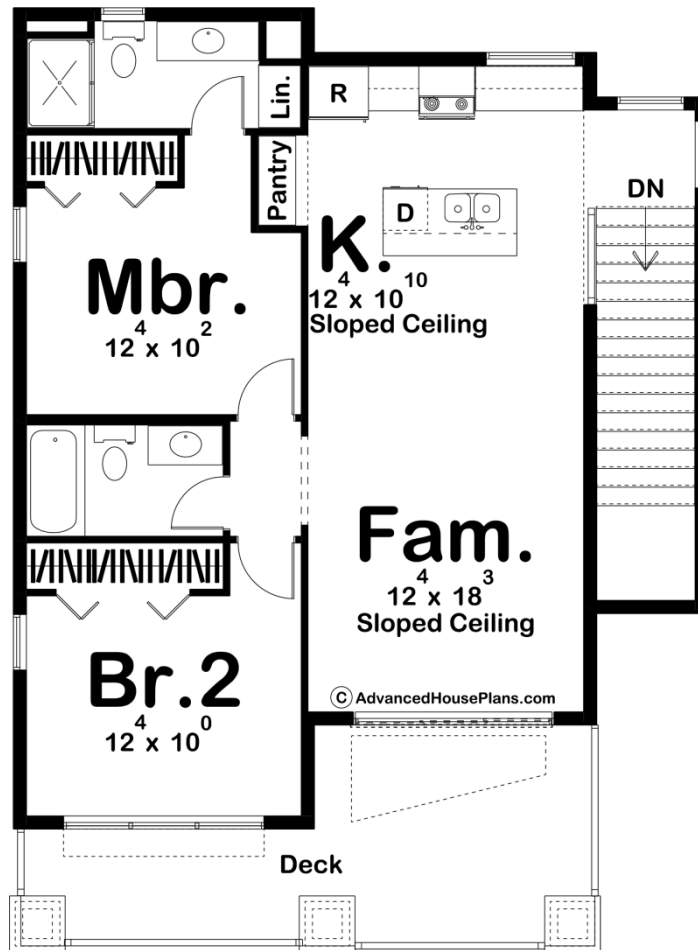



## Construction Specs

### Layout

Bedrooms	2
Bathrooms	2
Garage Bays	2

### Square Footage

Second Level	984 Sq. Ft.
Garage	835 Sq. Ft.
Total Finished Area	984 Sq. Ft.

### Exterior Dimensions

Width	31' 0"
Depth	42' 0"

### Default Construction Stats

*Stats are unique to the individual plan.*

Foundation Type	Slab
Exterior Wall Construction	2x4

Roof Pitches	4/12 Primary, 6/12 Secondary
Main Wall Height	9'
Second Wall Height	9'

## Plan Description

The Holling Heights carriage house is a modern mountain masterpiece! The exterior showcases an excellent mixture of textures including stone, brick, wood, and metal. The lower level features an oversized 2 car garage with 1 drive-through bay. On the upper level, you'll find a wonderful 2 bedroom apartment. The family room lies under a sloped ceiling making the space feel large. The kitchen includes an island with a snack bar and a pantry. The master bedroom has access to its own bathroom and bedroom 2 shares a bathroom with the main living space.