

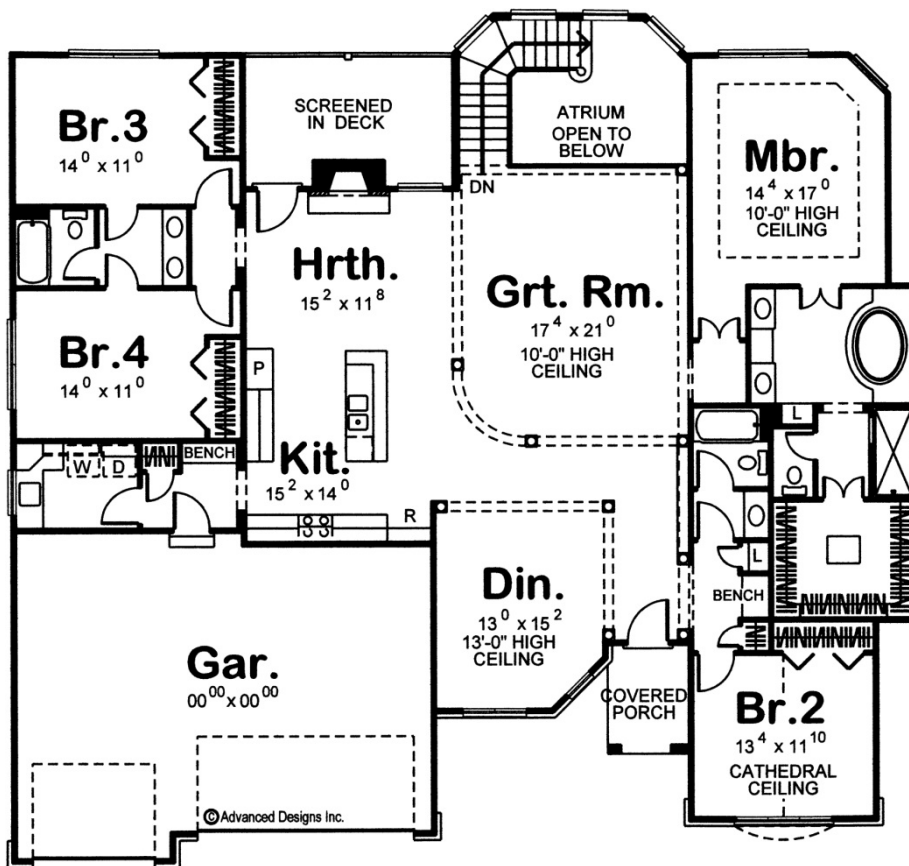

29163 - Hoffman Data Sheet

2788 SQ FT	4 BEDS	3 BATHS	3 BAYS	67' 0" WIDE	63' 0" DEEP
---------------	-----------	------------	-----------	----------------	----------------



Construction Specs

Layout

Bedrooms

Bathrooms	3
-----------	---

Garage Bays	3
-------------	---

Square Footage

Main Level	2788 Sq. Ft.
------------	--------------

Garage	705 Sq. Ft.
--------	-------------

Total Finished Area	2788 Sq. Ft.
---------------------	--------------

Exterior Dimensions

Width	67' 0"
-------	--------

Depth	63' 0"
-------	--------

Ridge Height	26' 0"
--------------	--------

Calculated from main floor line

Default Construction Stats

Stats are unique to the individual plan.

Foundation Type	Basement
-----------------	----------

Exterior Wall Construction	2x4
----------------------------	-----

Roof Pitches	8/12 Primary, 12/12 Secondary
--------------	-------------------------------

Foundation Wall Height	9'
------------------------	----

Main Wall Height	9'
------------------	----

Plan Description

Beautifully crafted design details lend an air of European elegance to this 4-bedroom, 1-story house plan. Upon entering the home, guests are greeted by an open living space that exudes sophistication and style. The boundaries of the formal dining room (with 13-foot-high ceiling) and the great room (with 10-foot-high ceiling), are defined by ceiling heights and tasteful columns. A hearth room extends this open space and accesses a rear screened-in deck. Just off the great room, a stairway leads to an open atrium area on the lower level. The kitchen interacts seamlessly with the main living areas and includes an island workspace. Just off the kitchen, a mud room with coat closet and bench accesses both the 3-car garage and the laundry room with counter space and soaking sink. Double doors, secluded within an alcove, reveal a master suite that abounds with luxurious amenities. The bath area features his and her vanities, oval soaking tub, walk-in shower, compartmented toilet and walk-in closet with built-in dresser.

Bedroom 2 resides nearby, but with appropriate separation from the master suite. This bedroom enjoys a high cathedral ceiling and is just steps away from a hall bath. Bedrooms 3 and 4 are located on the opposite side of the home and share a Jack-n-Jill bath.