

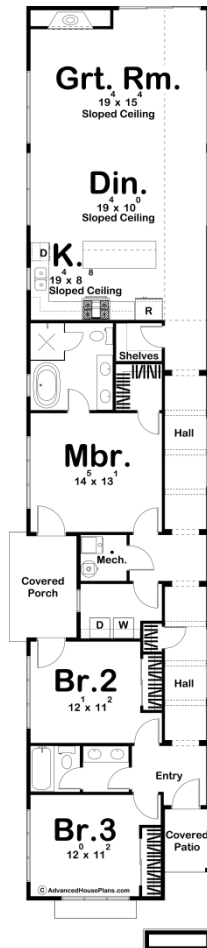

29837 - Highland Park Data Sheet

1822 SQ FT	3 BEDS	2 BATHS	0 BAYS	20' 0" WIDE	98' 0" DEEP
---------------	-----------	------------	-----------	----------------	----------------



Construction Specs

Layout

Bedrooms

Square Footage

Main Level	1822 Sq. Ft.
Total Finished Area	1822 Sq. Ft.

Exterior Dimensions

Width	20' 0"
Depth	98' 0"

Default Construction Stats

Stats are unique to the individual plan.

Foundation Type	Slab
Exterior Wall Construction	2x4
Roof Pitches	4/12 Primary
Main Wall Height	9'

Plan Description

If you've been challenged with the task of building on a narrow strip of property, Highland Park is perfect for you. Whether you are building on an infill lot or trying to replace an older house in an urban environment, this plan accommodates even the narrowest of lots. The Highland Park comes in at an efficient 20' wide. Even though the house is narrow, it doesn't sacrifice any amenities. Inside the home, the great room, dining room, and kitchen flow perfectly in an open layout. The kitchen includes an island and a walk-in pantry. The great room is warmed by a fireplace and allows plenty of natural light through its windows. The master bedroom includes his/her vanities and a soaking tub. Bedrooms 2 and 3 share a centrally located bathroom.